

MAP (OF THE) CITY OF ASHLAND

SITUATED IN

SECS. 4, 5, 8, 9, 16 AND 17, T. 39, S. R. 1 E., W. M.

JACKSON COUNTY,
OREGON.

SCALE 2 INCH = 400 FEET.

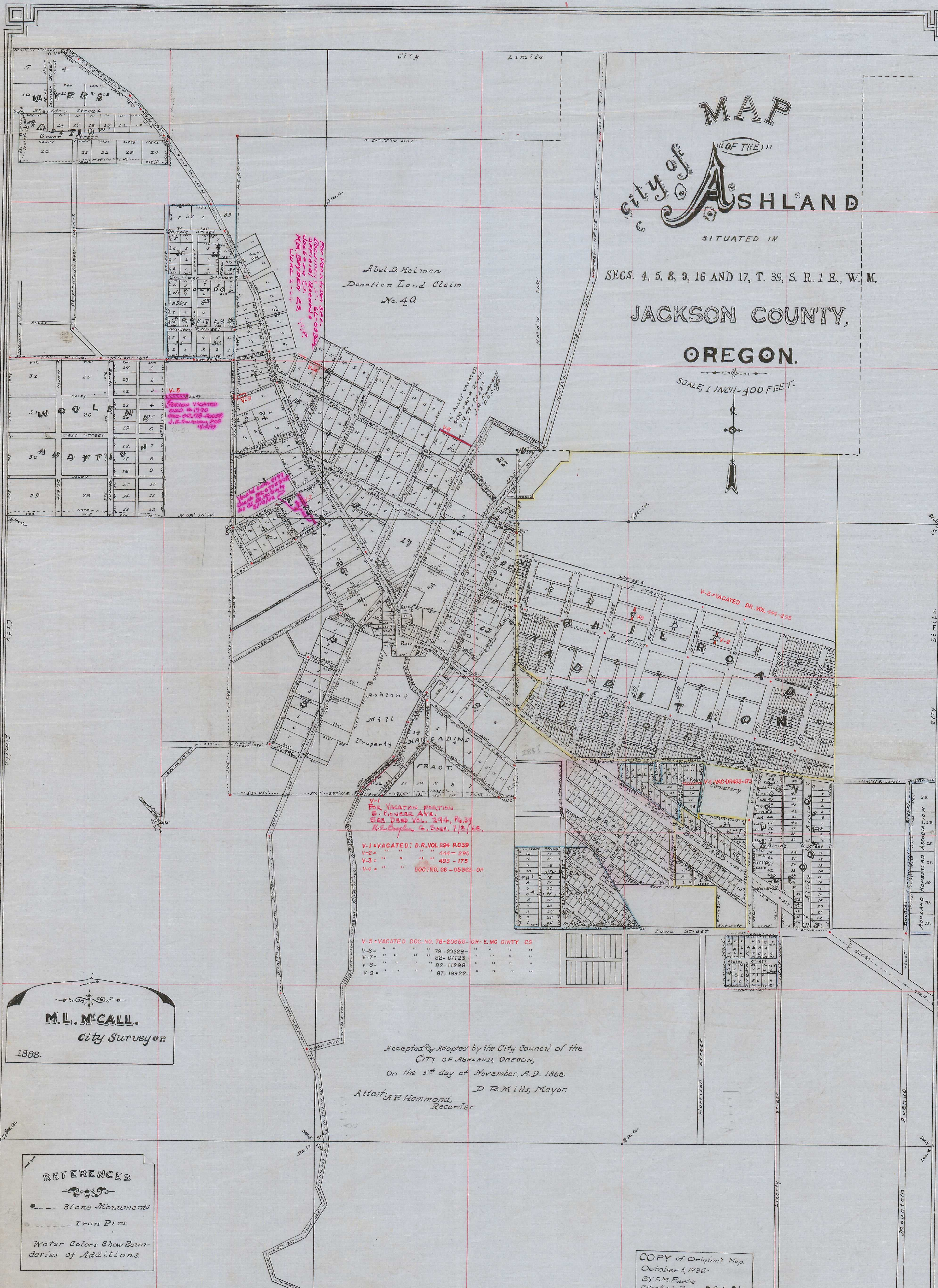

Abel D. Helman
Donation Land Claim
No. 40

FOR VACATION PORTION
E. HENDERSON AVE.
SEE DEED VOL. 294, PAGE
162-163, G. S. 181, 182.

V-1 VACATED: D.R. VOL 294 P. 163
V-2 " " " " 444-285
V-3 " " " " 483-173
V-4 " " " " DOC. NO. 66-05362-09

V-5 VACATED DOC. NO. 78-20656 OR E.M.C GINTY CS
V-6 " " " " 79-20229 " " " "
V-7 " " " " 82-07723 " " " "
V-8 " " " " 82-11298 " " " "
V-9 " " " " 87-19922 " " " "

M. L. McCall.
City Surveyor
1888.

Accepted & Adopted by the City Council of the
CITY OF ASHLAND, OREGON,
On the 5th day of November, A.D. 1888.
Attest: A. P. Hammond,
Recorder
D. R. Mills, Mayor

REFERENCES

- Stone Monuments
- Iron Pins

Water Colors Show Boundaries of Additions.

COPY of Original Map.
October 5, 1936.
By F.M. Peatfield
Checked By P.B. 1-01

State of Oregon, Jackson County-- ss. I hereby Certify, That the Above Map of the City of Ashland, Oregon, was filed for Record on the 26th day of March A.D. 1892, at 11 o'clock A.M., and was duly Recorded here on the reduced scale of 40 feet to the Inch, by order of the City Council of said City of Ashland, the original being drawn on a scale of 200 feet to the Inch.
W. M. Holmes, County Recorder.

For Affidavit of G.H. Billings see Vol. Q, Page 443 Misc. Records.

E. Miller & Sons, Course No. 1815-54E