

# HUMPHREY-ANDREWS ADDITION

MEDFORD OREGON.

1910.

Scale 1"=30'

O. Ornspiger C.E.

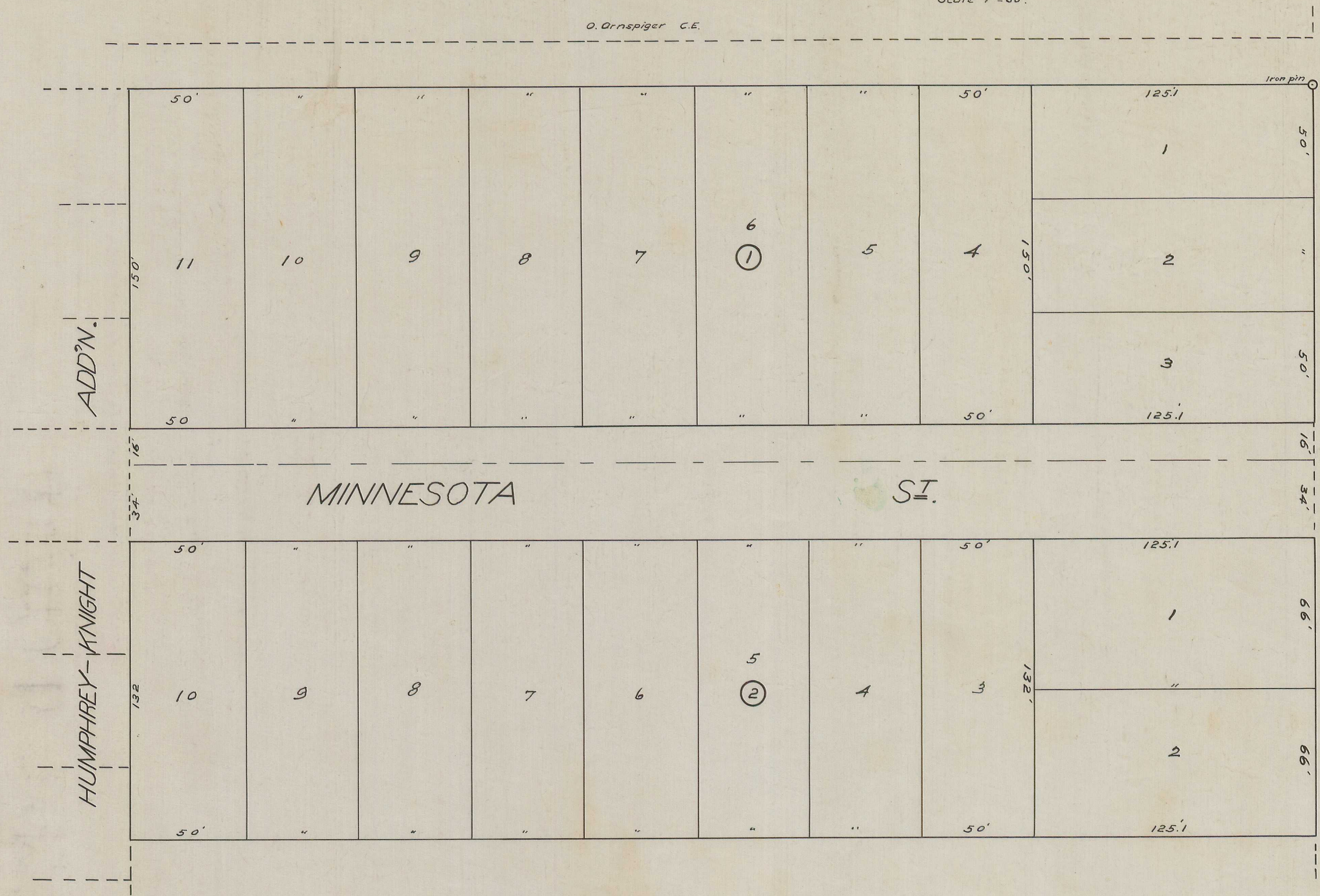

**Description.**  
Commencing at the southeast corner of Fruitdale Addition which is 690 feet North and 30 feet West of the south east corner D.C. 42, Township 37 South, Range 1 West, 11th and running thence, South on West line of Roosevelt Ave. 232 feet, thence West 525.1 feet; thence North 322 feet; thence East 525.1 feet to place of beginning.

**Dedication.**  
Know all men by these presents that we W.H. Humphrey and L. Emma Humphrey husband and wife and E.M. Andrews and Caddie L. Andrews husband and wife, are the owners in fee simple of the above described tract, and that we have laid out the same into lots, blocks and street as shown by the map hereon, and that said map is a correct representation of said subdivision and that we do hereby dedicate to the public for public use the street shown hereon, and that we do hereby designate said plat as the Humphrey-Andrews Addition to the City of Medford, Oregon; and that we W.H. Humphrey and L. Emma Humphrey own all of said block 1, and that we E.M. Andrews and Caddie L. Andrews own all of block 2.

Done in presence of  
W.H. Humphrey  
L. Emma Humphrey

W.H. Humphrey seal  
L. Emma Humphrey seal  
E.M. Andrews seal  
Caddie L. Andrews seal

State of Oregon } ss.  
 County of Jackson }  
 Personally appeared before me a Notary Public in and for said County and State W.H. Humphrey and L. Emma Humphrey and E.M. Andrews and Caddie L. Andrews to me personally known to be the above named who executed the above instrument and who severally acknowledged to me that they executed the same freely and voluntarily for the purposes therein mentioned.  
 Done this 11 day of November, 1910.

S.A. Nye  
 Notary Public for Oregon.

State of Oregon } ss.  
 County of Jackson }  
 I, Olen Ornspiger, being first duly sworn do hereby certify that I surveyed the above described tract and marked same with proper monument and stakes, and that the map hereon is a correct representation of the survey as made by me on the ground on the 31st day of October, 1910.

Subscribed and sworn to this 9th day of November, 1910.

Examined and approved this 18th day of November, 1910.

For order County Commissioners approving this plat see Vol. 14, page 13, Commissioners Journal of Proceedings.

Examined and approved this 18 day of November, 1910.

Examined and approved by the Council of Medford, Oregon this 18th day of November, 1910, and recorded in Vol. 7, page 12, by

Filed for record this 27 day of November, 1910, at 4 o'clock, and recorded in Vol. 3 of Plats, page 11, Records of Jackson County, Oregon.

Filed Dec 7, 1910  
 W.R. Coleman, Clerk  
 By M.B. Loune Wpy

Olen Ornspiger  
 Notary Public for Oregon.  
John G. Taylor  
 City Engineer.  
W.R. Coleman  
 County Clerk.  
W.T. Griever  
 County Assessor.  
John H. Taylor  
 City Recorder.  
R.T. Burnett  
 County Recorder.

61

1

61