

CERTIFIED RECORD OF LAND CORNER MONUMENTATION

History of original corner establishment:

THE WEST ONE-QUARTER (1/4) CORNER OF SECTION 6, TOWNSHIP 32 SOUTH, RANGE 3 EAST, WILLAMETTE MERIDIAN, WAS RE-ESTABLISHED IN 1962 BY B.L.M.. THEY SET A BRASS CAPPED MONUMENT FROM WHICH:

- A 17 INCH FIR SNAG BEARS N 77° W 41 LINKS
- A 6 INCH CEDAR BEARS N 25° E 73 LINKS
- A 6 INCH FIR BEARS S 85° E 44 LINKS

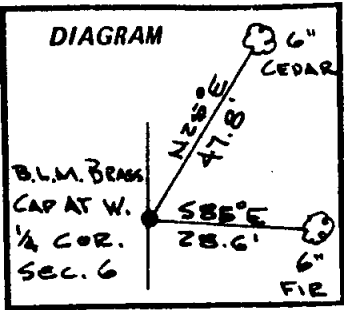

Description of corner evidence found:

FOUND MONUMENT LAYING ON TOP OF GROUND. IT WAS REMOVED BY LOGGING EQUIPMENT DURING RECENT WORK IN THE AREA OF SAID ONE-QUARTER (1/4) CORNER.

Description of monument and accessories I established to perpetuate the original location of this corner:

SINCE THE ORIGINAL B.L.M. MONUMENT WAS IN GOOD CONDITION, IT WAS RESET. THE FIR SNAG WHICH WAS N 77° W 41 LINKS IS NOW LAYING ON THE GROUND. THEREFORE THE CORNER WAS RELOCATED FROM THE 6 INCH CEDAR WHICH BEARS N 25° E 47.8 FEET AND THE 6 INCH FIR WHICH BEARS S 85° E 28.6 FEET FROM SAID CORNER LOCATION. THE DISTANCES USED ARE FROM SURVEY NO. 8652.

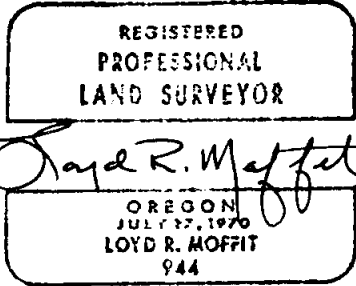
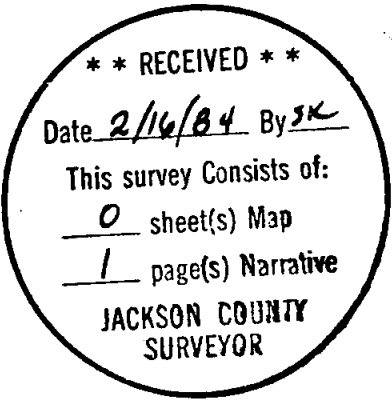

Office of..... County of.....  
State of....., I hereby certify that the within instrument was filed in this office  
for record on the..... day of....., 19.....  
..... by.....  
(COUNTY OFFICIAL) DEPUTY.

History of original corner establishment.

THE WEST ONE-QUARTER (1/4) CORNER OF SECTION 6, TOWNSHIP 32 SOUTH, RANGE 3 EAST, WILLAMETTE MERIDIAN, WAS RE-ESTABLISHED IN 1962 BY B.L.M.. THEY SET A BRASS CAPPED MONUMENT FROM WHICH:

- A 17 INCH FIR SNAG BEARS N 77° W 41 LINKS
- A 6 INCH CEDAR BEARS N 25° E 73 LINKS
- A 6 INCH FIR BEARS S 85° E 44 LINKS

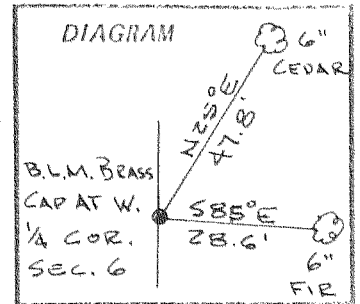

Description of corner evidence found:

FOUND MONUMENT LAYING ON TOP OF GROUND. IT WAS REMOVED BY LOGGING EQUIPMENT DURING RECENT WORK IN THE AREA OF SAID ONE-QUARTER (1/4) CORNER.

Description of monument and accessories I established to perpetuate the original location of this corner:

SINCE THE ORIGINAL B.L.M. MONUMENT WAS IN GOOD CONDITION, IT WAS RESET. THE FIR SNAG WHICH WAS N 77° W 41 LINKS IS NOW LAYING ON THE GROUND. THEREFORE THE CORNER WAS RELOCATED FROM THE 6 INCH CEDAR WHICH BEARS N 25° E 47.8 FEET AND THE 6 INCH FIR WHICH BEARS S 85° E 28.6 FEET FROM SAID CORNER LOCATION. THE DISTANCES USED ARE FROM SURVEY NO. 8652.

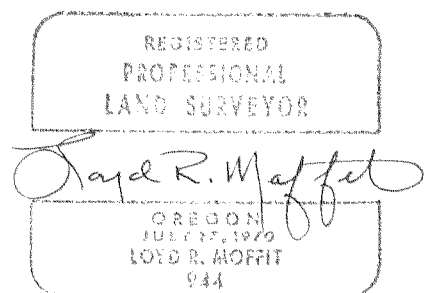
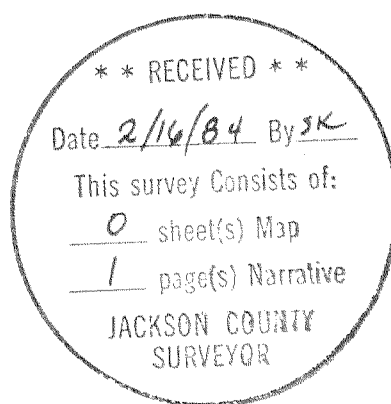

Office of \_\_\_\_\_ County of \_\_\_\_\_  
 State of \_\_\_\_\_, I hereby certify that the within instrument was filed in this office  
 for record on the \_\_\_\_\_ day of \_\_\_\_\_, 19\_\_\_\_.  
 \_\_\_\_\_ by \_\_\_\_\_ DEPUTY.