

MINOR LAND PARTITION

A PORTION OF THE SOUTH ONE-HALF OF
THE NORTHEAST ONE-QUARTER OF SEC.
19, T.37S., R.1W., W.M., CITY OF MEDFORD,
JACKSON COUNTY, OREGON

OWNER:
THOMAS M. RIGHTER
1183 WABASH AVE.
MEDFORD, OREGON

SURVEYOR'S CERTIFICATE:
I, LOYD R. MOFFIT, A REGISTERED LAND SURVEYOR IN THE
STATE OF OREGON, HEREBY CERTIFY THAT THIS MAP CORRECTLY
REPRESENTS A SURVEY MADE BY ME AND COMPLIES WITH THE
REGULATION FOR MINOR LAND PARTITIONS.

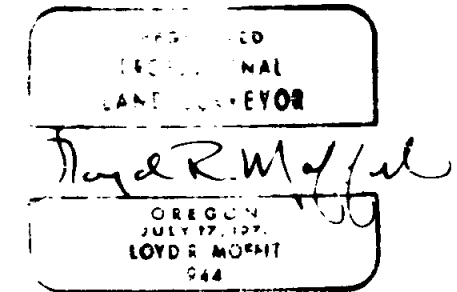

APPROVALS:
I CERTIFY THAT PURSUANT TO THE AUTHORITY GRANTED IN
ORDINANCE NO. 4041, THE ATTACHED PLAT IS HEREBY APPROVED.

BY James M. Eichenlaub 1/4/84
CITY OF MEDFORD PLANNING DIRECTOR DATE

APPROVED THIS 4th DAY OF January, 1984.

BY Ray Stewart Dore Linder
DIRECTOR OF ASSESSMENT & TAXATION DEPUTY
1-9-84

RECORDER'S CERTIFICATE:
FILED FOR RECORD THIS 10 DAY OF January, 1984.
AT 1:11 O'CLOCK P.M. AND RECORDED IN VOLUME
5 AT PAGE 155 OF MINOR LAND PARTITIONS IN JACKSON
COUNTY, OREGON.

Kathleen S. Beckett by Martha Baker

EXAMINED AND APPROVED BY THE MEDFORD IRRIGATION DISTRICT
IN REGULAR SESSION THIS 3rd DAY OF January, 1984.

James M. Eichenlaub Dore Linder
PRESIDENT SECRETARY

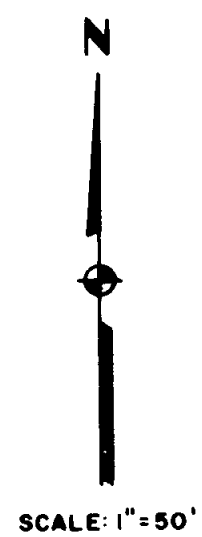
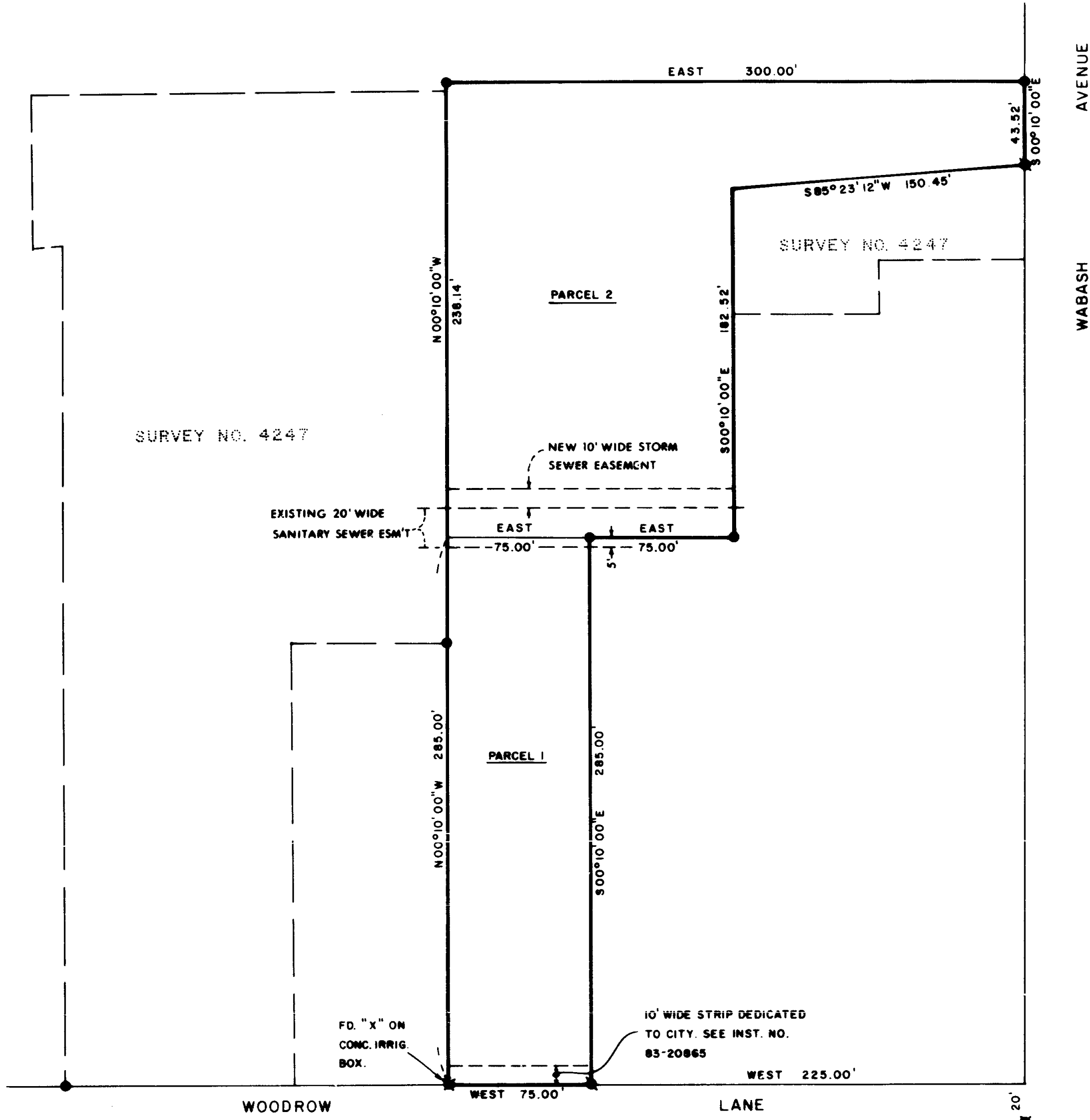

RECEIVED
Date: 1/10/84 By: SK
Consists of:
1 map
1 descriptive
1 plat
1 plat
1 plat

LEGEND:
●= FOUND 5/8" PINS AS PER SURVEY NO. 4247.
■= FOUND 5/8" IRON PIN.
■= FOUND MONUMENT AS SHOWN.
BASIS OF BEARINGS:
SURVEY NO. 4247

PREPARED BY:
FRIAR-MOFFIT AND ASSOCIATES
717 WEST 10TH STREET
MEDFORD, OREGON
DATE:
DECEMBER, 1983.

FD. 1/2" PIN 0.07'
W. OF SEC. LINE
FD. 1" PIPE MARKING THE
1/4 SECTION CORNER

SURVEY NO. 9838

SURVEY NARRATIVE TO COMPLY WITH O.R.S. 209.250

SURVEY FOR: THOMAS RIGHTER
634 CRATER LAKE AVE.
MEDFORD, OR. 97504

LOCATION: A PORTION OF THE SOUTH ONE-HALF
(1/2) OF THE NORTHEAST ONE-QUARTER
(1/4) OF SECTION 19, TOWNSHIP 37
SOUTH, RANGE 1 WEST, WILLAMETTE
MERIDIAN, JACKSON COUNTY, OREGON.

PURPOSE: TO DIVIDE AN EXISTING TAX LOT INTO
TWO PARCELS.

PROCEDURE: USING CORNERS AND DATA ESTABLISHED
DURING MY PREVIOUS SURVEY NO. 7247,
I PREPARED THE ATTACHED MINOR PARTITION
MAP.

DATE: JANUARY, 1984

JOB #83-141

FRIAR-MOFFIT & ASSOCIATES

