

MAP OF SURVEY

LOCATED IN THE SOUTHEAST QUARTER OF SECTION 36, TOWNSHIP 40 SOUTH, RANGE 1 EAST, AND THE NORTHEAST QUARTER OF SECTION 31, TOWNSHIP 41 SOUTH, RANGE 1 EAST, WILLAMETTE MERIDIAN, JACKSON COUNTY, OREGON.

for
TOM DENNEY

- BASIS OF BEARINGS:** SOLAR OBSERVATION
- FOUND:** ● STANDARD BLM PIPE AND BRASS CAP, AS PER RECORD
○ JACKSON COUNTY 1" G.I. PIPE AND 2 1/2" BRASS CAP, AS PER RECORD
- SET:** ● 1" X 30" G.I.P. AND 2 3/8" BRASS CAP EXPOSED IS
○ 3/8" X 30" I.P.M. WITH YELLOW PLASTIC CAP AND WEAVER LS 1679
- SCALE:** 1" = 300'
- DATE:** JULY 15, 1983
- SURVEYED BY:** FLATERO, WEAVER AND ASSO.C., INC.
P.O. BOX 900
JACKSONVILLE, OREGON 97530

ACCESORIES:
● OAK 12" DIA., BRS. S10°52'E 27.41'.
● 5/8" X 30" I.P.M. W/ CAP BRS.
● N78°40'W 9.5511.

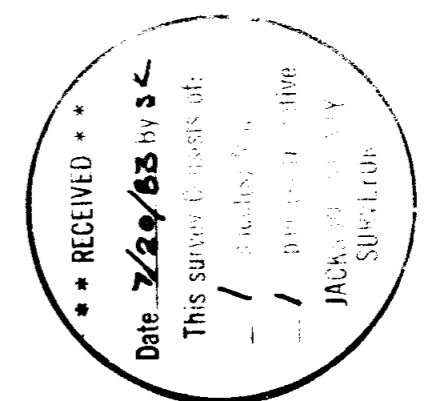
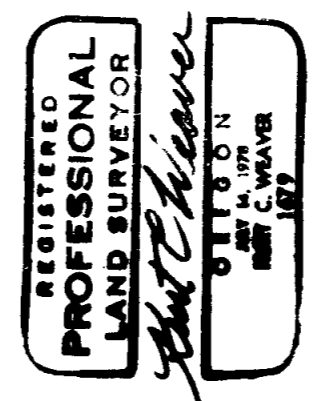

Survey No. 9674

SURVEY NARRATIVE TO COMPLY WITH O.R.S. 209.250.

Survey for: Mr. Tom Denney
P.O. Box 1196
Ashland, Oregon 97520

Location: Located in the southeast quarter of Section 36, Township 40 South, Range 1 East and in the northeast quarter of Section 1, Township 41 South, Range 1 East of the Willamette Meridian, Jackson County, Oregon.

Purpose: To monument the center quarter corner of said Section 1, the east 1/16 corner common to said Sections 1 and 36, as well as the monument shown which marks the east end of the north line of the south 100 feet of the northwest quarter of the southeast quarter of said Section 36.

Procedure: All controlling corners were incorporated in a series of closed traverses. The positions of the lost corner and the subdivisional lines was computed with the results displayed on the accompanying map. The quarter corner common to Sections 36 and 1 was not found and subsequently monumented at its proportionate position. This particular corner was shown to be an angle point in the Section line by Rufus Moore in 1895. The proportion position was determined as prescribed in section 5-36 of the BLM Manual of Surveying Instructions. The east quarter corner of Section 36 was not set on the retracement survey, consequently its position was calculated for the subdivision of Section 36.

Bearing was based on a Solar Observation.

Surveyed by: Flatebo, Weaver & Assoc., Inc.
P.O. Box 900
Jacksonville, Oregon 97530

Date: July 13, 1983

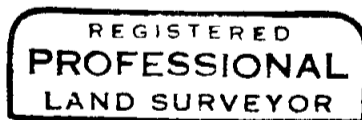

Rurt C. Weaver

