

SURVEY NARRATIVE TO COMPLY WITH O.R.S. 209.250

FOR: Clifford W. Chaney
1601 Nevada Street
Ashland, Oregon

BY: Boyden Surveyors
108 Mistletoe Street
Medford, Oregon

PURPOSE: To monument and describe two parcels and a private road located in the Southwest Quarter of Section 35, T38SR1E, W.M. For approval of this partition see the Jackson County Department of Planning and Development File No. 81-19-MJP.

PROCEDURE: From Sectional control monuments set on Filed Surveys 5301, 5441, 7035 and from the County Surveyor monumented position for the 1/4 corner common to Sections 26 and 35 along with Pompadour Drive right-of-way controls set on Filed Survey No. 4199, the desired parcel boundaries were monumented as shown on the annexed map. An existing roadway was monumented and designated "Private Road".

It should be noted that the East boundary of the West-half of the SW 1/4 of Section 35 as monumented on Filed Survey No. 2067 falls Westerly from the controlling monuments set for this line on Filed Surveys 5301 and 7035.

Basis of Bearings is triangulation station "BUTLER (JCS)" to triangulation station "TALENT (JCS)" with grid bearings decreased in azimuth by $\theta = 1^{\circ}29'10"$.

January 27, 1982

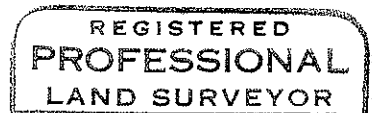
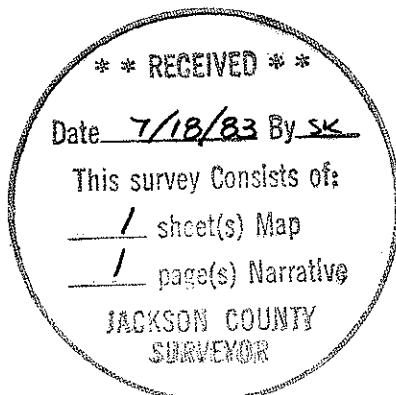

Gary D. Kaiser

