

SURVEY NO. 9467

SURVEY NARRATIVE TO COMPLY WITH PARAGRAPH 209.250, OREGON
REVISED STATUTES.

SURVEY FOR: Sheila P. Komatz
1795 Pine Grove Road
Rogue River, Ore. 97537

PURPOSE: To survey and mark with proper monuments a 5.15 acre
tract of land according to Jackson County Deed Records.

PROCEDURE: Ran traverse tying necessary controlling monuments
to calculate the perimeter of the East 1/2 of the
Southeast 1/4 of Section 16. Calculated distances
and bearings of said East 1/2 agree favorably with
recorded surveys. Calculated location of corners
to be set in this survey. Set 5/8 inch steel pins
according to deed records as shown on the accompanying
plat.
Monuments set are 5/8 inch x 30 inch steel pins with
yellow plastic caps stamped "DW EDWARDS LS 741"

BASIS OF BEARINGS: RS 7586

EQUIPMENT: Lietz TM 20-C Theodolite, Lietz Red-1 EDM and 200
foot steel tape.

DATE COMPLETED: Nov. 4, 1982

Darrel W. Edwards
P. O. Box 801
Rogue River, Ore. 97537
Phone 582-3110

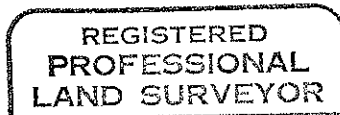
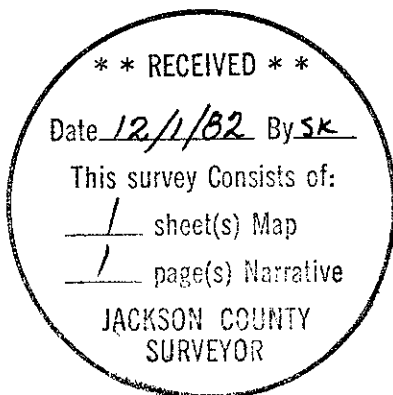

Darrel W. Edwards

