

9445

FD. 1/4 COR. 2" IRON PIPE
 26
 S 89°51'15"E
 400.00'
 SET 5/8"x24" IRON PIN
 C 1/4 COR. SEC. 25

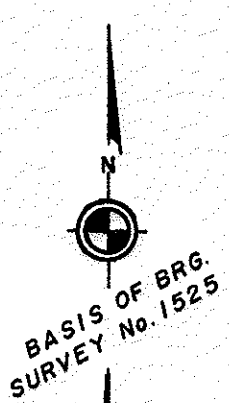

SCALE: 1" = 200'

PROPOSED ROAD LOCATION
 LOCATED IN THE NW 1/4 SW 1/4
 SECTION 25, T.36 S., R.2W., W. M.
 JACKSON COUNTY, OREGON
 FOR
 JACKSON COUNTY DEPARTMENT OF
 PUBLIC WORKS

Survey by:
 CHARLES H. HURST, L.S.
 MEDFORD, OREGON
 FIELD WORK COMPLETED FEB. 8, 1971.

LEGEND

○ Set 3/4" x 30" Iron pins

RESET 1/16 COR. ~ 5/8" X 24" IRON PIN

FD. 1" IRON PIPE R.P. 0.04' W'LY
 S 89°47'15"E
 430.00'
 30'
 BOLT R.P. NOT FD.
 SET 5/8" x 10" IRON PIN
 30'
 GIBBON ROAD
 S.W. 1/16 COR. SEC. 25

FD. 1" IRON PIPE ON LINE ON S. BDY. OF ORR DRIVE

FD. SEC. COR. 2" IRON PIPE

** RECEIVED **
 Date 11/12/82 By SK
 This survey consists of:
1 sheet(s) Map
1 page(s) Narrative
 JACKSON COUNTY SURVEYOR

REGISTERED
 OREGON
 LAND SURVEYOR

Charles H. Hurst

OCTOBER 30, 1959
 CHARLES H. HURST
 483

SEP 10 1982

9445

(TL 4300) 36 2W 25 C

9445

SURVEY NARRATIVE TO COMPLY WITH PARAGRAPH 209.250
OREGON REVISED STATUTES

Survey for: Jackson County Department of Public Works
200 Antelope Road
White City, Oregon 97501

Survey by : Charles H. Hurst
304 South Holly
Medford, Oregon 97501

Bearings : Based on the meridian for Survey No. 1525.

Purpose : To define the boundary and monument the centerline of
Gem Road.

Procedure

Utilization was made of survey control previously established. The S 1/16 corner was reset holding 30 feet from the reference pipe on the north line of Gibbon Road at a point on the west line of Section 25.

Field work was completed February 10, 1971. However, the survey was never fully executed due to some diversity of opinion among adjoining property owners as to whom should be the responsible party.

Ultimately the road became county property in lieu of taxes and said survey was completed at the request of the Jackson County Department of Public Works.

September 10, 1982.

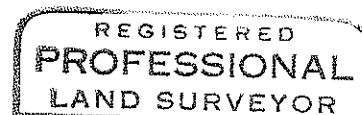
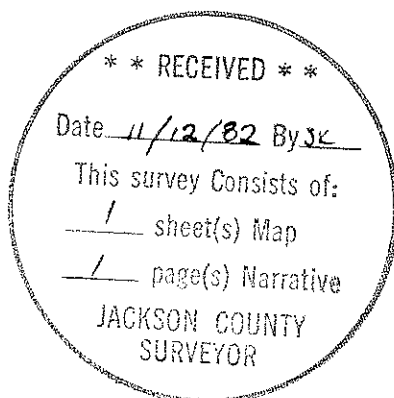

Charles H. Hurst

