

179.16 Ac. ±

SURVEY FOR  
**EUGENE F BURRILL LUMBER Co.**  
 LOCATED IN THE NORTH-HALF OF SECTION 17, T. 36 S., R. 1 W., W.M.  
 SEPTEMBER 10, 1982

SURVEY BY  
 BOYDEN SURVEYORS  
 108 MISTLETOE STREET  
 MEDFORD, OREGON

- LEGEND**
- W.C. = WITNESS CORNER
  - ⊙ FOUND MONUMENT AS INDICATED
  - ⊙ GOV'T CORNER REESTABLISHED BY COUNTY SURVEYOR PERSONNEL
  - ⊙ FOUND BR. DISK IN CONCRETE
  - FOUND MONUMENT AS INDICATED
  - SET 5/8" X 24" REBAR WITH PLASTIC CAP MARKED "KAISER R L S 803"

**\*\* RECEIVED \*\***  
 Date 9/14/82 By BySk  
 This survey consists of:  
 1 sheet(s) Map  
 2 page(s) Narrative  
 JACKSON COUNTY SURVEYOR

REGISTERED  
**PROFESSIONAL LAND SURVEYOR**  
*Sauy D. Kautz*  
 OREGON  
 JULY 16 1967  
 GARY D. KAISER  
 No. 803

**SCALE: 1" = 200'**  
**BASIS OF BEARINGS**  
 FILED SURVEY No. 9257

Survey Narrative  
Eugene F. Burrill Lumber Co.  
Page Two

origin found set near the Northwesterly boundary of the Veterans'  
Domiciliary tract.

Basis of Bearings is Filed Survey No. 9257.

September 10, 1982

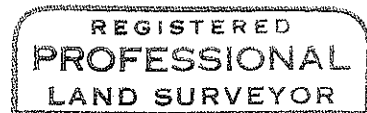
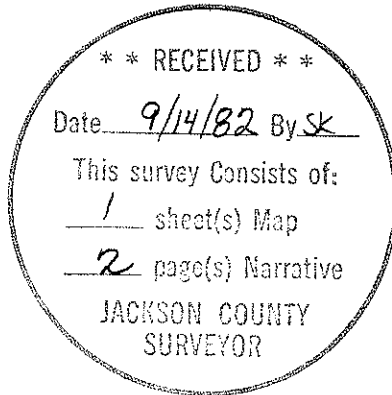

*Gary D. Kaiser*

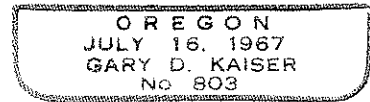

SURVEY NARRATIVE TO COMPLY WITH O.R.S. 209.250

FOR: Eugene F. Burrill Lumber Co.  
8425 Agate Road  
White City, Oregon

BY: Boyden Surveyors  
108 Mistletoe Street  
Medford, Oregon

PUPPOSE: To monument the Burrill property lying Northerly from the most Northerly boundary of that tract described in Vol. 308, Page 469 D.R. as monumented on Filed Survey No. 116 and Easterly from Agate Road being located in Section 17, T36SRIW, W.M. (including that triangular shaped tract SE from the North 1/4 corner to Section 17 presently within Federal ownership which is proposed to be conveyed to Burrill).

Also to monument and describe a proposed boundary line agreement along the most Easterly Burrill boundary.

PROCEDURE: Utilizing a one-second theodolite and EDM equipment, a traverse was run around the subject tract tying control monuments indicated as found on the annexed map.

The bronze disk in concrete found set by the Army Engineers was accepted as the North 1/4 corner to Section 17 after a joint analysis by the County Surveyor and Boyden Surveyors (see Jackson County Surveyor Job File No. 80-9).

As is noted in said Job File 80-9, the present County Surveyor's analysis of the subject 1/4 corner position as determined by County Surveyor A. T. Brown in 1914 versus Deputy County Surveyor C. Z. Boyden's position in 1945, concurred with the Boyden position which is the Army Engineer's monument.

The alignment of the proposed agreement boundary on the most Easterly Burrill boundary is between the 3/4" iron pipe found for the East 1/16 corner set by Deputy County Surveyor, C. Z. Boyden, on the 1945 Pruett Road survey and a 3/4" iron pipe of unknown