

MAP OF SURVEY
FOR
ROGUE RIVER NATIONAL FOREST
P.O. BOX 520
MEDFORD, OREGON
JUNE 28, 1982



- LEGEND**
- FOUND STANDARD BLM OR COUNTY SURVEYOR BRASS CAP MONUMENT
 - FOUND 1" DIA. IRON POST WITH 2" DIA. BELL EXPANDER FILLED WITH POT METAL SET BY RLS 583 (REF. RECORD SURVEY 2533)
 - ⊙ SET 2 1/2" DIA X 30" LG BRASS CAP MONUMENT
 - PROPERTY LINE ESTABLISHED AND POSTED THIS SURVEY
 - SECTION LINE CALCULATED FROM TRAVERSE SURVEY
 - SUBDIVISION LINE CALCULATED FROM TRAVERSE SURVEY

HISTORY OF SURVEYS
REFER TO ATTACHED NARRATIVE FOR HISTORY OF SURVEYS.

**** RECEIVED ****
Date: 8/13/82 BRSK
This survey consists of
1 sheet(s) Map
9 page(s) Narrative
JACKSON COUNTY SURVEYOR

CERTIFICATE OF SURVEY
I, HAROLD L. CENTER, REGISTRATION NO. 1071, REGISTERED PROFESSIONAL LAND SURVEYOR, STATE OF OREGON, HEREBY CERTIFY THAT THIS MAP CORRECTLY REPRESENTS A SURVEY MADE BY ME OR UNDER MY DIRECTION, IN CONFORMANCE WITH THE LAWS OF THE STATE OF OREGON, AT THE REQUEST OF THE U.S. FOREST SERVICE.

REGISTERED PROFESSIONAL LAND SURVEYOR
Harold L. Center
OREGON
HAROLD L. CENTER
JULY 30, 1976
No. 1071



BASIS OF BEARING
SOLAR OBSERVATION

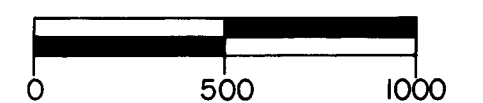

SCALE IN FEET



SCALE IN METERS
1 METER = 3.280833 FEET

U.S. DEPT. OF AGRICULTURE
FOREST SERVICE
REGION 6 ROGUE RIVER NATIONAL FOREST

DEPENDENT RESURVEY AND SECTION SUBDIVISION
SEC. 5&6, T.32S., R.2E., W.M.
JACKSON COUNTY, OREGON

REVIEWED BY *[Signature]* DATE 7/28/82
REVIEWED BY *[Signature]* DATE 7/28/82

At the corner point I set a 2 1/2-inch diameter by 30-inch long galvanized iron post with a 2 1/2-inch diameter brass cap marked:

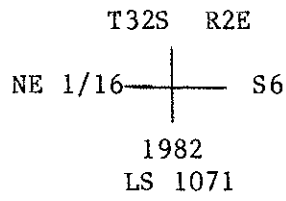

From which the following references:

A fir 8-inches in diameter bears N 53° 40' E, 5.60 feet distance; scribed "NE 1/16 S6 LS 1071 BT."

A fir 22-inches in diameter bears S 09° 44' E, 14.60 feet distance; scribed "NE 1/16 S6 LS 1071 BT."

East one-sixteenth corner of Section 6, Township 32 South, Range 2 East.

At the corner point I set a 2 1/2-inch diameter by 30-inch long galvanized iron post with a 2 1/2-inch diameter brass cap marked:

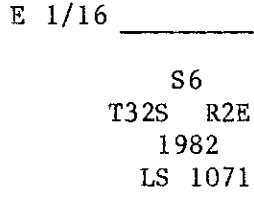

From which the following references:

A fir 11-inches in diameter bears S 31° 36' E, 54.00 feet distance; scribed "E 1/16 S6 LS 1071 BT."

A fir 10-inches in diameter bears S 44° 24' W, 29.20 feet distance; scribed "E 1/16 S6 LS 1071 BT."

June 28, 1982

HAROLD L. CENTER
Registered Professional Land Surveyor
Oregon Certificate No. 1071

REGISTERED
PROFESSIONAL
LAND SURVEYOR
OREGON
JULY 30, 1976
HAROLD L. CENTER
No. 1071

** RECEIVED **
Date 8/12/82 By SK
This survey consists of:
1 sheet(s) Map
9 page(s) Narrative
JACKSON COUNTY
SURVEYOR

From which the following references:

A cedar 22-inches in diameter bears N 05° 35' W, 73.30 feet distance with "T31S R2E S32 BT" scribe marks visible on a partially healed blaze.

A basalt rock 29-inches high by 34-inches long bears N 38° 39' E, 20.80 feet distance with "BX0" chisel marks visible.

Section corner common to Section 33, Township 31 South, Range 2 East, and Sections 4 and 5, Township 32 South, Range 2 East.

At the corner point I found a standard Bureau of Land Management brass cap monument marked:

U.S. Dept. of Interior
Unlawful to Disturb
T31S R2E
S33

S5 | S4

T32S
1966
Cadastral Surveys
Bureau of Land Management

From which the following references:

A fir 38-inches in diameter bears N 03° 18' E, 13.80 feet distance with a healed blaze.

A cedar stump of indeterminate size bears N 42° 34' E, 6.00 feet distance with partial scribe marks visible.

A fir 26-inches in diameter bears S 39° 25' E, 61.90 feet distance with a partially healed blaze.

A pine 25-inches in diameter bears S 18° 10' E, 3.30 feet distance with "4S BT" scribe marks visible.

A pine 40-inches in diameter bears S 68° 50' W, 72.60 feet distance with a partially healed blaze.

CORNERS ESTABLISHED THIS SURVEY

One-quarter corner of Section 5, Township 32 South, Range 2 East.

At the corner point I found a stone 4-inches wide by 8-inches long, with "1/4" clearly visible on the west face, firmly set in a mound of stone. I remove said stone and at the corner point I set a 2 1/2-inch diameter by 30-inch long galvanized iron post with a 3-inch diameter brass cap marked:

1/4 ——— • ———
5
T32S R2E
1982
LS 1071

From which the following references:

A cedar 7-inches in diameter bears S 23° 32' E, 14.25 feet distance; scribed "1/4 S5 LS 1071 BT."

A fir 8-inches in diameter bears S 29° 28' W, 10.40 feet distance; scribed "1/4 S5 LS 1071 BT."

Northeast one-sixteenth corner of Section 6, Township 32 South, Range 2 East.

A pine stump 32-inches in diameter bears S 29° 09' W, 17.00 feet distance to face of blaze; bits of scribe marks visible on blaze.

A cedar 8-inches in diameter bears N 87° 43' W, 31.90 feet distance with "CS BT" scribe marks visible.

North one-sixteenth corner common to Sections 5 and 6, Township 32 South, Range 2 East.

At the corner point I found a 1-inch diameter galvanized iron post with a 2-inch diameter bell expander filled with pot metal, marked:

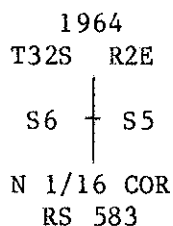

From which the following references:

A fir 24-inches in diameter bears N 38° 11' E, 33.90 feet distance with a healed double blaze.

A fir 24-inches in diameter bears N 86° 36' W, 33.00 feet distance with a healed double blaze.

One-quarter corner of Section 32, Township 31 South, Range 2 East.

At the corner point I found a standard Jackson County Surveyors brass cap monument marked:

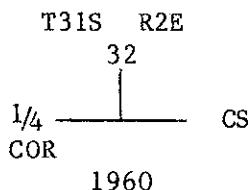

From which the following references:

A fir 41-inches in diameter bears N 18° 59' W, 27.80 feet distance with "1/4 S BT" scribe marks visible in the bark.

A fir 28-inches in diameter bears N 22° 41' E, 50.30 feet distance with a healed blaze.

Section corner common to Sections 32 and 33, Township 31 South, Range 2 East, and Section 5, Township 32 South, Range 2 East.

At the corner point I found a standard Bureau of Land Management brass cap monument marked:

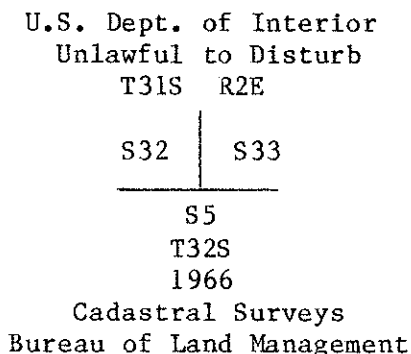

A fir 9-inches in diameter bears N 31° 55' E, 31.50 feet distance with a healed blaze.

A madrone stump 19-inches in diameter bears N 50° 13' E, 29.20 feet distance.

A madrone 13-inches in diameter bears N 67° 22' W, 31.30 feet distance with "RS 583 BT" scribe marks visible on a single blaze.

Section corner common to Section 32, Township 31 South, Range 2 East, and Sections 5 and 6, Township 32 South, Range 2 East.

At the corner point I found a standard Bureau of Land Management brass cap monument marked:

U.S. Dept. of Interior
Unlawful to Disturb
T31S R2E
S32
S6 | S5
T32S
1966
Cadastral Surveys
Bureau of Land Management

From which the following references:

A fir 13-inches in diameter bears S 45° 32' E, 5.00 feet distance with a healed single blaze.

A fir 22-inches in diameter bears S 26° 42' E, 53.90 feet distance with a healed blaze.

A madrone 12-inches in diameter bears S 04° 03' W, 26.00 feet distance with "RS 583 BT" scribe marks visible.

A fir 23-inches in diameter bears S 38° 36' W, 61.00 feet distance with a healed blaze.

An oak 6-inches in diameter bears S 63° 08' W, 23.10 feet distance with a healed blaze.

One-quarter corner common to Sections 5 and 6, Township 32 South, Range 2 East.

At the corner point I found a 1-inch diameter galvanized iron post with a 2-inch diameter bell expander filled with pot metal, marked:

1964
T32S R2E
6 | 5
1981
CS 1/4 COR
RS 583

From which the following references:

A fir 9-inches in diameter bears N 24° 19' E, 10.00 feet distance with healed double blazes.

A cedar 10-inches in diameter bears S 35° 10' E, 16.00 feet distance with "CS BT" scribe marks visible.

A fir snag 23-inches in diameter bears S 55° 33' W, 12.80 feet distance with "BT" scribe marks visible.

A cedar 8-inches in diameter bears N 09° 58' E, 8.10 feet distance with "1/4S" scribe marks visible.

New references:

A fir 8-inches in diameter bears S 81° 51' W, 30.60 feet distance; scribed "1/4 S6 LS 1071 BT."

One-quarter corner common to Sections 6 and 7, Township 32 South, Range 2 East.

At the corner point I found a standard Jackson County Surveyors brass cap monument marked:

Jackson County
T32S R2E

6
1/4S ——— • ———
7
1981

From which the following references:

A fir snag 27-inches in diameter bears S 16° 26' E, 22.80 feet distance with a healed double blaze.

A fir stump 20-inches in diameter bears S 51° 02' W, 2.50 feet distance with "BT" scribe marks visible.

A pine stump 24-inches in diameter bears N 15° 40' W, 20.30 feet distance with "BT" scribe marks visible.

A fir 5-inches in diameter bears S 53° 45' E, 13.95 feet distance with "CS BT" scribe marks visible.

A cedar 6-inches in diameter bears N 08° 17' W, 31.70 feet distance with "CS BT" scribe marks visible.

Section corner common to Sections 31 and 32, Township 31 South, Range 2 East, and Section 6, Township 32 South, Range 2 East.

At the corner point I found a standard Bureau of Land Management brass cap monument marked:

U.S. Dept. of Interior
Unlawful to Disturb
T31S R2E
S31 | S32
—————
S6
T32S
1966
Cadastral Surveys
Bureau of Land Management

From which the following references:

A madrone 18-inches in diameter bears N 46° 01' W, 18.40 feet distance with a healed blaze.

A fir 6-inches in diameter bears N 06° 52' W, 10.60 feet distance with a healed blaze.

From which the following references:

A madrone 28-inches in diameter bears N 85° 40' E, 29.20 feet distance with scribe marks visible on a partially healed blaze.

A fir stump 44-inches in diameter bears S 47° 46' W, 6.10 feet distance with reverse "BT" scribe marks visible.

A fir stump 18-inches in diameter bears N 62° 01' W, 42.20 feet distance with a healed blaze.

A fir 13-inches in diameter bears N 09° 36' E, 61.60 feet distance with "CS BT" scribe marks visible.

A fir 9-inches in diameter bears S 66° 15' W, 80.20 feet distance with "CS BT" scribe marks visible.

One-quarter corner for Section 31, Township 31 South, Range 2 East.

At the corner point I found a standard Bureau of Land Management brass cap monument marked:

U.S. Dept. of Interior
Unlawful to Disturb
T31S R2E
1/4 S31
T32S
1966
Cadastral Surveys
Bureau of Land Management

From which the following references:

A fir 23-inches in diameter bears N 54° 09' W, 13.60 feet distance with a partially healed double blaze.

A fir 10-inches in diameter bears N 08° 55' W, 34.25 feet distance with a healed single blaze.

A fir 14-inches in diameter bears N 45° 16' E, 36.10 feet distance.

A fir 21-inches in diameter bears N 87° 16' E, 27.40 feet distance with an open face.

One-quarter corner for Section 6, Township 32 South, Range 2 East.

At the corner point I found a standard Bureau of Land Management brass cap monument marked:

U.S. Dept. of Interior
Unlawful to Disturb
T31S R2E
1/4 S6
T32S
1966
Cadastral Surveys
Bureau of Land Management

From which the following references:

A cedar 11-inches in diameter bears S 65° 40' E, 19.20 feet distance with a healed single blaze.

A dead and down fir 24-inches in diameter, root hole of which bears S 18° 28' W, 59.70 feet distance.

EQUIPMENT USED: This survey was performed utilizing a Wild T-2 Theodolite and a Hewlett-Packard 3805A Electronic Distance Meter.

CORNERS ACCEPTED FOR CONTROL

Township corner common to Section 36, Township 31 South, Range 1 East; Section 31, Township 31 South, Range 2 East; Section 1, Township 32 South, Range 1 East; and Section 6, Township 32 South, Range 2 East.

At the corner point I found a standard General Land Office monument with a 3 3/4-inch diameter brass cap marked:

U.S. General Land Office
T31S
R1E R2E
S36 S31

S1 S6
T32S
19136*

* Note: Date stamped on brass cap is incorrect; this corner was remonumented by the U.S. General Land Office in 1936.

From which the following references:

A pine 35-inches in diameter bears N 55° 43' W, 61.88 feet distance with a healed blaze.

A fir stump 32-inches in diameter bears S 22° 42' E, 67.00 feet distance with scribe marks visible.

A hollow, decayed oak of indeterminate size bears S 16° 51' E, 27.10 feet distance with reverse "BT" scribe marks visible.

A madrone 32-inches in diameter bears N 48° 19' E, 21.90 feet distance.

A decayed pine stump, cut flush with the ground, bears S 42° 36' W, 42.20 feet distance.

A pine 26-inches in diameter bears N 22° 36' E, 31.20 feet distance with an open face.

New references:

A cedar 16-inches in diameter bears S 19° 47' W, 87.66 feet distance; scribed "T32S R1E S1 LS 1071 BT."

A cedar 20-inches in diameter bears S 51° 51' E, 36.60 feet distance; scribed "T32S R2E S6 LS 1071 BT."

One-quarter corner common to Section 1, Township 32 South, Range 1 East, and Section 6, Township 32 South, Range 2 East.

At the corner point I found a standard Jackson County Surveyors brass cap monument marked:

Jackson County
T32S
R1E R2E
1 6

1/4S
1982

PROCEDURE:

Prior to commencement of this survey, an investigation of all controlling section and one-quarter section corners was made. All corners have been recovered and remonumented by either the General Land Office; the Bureau of Land Management, Division of Cadastral Surveys; R.L.S. 583; or the Jackson County Surveyor, with the exception of the North one-quarter corner of Section 5.

The North boundaries of Sections 5 and 6 were originally surveyed by Turner and Howard; Peter Applegate performed a resurvey of those boundaries in 1891. An analysis of those surveys was made in order to determine if Turner and Howard's 1870 corners or Applegate's 1891 corners controlled alignment along the North lines of Sections 5 and 6. The 1870 survey showed the North lines of Sections 5 and 6 at close to cardinal bearing and slightly long in distance. Applegate's 1891 resurvey, utilizing Turner and Howard's 1870 corners as a basis for that dependent resurvey, revealed the North line of Sections 5 and 6 to be defective in both alignment and distance. Applegate changed Howard and Turner's corners to corners of minimum control for Township 32 South, Range 2 East, and established controlling corners for Township 31 South, Range 2 East only, on line between Howard and Turner's corners. The first patents to lands in Sections 5 and 6 were issued in 1904, based on Applegate's 1891 plat.

After studying the patent information, the original plats and field notes, and consultation with Bureau of Land Management officials, I determined that both the 1870 corners and the 1891 corners control alignment. I held Turner and Howard's 1870 corners and Applegate's 1891 corners as angle points along the line. This protects the patents as issued from Applegate's 1891 plat.

With the required controlling corner positions verified, I established a series of traverse lines tying all corners to part of a closed traverse. From this information I computed a search area for the North one-quarter corner of Section 5. After a diligent search I found a stone clearly marked "1/4" on the west face and firmly set in a mound of stone. I also found the 8-inch diameter fir as described by Jackson County Deputy Surveyor Mark E. Boyden, reference Record Survey No. 1754. This tree is now dead and down. Although Surveyor Applegate did not call for establishment of a stone monument the position of the recovered stone fits within reasonable limits in alignment and 0.24 feet in distance of the record as described by Deputy Surveyor Applegate in 1891. Also the marks on this stone were identical to the marks on the stone found at the one-quarter corner of Section 32, Township 31 South, Range 2 East, established by Applegate in 1891. I therefore accept the position marked by the stone and remonument said position as described later in this narrative.

With all required corner points recovered and tied to a closed traverse, I proceeded to subdivide Section 6, monumenting the required corner points and posting property lines as required. Property lines were posted using aluminum posts with National Forest boundary signs attached. Trees along the property line were blazed and painted with red timber marking paint.

SURVEY NARRATIVE TO COMPLY WITH
PARAGRAPH 209.250 OREGON REVISED STATUTES

SURVEY FOR: Rogue River National Forest
P. O. Box 520
Medford, OR 97501

LOCATION: Sections 5 and 6, Township 32 South, Range 2 East,
Willamette Meridian, Jackson County, Oregon.

BASIS OF BEARING: Solar observation

PURPOSE: To establish corners and mark and post National
Forest boundaries within Sections 5 and 6.

HISTORY OF SURVEYS: The original survey of Sections 5 and 6 was per-
formed by Deputy Surveyors William Turner and James
Howard under Contract No. 149, dated September 9,
1870. The North lines of Sections 5 and 6 were
resurveyed by Deputy Surveyor Peter Applegate under
Contract No. 571, dated April 10, 1891.

A collateral evidence report for the North one-
quarter corner of Section 5 was filed by Mark E.
Boyden, Jackson County Deputy Surveyor, reference
Record Survey No. 1754, dated October 21, 1960.

Robert M. Vincent, R.L.S. 583, remonumented and
established certain corner points within Sections 5
and 6, reference Record Survey No. 2533 (dated June
9, 1964) and Nos. 2734 and 2736 (both dated
December 16, 1964) as follows:

1. Established North one-sixteenth corner common
to Sections 5 and 6, Township 32 South, Range
2 East. (R.S. No. 2533)
2. Remonumented the West one-quarter corner of
Section 5, Township 32 South, Range 2 East.
(R.S. No. 2533)
3. Marked new bearing trees at the corner common
to Sections 5 and 6, Township 32 South, Range
2 East. (R.S. No. 2533)
4. Marked a new bearing tree at the corner common
to Sections 31 and 32, Township 31 South,
Range 2 East. (R.S. No. 2533)
5. Remonumented the West one-quarter corner of
Section 6, Township 32 South, Range 2 East.
(R.S. No. 2734)
6. Remonumented the South one-quarter corner of
Section 6, Township 32 South, Range 2 East.
(R.S. No. 2736)

The Jackson County Surveyors Office subsequently
remonumented the South one-quarter corner of
Section 6 in 1981 and the West one-quarter corner
of Section 6 in 1982.

No other Surveys of Records were noted.