

SE 1/4 of NE 1/4 of NW 1/4  
SEC. 16

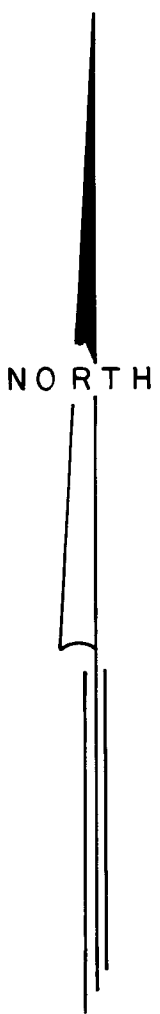

**MAP OF SURVEY**  
 LOCATED IN  
 NW 1/4 OF SEC. 16, TWP. 39 S., R. 1 E.W.M.  
 JACKSON COUNTY OREGON  
 for  
**DAVID R. LEWIS**  
 1024 PINECREST TERRACE  
 ASHLAND, OREGON 97520

**SWAIN SURVEYING, INC.**  
 27 1/2 N. MAIN STREET  
 ASHLAND, OREGON 97520  
 BASIS OF BEARING:

JUNE 30, 1982  
 SCALE: 1" = 60'  
 TRUE MERIDIAN AT N-S @ SEC. 16  
 (derived from N.O.A.A. net)

- FOUND MONUMENT AS SHOWN
- FOUND MONUMENT AS SHOWN
- ⊙ CORNER PER RECORD SEE R.S. AS INDICATED ON SHEET 2 of 2
- SET MONUMENT AS SHOWN
- ◇ SET 5/8 x 30 INCH IRON PIN TAGGED WIT COR RLS 759

REGISTERED  
**PROFESSIONAL**  
**LAND SURVEYOR**  
*Everett L. Swain*  
 OREGON  
 JULY 8, 1966  
 EVERETT L. SWAIN  
 759

**\*\* RECEIVED \*\***  
 Date 7/7/82 By SK  
 This survey consists of:  
2 sheet(s) Map  
10 page(s) Narrative  
**JACKSON COUNTY**  
**SURVEYOR**

I, James H. Olson, Ashland City Surveyor, do hereby certify this to be a true copy of page 48 of the City of Ashland's "Intersection Ties" loose leaf binder which is on file in the office of the Ashland City Surveyor.

IN WITNESS WHEREOF, I have set my hand and seal this 6th day of July 1982

*James H. Olson*  
James H. Olson  
Ashland City Surveyor

*Winona G. Swain*  
WINONA G. SWAIN  
NOTARY PUBLIC - OREGON  
My Commission Expires 6/20/86

STATE OF OREGON  
County of Jackson

July 6 A.D. 1982

Personally appeared the above named James H. Olson and acknowledged the foregoing instrument to be his voluntary act and deed.

Before me:

*Winona G. Swain*  
Notary Public for Oregon  
My Commission expires 6/20/86

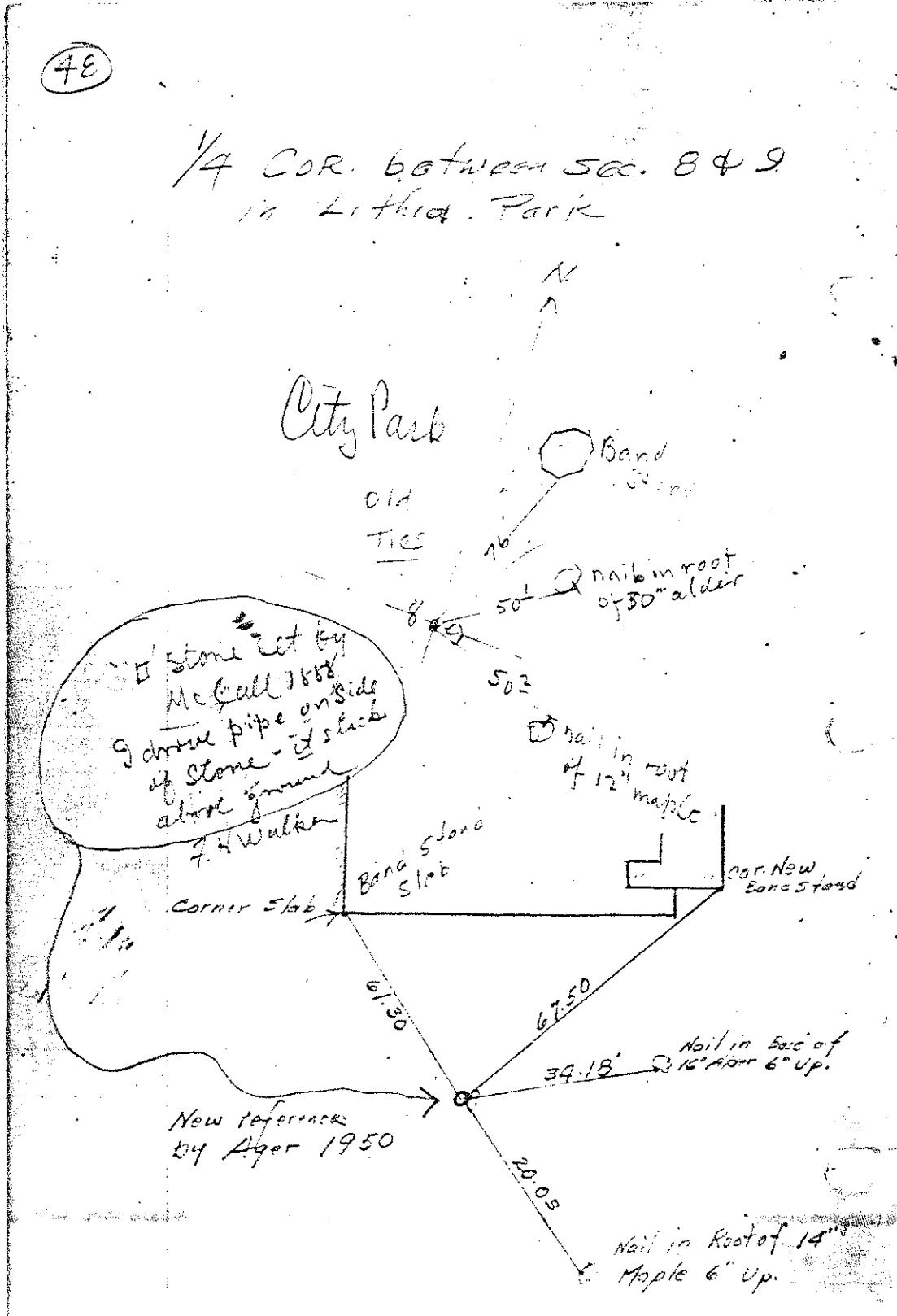

I, James H. Olson, Ashland City Surveyor, do hereby certify this to be a true copy of page 49 of the City of Ashland's "Intersection Ties" loose leaf binder which is on file in the office of the Ashland City Surveyor.

IN WITNESS WHEREOF, I have set my hand and seal this 6th day of July 1982

*James H. Olson*  
James H. Olson  
Ashland City Surveyor

STATE OF OREGON

SS

County of Jackson

July 6 A.D. 1982

Personally appeared the above named James H. Olson and acknowledged the foregoing instrument to be his voluntary act and deed.

Before me:

*Winona G. Swain*  
WINONA G. SWAIN  
NOTARY PUBLIC — OREGON  
My Commission Expires 6/20/86

*Winona G. Swain*  
Notary Public for Oregon  
My Commission expires 6/20/86

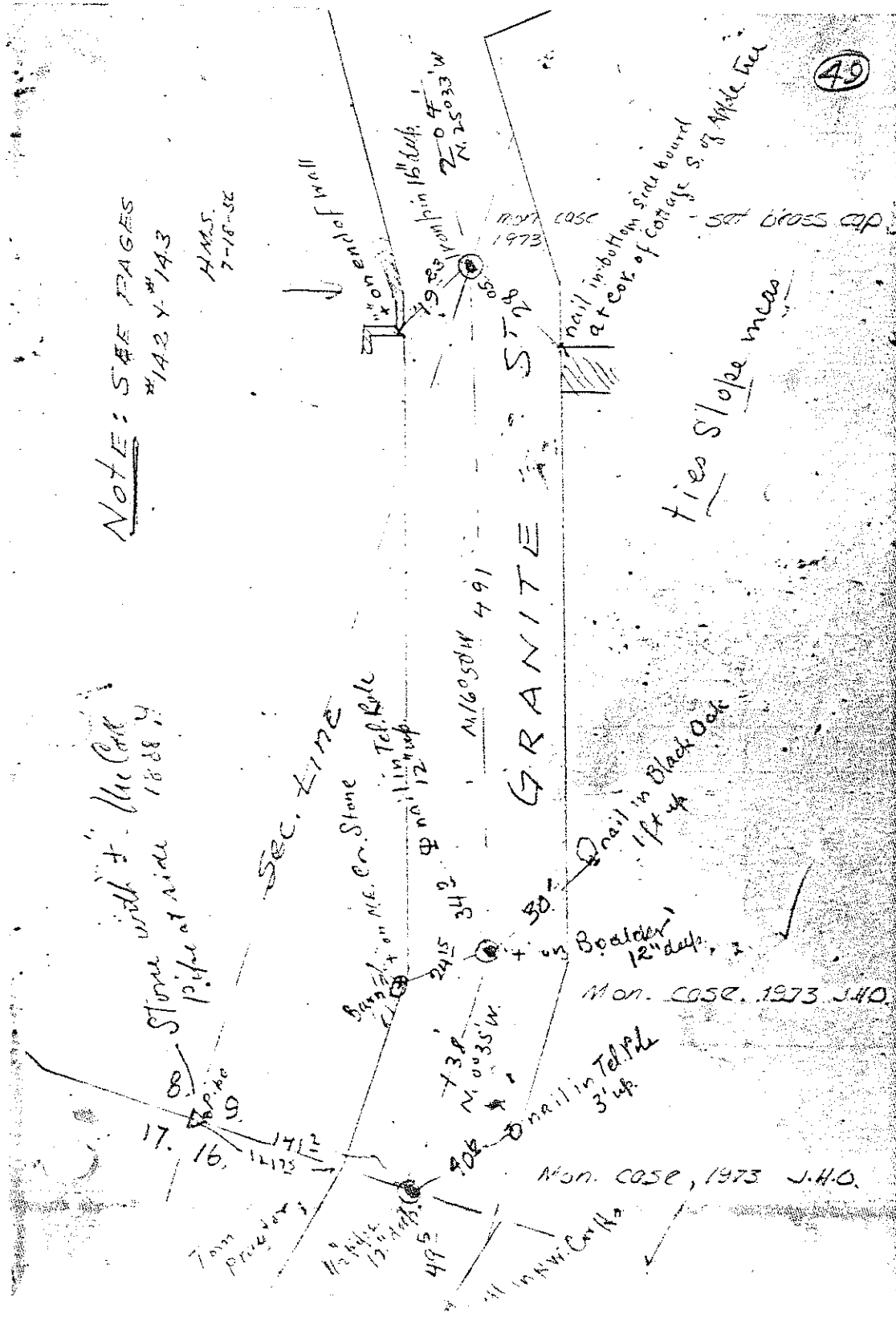

I, James H. Olson, Ashland City Surveyor, do hereby certify this to be a true copy of page 33 of F. H. Walker's survey field book No. 3 which is on file in the office of the Ashland City Surveyor.

IN WITNESS WHEREOF, I have set my hand and seal this 6th day of July 1982

*James H. Olson*  
James H. Olson  
Ashland City Surveyor

STATE OF OREGON

County of Jackson <sup>SS</sup>

July 6 A.D. 1982

Personally appeared the above named James H. Olson and acknowledged the foregoing instrument to be his voluntary act and deed.

Before me:

*Winona G. Swain*  
WINONA G. SWAIN  
NOTARY PUBLIC — OREGON  
My Commission Expires 6/20/86

*Winona G. Swain*  
Notary Public for Oregon  
My Commission expires 6/20/86

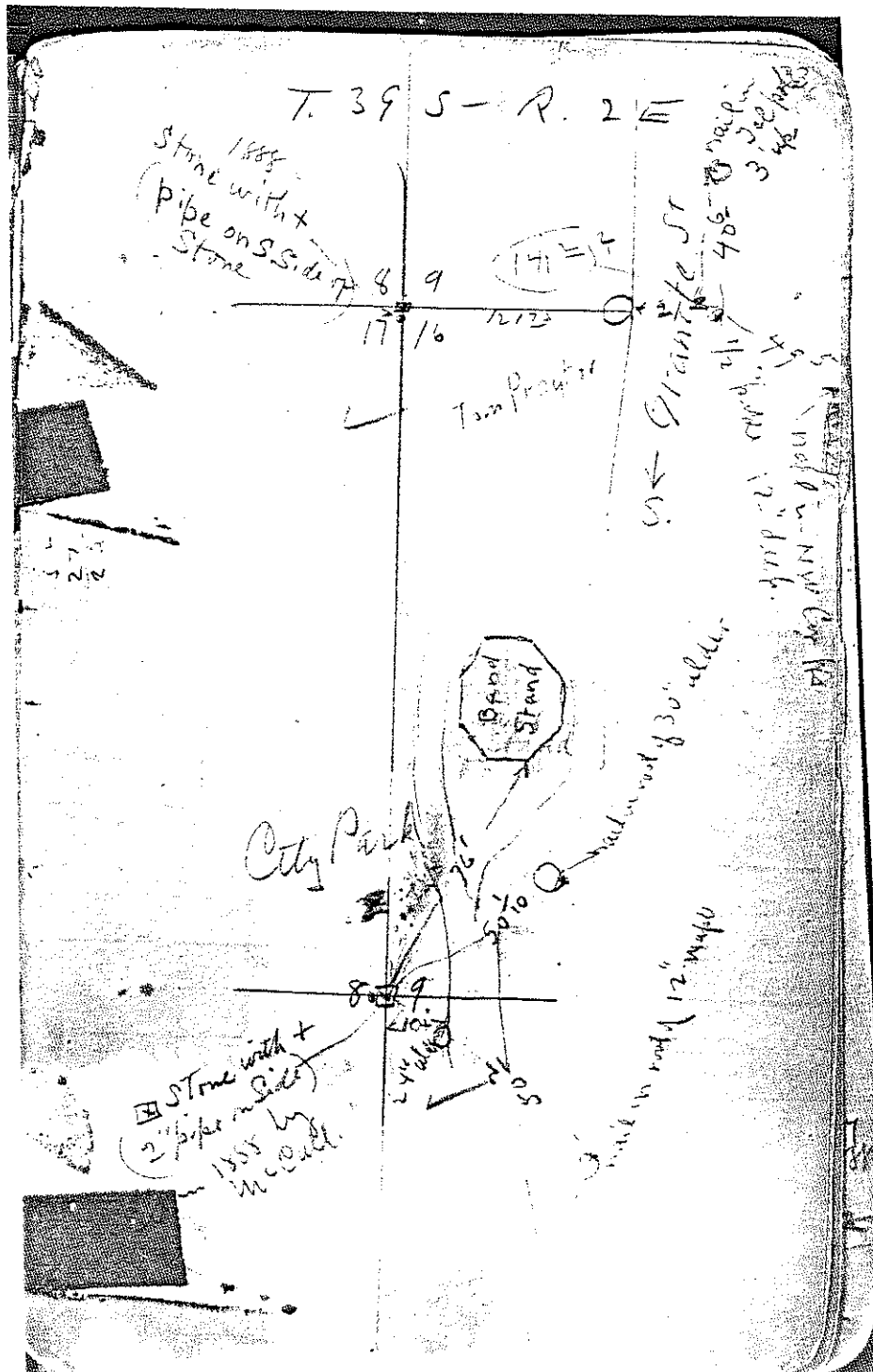

for a terminus of this survey.

Said street will occupy 2473 square feet of land owned by Mrs. Blanton, 3055 square feet of land owner of which is unknown, 25160 square feet of land owned by C. P. Jones. Plat accompanies this report.

Respectfully submitted.

This 12<sup>th</sup> day of November 1891. M. L. McCall,

City Surveyor.

be and hereby is adopted and the pieces or parcels of land included in the boundaries of such survey as shown by the map and plat accompanying said report which have heretofore been dedicated by the owners thereof or heretofore acquired by the said city for street purposes are hereby accepted by the said city and all parts or portions of said proposed street that have not been so dedicated, shall be appropriated pursuant to law in such cases made and provided, for use as a public street in the said city of Ashland, and said street when changed and established and fully opened shall be denominated and known as Granite Street.

### Section 2.

This Ordinance shall take effect and be in force from and after its adoption by the city Council and its approval by the Mayor.

City of Ashland,  
Jackson County, ss.  
State of Oregon.

I, Milton Berry,  
Recorder of the City of Ashland,  
Jackson County, State of Oregon  
Certify that the foregoing Ordinance  
was adopted by the City Council of Ashland Oregon  
on Jan. 4<sup>th</sup> 1892.

Attest - Milton Berry,  
Recorder.

Approved Jan. 4, 1892.

J. M. Fairinger  
Mayor

City Ordinance No. 112.

An Ordinance to change the location and establish that portion of Granite street in the City of Ashland Jackson County State of Oregon in this Ordinance described.

The People of the City of Ashland do ordain as follows:

Section 1.

That the report of the City Surveyor which is as follows, viz:

"To the Hon. Mayor and Council of the City of Ashland, Oregon:

Gentlemen - Pursuant to your order of November 2nd 1891 I have made survey and plat showing a change in a part of Granite street as follows, to-wit:

Beginning at a point on section line in the center of Granite street in the City of Ashland, Oregon,  $141\frac{75}{100}$  feet easterly from the corner of sections 8, 9, 16, and 17 in township 39 south of range one east of the Willamette Meridian, Oregon; thence North  $0^{\circ}35'$  west  $138\frac{1}{10}$  feet; thence North  $16^{\circ}50'$  west 491 feet to a piece of one inch iron pipe two feet long driven in the ground on the line between sections 8 and 9 in said township and range; thence north  $25^{\circ}35'$  west  $204\frac{1}{10}$  feet to an iron pin at the intersection of the center lines of granite street and Hargadine Avenue.

EXHIBIT 'A'  
page 1

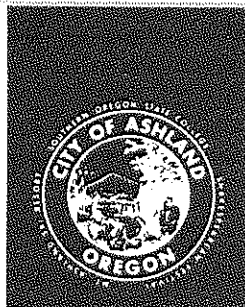

9339

CITY OF ASHLAND

CITY HALL

ASHLAND, OREGON 97520  
Telephone (Code 503) 482-3211

July 6, 1982

STATE OF OREGON)  
County of Jackson: ss.  
City of Ashland)

I, NAN E. FRANKLIN, City Recorder, of the City of Ashland, Oregon, hereby certify that I am the official custodian of all documents and records of the said City and that I have prepared the attached copy of City Ordinance No. 112.

The attached is a copy of original filed in my office and it is a correct, true and complete transcript.

Dated this 6th day of July 1982.

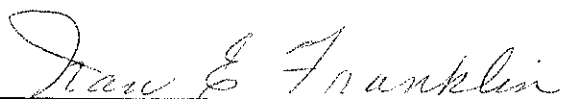

Nan E. Franklin, City Recorder  
City of Ashland, Oregon.

Subscribed and sworn to before me this 6<sup>th</sup> of July 1982.

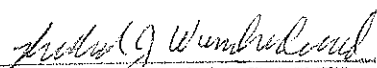
  
RICHARD J. WANDERSCHIED  
NOTARY PUBLIC - OREGON  
My Commission Expires 8-6-84

  
Notary Public for Oregon  
My Commission expires 8-6-84

SURVEY NO. 9339

David R. Lewis  
page 4

The Easterly, Southerly and a portion of the Westerly and Northerly boundary lines were flagged with fluorescent ribbon to indicate the approximate boundary lines between set monuments.

See Exhibits 'A' 'B' 'C' and 'D', attached hereto and incorporated herein and thereby made a part of this report.

The remainder of the survey is as set forth on the attached map.

**BASIS OF BEARING:**

True Meridian at the N-S centerline of Section 16 as derived from the National Oceanic and Atmospheric Administration (formerly Coast & Geodetic Survey) survey net established in 1968 and filed in the office of the Jackson County Surveyor.

July 2, 1982

Swain Surveying, Inc.  
27 1/2 N. Main Street  
Ashland, Oregon 97520

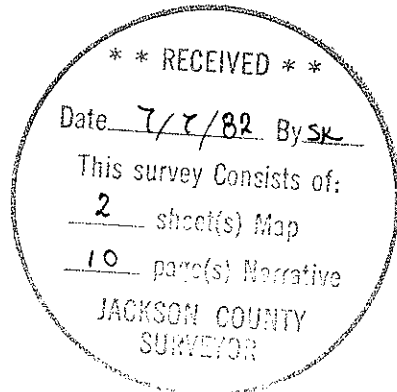
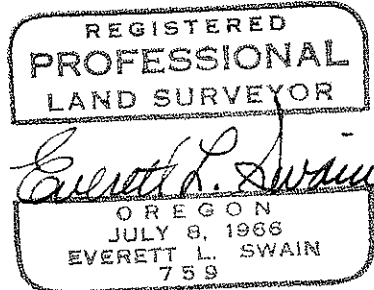



David R. Lewis  
page 3

reject the call for said pipe, by Lynn M. Roseberry, Cadastral Surveyor for the United States Department of the Interior, Bureau of Land Management, as being the section corner. Reference: Field Notes of the Corrective Dependent Resurvey of a Portion of the Subdivisional Lines and Subdivisional Lines of Section 17, and the Remonumentation of an Original Corner Point, Township 39 South, Range 1 East of the Willamette Meridian, in the State of Oregon. Executed by Lynn M. Roseberry, Cadastral Surveyor under special instructions dated May 3 1957, approved May 6, 1957; Special Instructions dated March 23, 1960, approved March 24, 1960; Supplemental Special Instructions dated June 1, 1976, approved June 2, 1976 which provided for the surveys included under Group Numbers 350 and 434, and assignment instructions dated July 19, 1976.

Survey commenced July 19, 1976  
Survey ended July 23, 1976

Now turning to the quarter corner common to Sections 16 and 21, Township 39 South, Range 1 East, I have search for this corner for the past several years. No records have been uncovered, up to this point in time, that would suggest this corner was in existence or was found by anyone after the original government survey. Another search was made at this time with still negative results. Therefore, at a proportioned corner location I set the following:

1/4 SECTION CORNER common Sections 16 and 21, Township 39 South, Range 1 East of the Willamette Base and Meridian.

At the corner point set a 40 inch long by 1 inch diameter galvanized iron pipe, 39 inches in the ground with a 2 1/2 inch diameter bronze cap marked:

Swain Surveying  
T.39S. R.1E.  
1/4  $\frac{S\ 16}{S\ 21}$  Cor.  
L.S. 759

Survey Monument 1982  
in a mound of stones from which:

A Granite Boulder, 18"x 30" x ?, exposed 30 inches at Southerly face bears North 19°31' East, 48.66 feet to a chiseled "+" with letters "BO" for Bearing Object placed above said chiseled "+".

A Douglas Fir, 9 inches DBH, bears South 75°09' West, 22.72 feet to center of tree, scribed 1/4 S 21 BT.

A Douglas Fir, 14 inches DBH, bears North 33°10' West, 38.28 feet to center of tree, scribed 1/4 S 16 BT.

A dry draw <sup>C</sup> North 66° East - South 66° West bears North 33°10' West, 18.8 feet to approximate center.

Witness: Robert Malotte

Along the Westerly boundary line of the Southeast quarter of the Northeast quarter of the Northwest quarter of said Section 16, there exist a fence encroachment. Witness corners were set on the North and West boundary lines near the location of said fence.

David R. Lewis  
page 2

On February 16, 1886, M.L. McCall made two (2) surveys for W.H. Wickam wherein he commenced his surveys at the section corner common to Sections 8, 9, 16 and 17, T.39S. R.1E See Field Book #5 (C) pages 98 and 99.

On June 27, 1891, M.L. McCall conducted a survey for C.P. Jones which is as follows: "To change part of Granite Street in Ashland Or.

Begin at a stake in center of Granite St. & on line bet Secs 9 & 16, T39S R1E WM or 141.75 ft East of SW cor said Sec 9. thence N.0°35'W. 138.1 ft N.16°50'W 491 " to a piece of iron pipe 1" dia drove in center of said Granite st on line bet Secs 8 & 9 in said T & R. thence N.25°33'W. 204.1' to intersection of the center line of Granite St with the center line of Hargadine Avenue." See Field Book # 1 (A) page 85.

Apparently Ashland City Ordinance No. 112, which was adopted by the City Council of Ashland, Oregon and approved by the Mayor on January 4, 1892 was a direct result of the survey McCall shows conducting for C.P. Jones on June 27, 1891. See copy of City Ordinance attached hereto and made a part of this report.

With the above references to said section corner, I now want to go to F.H. Walker's Field Book #3, commonly referred to as the "tie book". On page 33 there are diagrams showing what was at the section corner common to Sections 8, 9, 16 and 17 and the 1/4 corner common to Sections 8 and 9. It should be noted that the Twp is 39 South, but the Range is erroneously shown as 2 East instead of 1 East. This error is obvious as no street by the name of Granite Street or no band stand in a city park exist in Twp. 39 South, Range 2 East that I am aware of. Now returning to the explanation of the section corner; said diagram shows a "stone with X" at the corner common to Sections 8, 9, 16 and 17, T.39S. R. 1E. there also shows "pipe on S. side of stone" and graphically shows the pipe being Southerly of said section corner. A 1/2 inch iron pipe is shown in Granite Street which is Easterly of said section corner. Now, to further illustrate the point that the pipe at the vicinity of the section corner common to Sections 8, 9, 16 and 17 is not the true section corner, the quarter corner common to Sections 8 and 9 is shown on the same page of the same field book. As hereinabove provided, M.L. Mc Call set a sandstone at the quarter corner on March 7, 1890 (Ashland Survey Book titled "Ashland Surveys" page 74). This tie information in F.H. Walker's Field Book #3 page 33 shows a "+" stone with "+" at the quarter corner common to Sections 8 and 9. He further shows graphically and states "2" pipe on side".

Another City of Ashland loose leaf binder titled "Interesection Ties" shows evidence of stones being situated at both the quarter corner and section corner in question. Therefore, with that survey filed in the office of Jackson County Surveyor as No. 8239, showing the relationship of the retracement of the various monuments elucidated hereinabove, survey No. 8239 shows the positioning of the True location of the section corner common to Sections 8, 9, 16 and 17, Township 39 South, Range 1 East to be Northwesterly of said existing pipe and as shown in the various tie books in the possession of the City of Ashland. This true position would also correlate with the surveys as called for by M.L. McCall. Therefore, I find it necessary to

SURVEY NARRATIVE TO COMPLY WITH PARAGRAPH 209.250  
OREGON REVISED STATUTES

SURVEY FOR: David R. Lewis  
1024 Pinecrest Terrace  
Ashland, Oregon 97520

LOCATION: Situated in the Northwest quarter of Section 16, Township 39 South,  
Range 1 East of the Willamette Base and Meridian, Jackson County,  
Oregon.

PURPOSE: To establish and monument the boundaries of the Southeast quarter of  
the Northeast quarter of the Northwest quarter of Section 16, Township  
39 South, Range 1 East of the Willamette Base and Meridian, Jackson  
County, Oregon.

PROCEDURE: First of all, the question of the location of the section corner common  
to Sections 8, 9, 16 and 17, said Township and Range should be explored.  
It has been suggested in the past, that a 2 inch iron pipe in the  
vicinity of said section corner has been thought by some, to be the  
position of said section corner. I do now and I did then, as shown  
on Recorded Survey No. 8239, take exception to the 2 inch pipe being  
called the section corner and the following data will provide  
information to support that position. On March 28, 1889, M.L. McCall  
divided the South half of the Southwest quarter of Section 9,  
Township 39 South, Range 1 East as shown in Field Book 'A', page 117.  
The monument found at the West 1/16 corner common to Sections 9 and  
16, is of the type commonly set by McCall. Also, the retracement  
of McCall's survey line and monuments (see Recorded Survey No. 8239)  
shows a very consistent relationship to those values as set forth  
in said Field Book 'A' On June 5, 1894, M.L. McCall conducted the  
following:

"Survey for City changing part of Terrace St."  
"Begin at standard iron pin at NW cor  
of NE<sup>4</sup> of NW<sup>4</sup> of Sec. 16. T.39S. R.1E."  
thence . . . . .

see Field Book #1 (A) page 162

Further evidence of said iron pin (called iron bar by this surveyor,  
E.L. Swain) is indicated in a survey of Glenview Drive by Walker  
and McKissick on May 11 and 12, 1914 for the City of Ashland. See  
Field Book 'J' page 43.

On September 23, 1889, M.L. McCall made a survey for W.H. Wickam wherein  
he started at an "iron pin or a piece of galvanized pipe, 24"x1" on  
section line bet secs 8 & 9, 9.24 chains North of cor. common to  
Secs. 8, 9, 16 & 17, T.39S R.1E. W.M. in center of Granite St." and  
proceeded to conduct his survey. See Field Book 'A' page 169.

On March 7, 1890, M.L. McCall proceeded to "survey to re-establish  
the 1/4 cor. bet Secs. 8 & 9, T.39S., R.1E. W.M." He further states  
"Begin at cor. to Secs. 8, 9, 16 & 17 and set a flag at cor. to  
Secs. 4, 5, 8 & 9. I find the course to be N.11'W. and the length  
of the line to be 79.89 chains and at 39.94 1/2 chs I set a sandstone  
8 x 11 x 18 marked on E side 1/4 S. with X on top, hole drilled in  
center of cross for 1/4 cor." See City of Ashland survey book titled  
"Ashland Surveys" page 74.

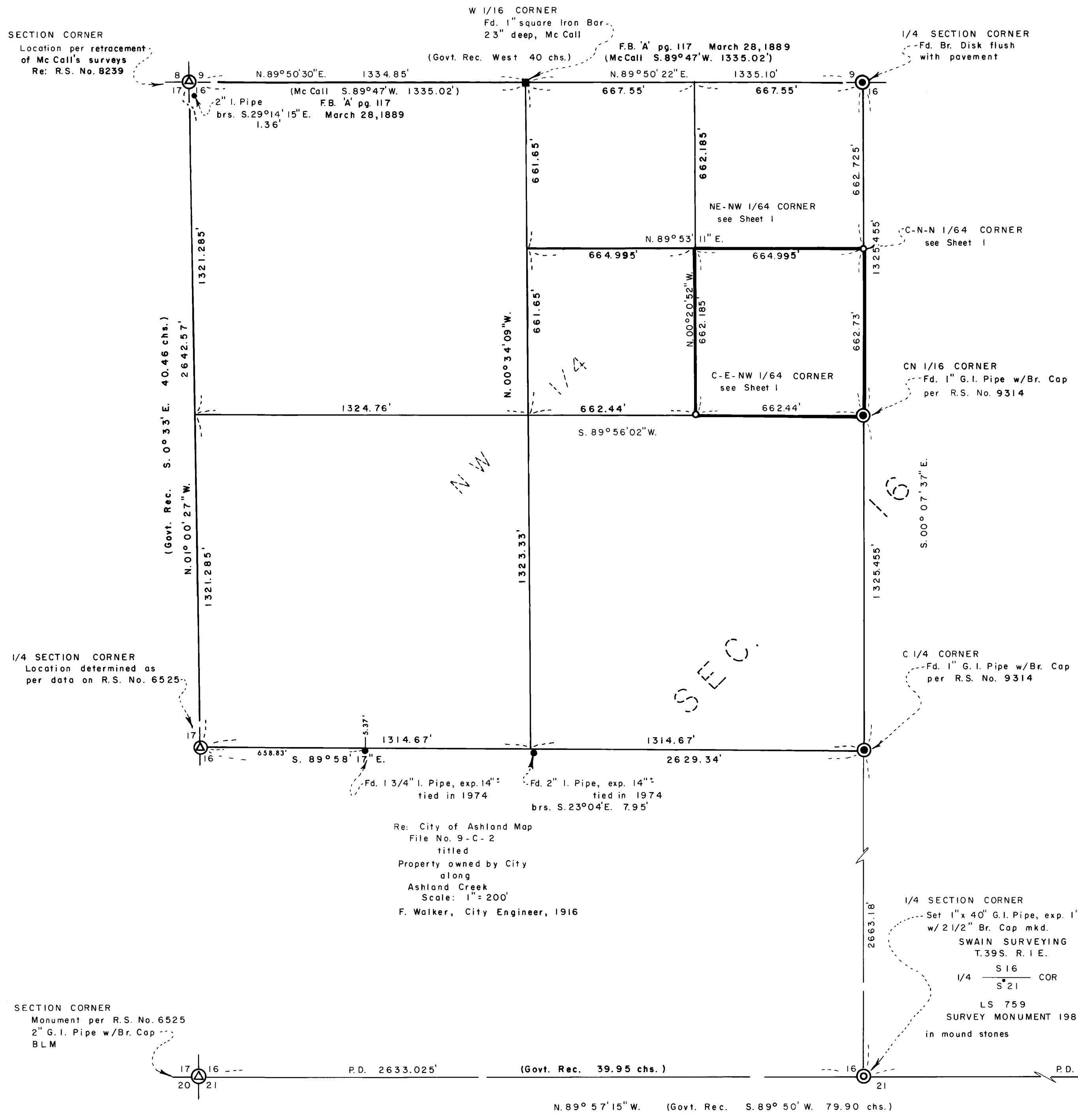

**LEGEND**

NE	Northeast
NW	Northwest
SW	Southwest
SE	Southeast
C	Center
E	East
N	North
SEC.	Section
Fd.	Found
B.	Black
I.	Iron
G.	Galvanized
w/	with
exp.	exposed
brs.	bears
Alum.	Aluminum
mkd.	marked
Br.	Bronze
R. S.	Recorded Survey
No.	Number
Re:	Reference
X—X	Existing fence
P. D.	Proportional Distance
Govt.	Government
Rec.	Record
chs.	chains
F.B.	Field Book
pg	page
P. R.	Plot Record

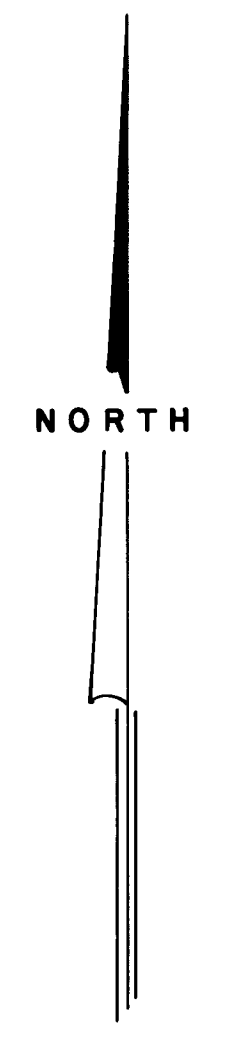

Scale: 1" = 300'

REGISTERED  
PROFESSIONAL  
LAND SURVEYOR  
*Everett L. Swain*  
OREGON  
JULY 6, 1998  
EVERETT L. SWAIN  
759

**\*\* RECEIVED \*\***  
Date 7/7/82 By SK  
This survey consists of:  
2 sheets Map  
10 pages Narrative  
JACKSON COUNTY  
SURVEYOR

Re: City of Ashland Map  
File No. 9-C-2  
titled  
Property owned by City  
along  
Ashland Creek  
Scale: 1" = 200'  
F. Walker, City Engineer, 1916

1/4 SECTION CORNER  
Set 1" x 40" G.I. Pipe, exp. 1"<sup>1</sup>,  
w/ 2 1/2" Br. Cap mkd.  
SWAIN SURVEYING  
T. 39S. R. 1E.  
S 16  
S 21 COR  
LS 759  
SURVEY MONUMENT 1982  
in mound stones

SECTION CORNER  
Monument per R.S. No. 6525  
2" G.I. Pipe w/Br. Cap  
BLM

DAVID R. LEWIS  
Sheet 2 of 2

(TL 700) 39 1E 16 BA