

# SURVEY IN THE NW 1/4 OF SECTION 15, T.37 S., R.1 E., W.M., JACKSON COUNTY, ORE.

FOR  
DARRELL L. ROSE

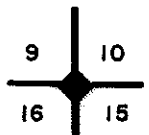

FD. SEC. COR.  
2" IRON PIPE



BASIS OF BRGS.  
SURVEY 7308-  
(SECTION LINE)

SCALE: 1" = 300'

\*\* RECEIVED \*\*

Date: 3/22/82 By SK

This survey Consists of:

1 sheet(s) Map

1 page(s) Narrative

JACKSON COUNTY  
SURVEYOR

### LEGEND

- SET 5/8" X 24" IRON PIN
- △ COURSE OF CANYON CRK.
- OTHER MONS. (SEE SURVEY NO. 7810)

MEAS. N 0° 16' 00" E 2651.61'

N 1/16 COR.  
SET 1" X 26" IRON PIPE IN STONE MOUND  
CTR. 18" DIA. DOUG. FIR BRG. N 36° W 16.70' MKD. "N 1/16 S 16 BT"  
CTR. 9" DIA. DOUG. FIR BRG. S 1° 30' E 19.25' MKD. "N 1/16 S 15 BT"

N 89° 37' 32" E

COMPUTED POS. FOR  
NW 1/16 COR.

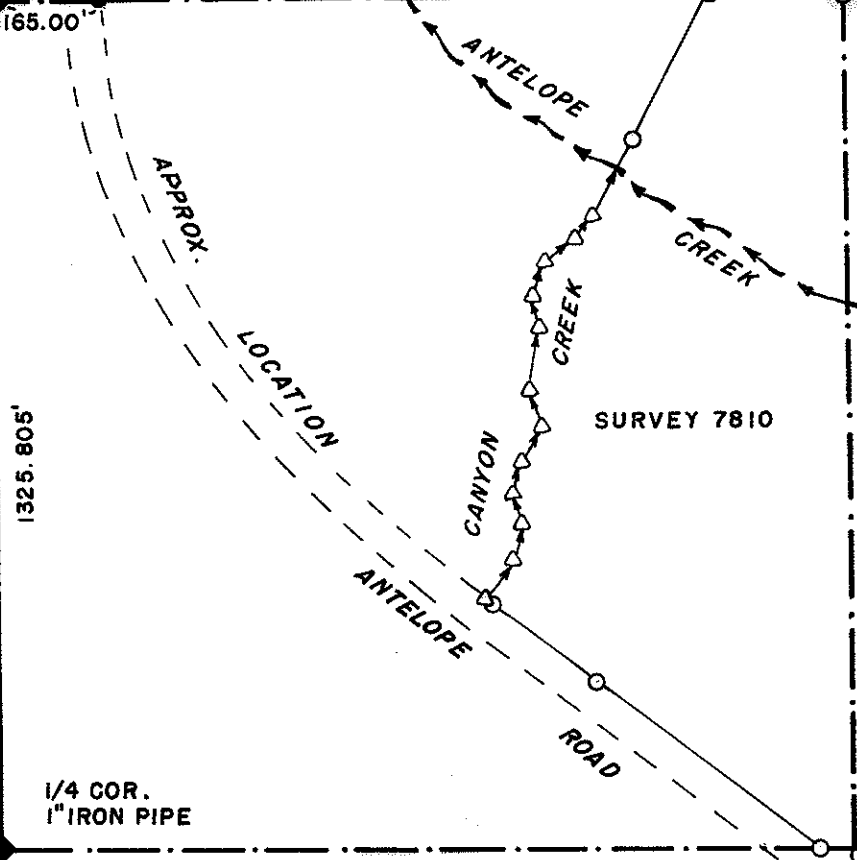

SURVEY BY  
CHARLES H. HURST  
MEDFORD, OREGON  
MARCH 5, 1982

REGISTERED  
PROFESSIONAL  
LAND SURVEYOR

*Charles H. Hurst*

OREGON  
OCTOBER 30, 1959  
CHARLES H. HURST  
483

6  
2  
3  
Amc

SURVEY NARRATIVE TO COMPLY WITH PARAGRAPH 209.250  
 OREGON REVISED STATUTES

Survey for: Darrell L. Rose  
 2183 Coastland Avenue  
 San Jose, California 95125

Survey by : Charles H. Hurst  
 304 South Holly  
 Medford, Oregon 97501

Bearings : Based on the west line of the NW 1/4 of Section 15 as  
 determined by Survey No. 7308

Purpose : To designate a portion of the north line of the SW 1/4 of  
 the NW 1/4 of Section 15 as shown on the attached plat.

Procedure

The client did not desire any attempt to locate the centerline of Antelope Road or tie to existing road P.I.'s recently set by the Jackson County Road Department.

Coordinate control previously established during the course of Survey No. 7810 was utilized in extension of a line to a point near the N 1/16 corner from which point the corner was set.

A line monument (5/8" iron pin) was set on the east fill slope of Antelope Road approximately 5 feet below subgrade elevation and on the westerly projection of a fence line running East from the fill catchpoint.

The client accepts that the computed subdivisional lines of Section 15 are in part based on a Bureau of Land Management administrative survey which has not been entered into the public record and that this survey does not necessarily constitute an endorsement thereof, or an acceptance of liability therefor.

March 5, 1982

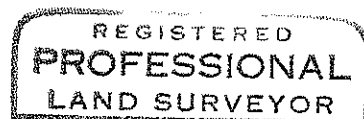
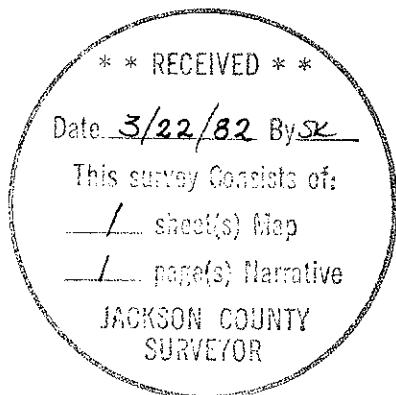

*Charles H. Hurst*

