

MAP OF SURVEY

FOR

"VIRGIL LAVELLE HENRY"

LOCATED IN

Block 18 of Dekum's Amended Add.
T.36S., R.3W., WM., City of Gold Hill,
Jackson County, Oregon

HOFFBUHR/BATH&ASSOCIATES, INC.
Medford, Oregon December 30, 1981
By: Douglas C. McMahan P.L.S. 1913
Scale: 1" = 100' Basis of Bearing Survey No. 3458

- = Found 3/4" Iron Pin in concrete per survey no. 3458
- = Set 5/8" X 24" Iron Pin/yellow plastic caps
"D. McMahan L.S. 1913"
- ⊞ = Set "PK" nail

** RECEIVED **

Date 2/4/82 By SK

This survey Consists of:

1 sheet(s) Map

1 page(s) Narrative

JACKSON COUNTY
SURVEYOR

REGISTERED
PROFESSIONAL
LAND SURVEYOR

Douglas C. McMahan

OREGON
JULY 18, 1980
DOUGLAS C. McMAHAN
No. 1913

SURVEY NO. 9183

SURVEY NARRATIVE TO COMPLY WITH PARAGRAPH 209.250
OREGON REVISED STATUTES

SURVEY FOR: Virgil Lavelle Henry
494 8th Street
Gold Hill, Oregon

LOCATION: Lot 1 and Lot 2 Block 18 of Dekum's Amended Add.
to the City of Gold Hill, T.36 S., R.3 W., W.M.,
Jackson County, Oregon

PURPOSE: To survey and monument the south 50 feet of lot 1 and lot 2
as shown on the attached map of survey.

PROCEDURE: Using monuments found per survey no. 3458, I measured angles
and distances to determine the location of the south 50 feet
of lot 1 and lot 2 of block 18. I set monuments as shown on
the attached map of survey.

Basis of Control-----Survey No. 3458

December 30, 1981

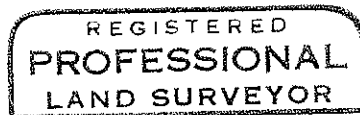

Douglas C. McMahan

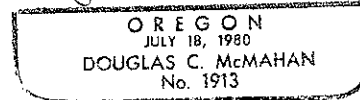

Douglas C. McMahan
Hoffbuhr/Bath & Associates, Inc.
219 North Oakdale
Medford, Oregon

See attached map of survey

