



SURVEY NO. 9179

SURVEY NARRATIVE TO COMPLY WITH PARAGRAPH 209,250, OREGON REVISED STATUTES

SURVEY FOR: H. J. Stephens  
419 Oak Street  
Rogue River, Oregon

LOCATION: City of Rogue River. SW 1/4 Section 15, T.36S., R.4W., W.M.  
Jackson County, Oregon.

PURPOSE: Minor Land Partition. To locate and monument the property  
corners of Parcels 1 and 2 as shown on the accompanying  
plat.

PROCEDURE: I found the monuments referenced in RS 6787 as shown. I  
traversed around Block 1 and agreed with RS 6787 quite  
closely. I then proportioned the lot lines and set 5/8" x  
30" steel pins with plastic caps at the corners of Parcels  
1 and 2 as shown on the accompanying plat.

EQUIPMENT: Lietz TM20C Theodolite, Lietz Red-1 EDM and 200' steel tape.

BASIS OF BEARINGS: RS 6787

DATE COMPLETED: January 25, 1982

Darrel W. Edwards  
P.O. Box. 801 - 98 Pine  
Rogue River, Oregon

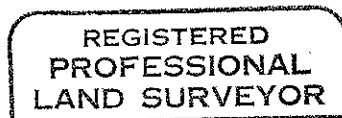
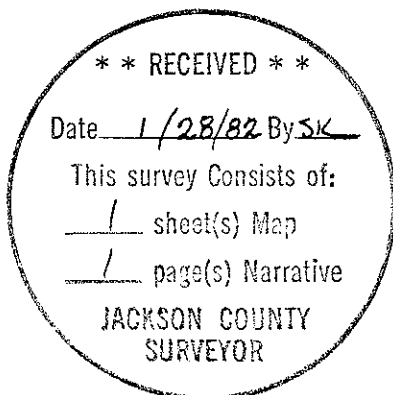

*Darrel W. Edwards*

