

**MAP OF SURVEY**  
 LOCATED IN  
 WEST 1/2 of the WEST 1/2 of SEC. 24  
 T. 38 S., R. 3 E., W.M.  
 JACKSON COUNTY, OREGON  
 FOR  
**"VANE HOAGE"**  
 HOFFBUHR/ BATH & ASSOCIATES, INC.  
 MEDFORD, OREGON  
 BY: DOUGLAS C. McMAHAN R.P.L.S. NO. 1913  
 SCALE: 1" = 200' DEC. 14, 1981  
 BASIS OF BEARING SURVEY No. 8957

- = FOUND 5/8" IRON PIN PER SURVEY NO. 8957
- = SET 5/8" X 24" IRON PIN WITH YELLOW PLASTIC CAPS ("D. McMAHAN L.S. 1913")

REGISTERED  
**PROFESSIONAL**  
 LAND SURVEYOR

*Douglas C. McMahon*  
 OREGON  
 DCA # 1913  
 No. 1913



SURVEY NO. 9131

SURVEY NARRATIVE TO COMPLY WITH PARAGRAPH 209.250  
OREGON REVISED STATUTES

SURVEY FOR Vane Hoage  
2799 Siskiyou Blvd.  
Ashland, Oregon 97520

LOCATION: West one-half (1/2) of the West one-half (1/2)  
of Section 24, Township 38 South, Range 3 East,  
Willamette Meridian, Jackson County, Oregon

PURPOSE: To survey and monument the parcels per client's  
request, as shown on the attached map of survey

PROCEDURE: Using the monumentation previously established  
by this office as shown on Survey No. 8957, and descriptions  
furnished by client, I determined the property lines by propor-  
tionate means and monumented the parcels as shown on the attached  
map of survey.

Basis of bearing: Survey No. 8957

December 14, 1981

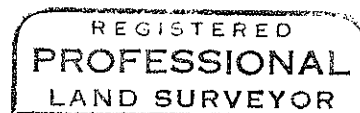
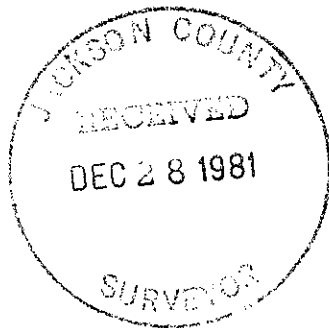

*Douglas C. McMahan*

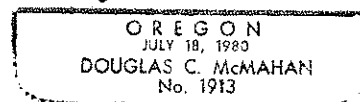

Douglas C. McMahan  
Hoffbuhr/Bath & Associates, Inc.  
219 North Oakdale  
Medford, Oregon 97501

See attached map of survey