

MAP OF SURVEY
 LOCATED IN
 S.E. 1/4 of SEC. 16, T. 34 S., R. 1W., W.M.
 CITY OF SHADY COVE
 JACKSON COUNTY, OREGON
 FOR
REAL ESTATE LOAN FUND OF OREGON

HOFFBUHR / BATH & ASSOCIATES, INC.
 219 NORTH OAKDALE
 MEDFORD, OREGON

BY: ROGER R. ROBERTS R.P.L.S. NO. 1656
 SCALE: 1" = 50' OCTOBER 23, 1981
 BASIS OF BEARING SURVEY NO. 4679

(81-042)

- LEGEND**
- ⌘ --- FD. 5/8" I. PIN P.I.
 - △ --- FD. RAILROAD SPIKE
 - --- SET 5/8" x 24" I. PINS W/CAPS
 - D.R. --- DEED RECORD

JACKSON COUNTY
 RECEIVED
 NOV 06 1981
 SURVEYOR

REGISTERED
PROFESSIONAL
 LAND SURVEYOR
Roger R. Roberts
 OREGON
 JULY 14, 1978
 ROGER R. ROBERTS
 1656

SURVEY NO. 9072

SURVEY NARRATIVE TO COMPLY WITH PARAGRAPH 209.250
OREGON REVISED STATUTES

SURVEY FOR: Real Estate Loan Fund of Oregon, Ltd.
2613 12th Street S.E.
Salem, Oregon 97302

LOCATION: Southeast one-quarter (1/4) of Section 16,
Township 34 South, Range 1 West, Willamette
Meridian, City of Shady Cove, Jackson County,
Oregon

PURPOSE: Survey and monument the parent tract and divide
into 3 parcels as requested

PROCEDURE: The existing monumentation found as shown on the
attached map was tied together by electronic distance meter traverse.
The Southwesterly boundary was determined by record angles from
senior deeds, as shown on Survey No. 4679. The Southeasterly and
Northeasterly boundaries were also determined by record angles and
distances as described in Jackson County Instrument No. 79-14704.

The boundary of a 40 foot strip deeded to Jackson County by
deed recorded in Volume 106, page 344 was determined by using record
angles and distances from the East one-quarter (1/4) corner of Sec-
tion 16. This created an overlap onto the parent tract. Additional
research indicated that the deed conveying the 40 foot strip would
be senior over the later parcel description. Therefore this overlap
was monumented as being the boundary of the tract being surveyed.

Basis of Bearing: Survey No. 4679

October 23, 1981

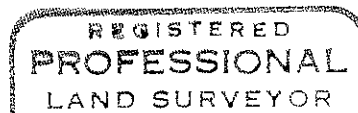

Roger R. Roberts

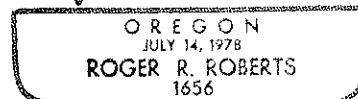

Roger R. Roberts
Hoffbuhr/Bath & Associates, Inc.
219 North Oakdale
Medford, Oregon 97501

