

9034

①

FOUND MONUMENT REFERENCES:

- 13" DIA. FIR, S 65°46' W, 66.00 ft.
- 21" DIA. FIR, N 29°29' W, 55.55 ft.
- 16" DIA. FIR, N 78°41' E, 68.10 ft.
- 19" DIA. FIR STUMP, S 48°12' E, 37.50 ft.
- 17" DIA. FIR SNAG, DEAD AND DOWN,
N 43°53' E, 5.30 ft.

NEW REFERENCE:

- 24" DIA. FIR, S 48°27' E, 62.25 ft.
SCRIBED T 36 S R 3 E S 17 LS 1071 BT

LEGEND

- FOUND STANDARD BLM SURVEY MONUMENT
SET 2 1/2" DIA. X 30" LG. GALVANIZED IRON
POST WITH 2 1/2" DIA. BRASS CAP
- PROPERTY LINE ESTABLISHED AND POSTED
THIS SURVEY

MAP OF SURVEY
FOR
ROGUE RIVER NATIONAL FOREST

LOCATED IN
Sections 8 and 17
T. 36 S., R. 3 E., W.M.
JACKSON COUNTY, OREGON
AUGUST 31, 1981

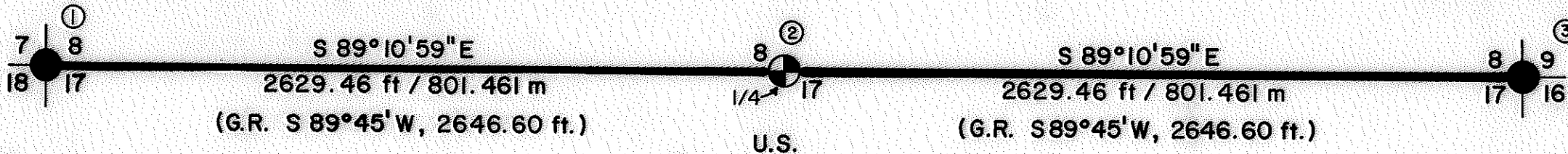

②

SET MONUMENT WITH BRASS CAP MARKED:

T 36 S R 3 E
1/4 — S 8
S 17
LS 1071
1981

REFERENCES:

- 18" DIA. FIR, N 64°35' W, 22.70 ft.
SCRIBED 1/4 S 8 LS 1071 BT
- 23" DIA. FIR, S 59°58' W, 19.00 ft.
SCRIBED 1/4 S 17 LS 1071 BT

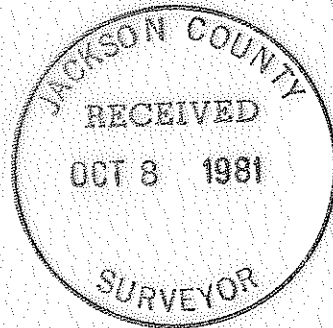

③

FOUND MONUMENT REFERENCES:

- 22" DIA. FIR, S 10°09' W, 63.26 ft.
- 20" DIA. FIR SNAG, N 44°55' W, 12.80 ft.
- 23" DIA. FIR, N 15°09' W, 21.70 ft.
- 12" DIA. FIR, N 39°23' E, 27.30 ft.
- 10" DIA. FIR SNAG, S 19°29' E, 26.39 ft.

NEW REFERENCE:

- 9" DIA. FIR, S 77°18' E, 38.51 ft.
SCRIBED T 36 S R 3 E S 16 LS 1071 BT

BASIS OF BEARING:
SOLAR OBSERVATION

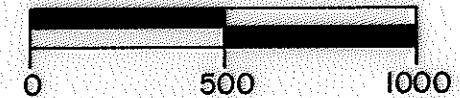

SCALE IN FEET

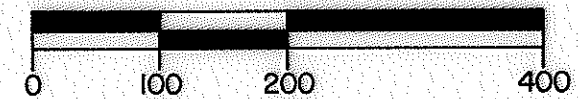

SCALE IN METERS

1 METER = 3.280833 FEET



CERTIFICATE OF SURVEY

I, HAROLD L. CENTER, REGISTRATION NO. 1071,
REGISTERED PROFESSIONAL LAND SURVEYOR, STATE OF
OREGON, HEREBY CERTIFY THAT THIS MAP CORRECTLY
REPRESENTS A SURVEY MADE BY ME OR UNDER MY
DIRECTION, IN CONFORMANCE WITH THE LAWS OF THE
STATE OF OREGON, AT THE REQUEST OF THE U.S.
FOREST SERVICE.

REGISTERED
PROFESSIONAL
LAND SURVEYOR

Harold L. Center
OREGON
HAROLD L. CENTER
JULY 30, 1976
No. 1071

9034

U.S. DEPT. OF AGRICULTURE
FOREST SERVICE

REGION 6

ROGUE RIVER NAT'L FOREST

REVIEWED BY *John E. Keary*

DATE 10-8-81

REVIEWED BY *D. M. ...*

DATE 10/7/81

From which the following references:

An 18-inch diameter fir bears N 64°35'W, 22.70 feet distance,
scribed "¼ S8 LS1071 BT".

A 23-inch diameter fir bears S 59°58' W, 19.00 feet distance,
scribed "¼ S17 LS1071 BT".

August 31, 1981

Harold L. Center

Registered Professional Land Surveyor
Oregon Certificate No. 1071

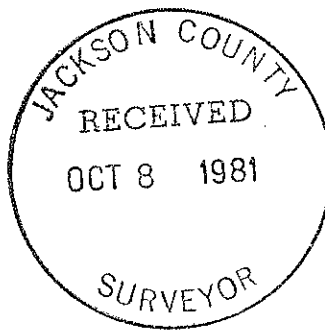
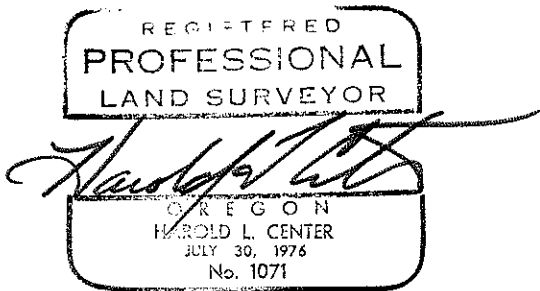

A 17-inch diameter fir snag, dead and down, stump hole of which bears N 43°53' E, 5.30 feet distance.

New reference:

A 24-inch diameter fir bears S 48°27' E, 62.25 feet distance, scribed "T36S R3E S17 LS1071 BT".

Section corner common to Sections 8, 9, 16, and 17, Township 36 South, Range 3 East.

At the corner point I found a standard Bureau of Land Management monument marked:

U.S. Dept. of Interior
Unlawful to Disturb

T36S R3E

S8	S9
S17	S16
1962	

Cadastral Surveys
Bureau of Land Management

From which the following references:

A 22-inch diameter fir bears S 10°09' W, 63.26 feet distance, with single healed blaze.

A 20-inch diameter fir snag bears N 44°55' W, 12.80 feet distance, with scribe marks "S8" visible on open blaze.

A 23-inch diameter fir bears N 15°09' W, 21.70 feet distance, with single healed blaze.

A 12-inch diameter fir bears N 39°23' E, 27.30 feet distance, with single healed blaze.

A 10-inch diameter fir snag bears S 19°29' E, 26.39 feet distance, with single healed blaze.

New reference:

A 9-inch diameter fir bears S 77°18' E, 38.51 feet distance, scribed "T36S R3E S16 LS1071 BT".

Corners Established This Survey

One-quarter corner common to Sections 8 and 17, Township 36 South, Range 3 East.

At the corner point I set a 2½-inch diameter by 30-inch long galvanized iron post with a 2½-inch diameter brass cap marked:

T36S R3E

S8
¼ —————
S17
LS1071
1981

SURVEY NARRATIVE TO COMPLY WITH
PARAGRAPH 209.250 OREGON REVISED STATUTES

SURVEY FOR: Rogue River National Forest
P.O. Box 520
Medford, Oregon 97501

LOCATION: Sections 8 and 17, Township 36 South, Range 3 East,
Willamette Meridian, Jackson County, Oregon.

BASIS OF BEARING: Solar observation

PURPOSE: To reestablish the one-quarter corner common to
Sections 8 and 17, Township 36 South, Range 3 East,
and to mark and post the property line between said
Sections 8 and 17.

PROCEDURE: I performed a closed traverse tying the controlling
sections corners; from this data search areas were
determined for the missing one-quarter corner. A
thorough search for the one-quarter corner was made
without success. I therefore reestablish this corner
at the proportion position as shown on the attached
map of survey.

This survey was performed utilizing a Wild T-2
theodolite and a Hewlett Packard 3808 electronic
distance meter.

Corners Accepted for Control

Section corner common to Sections 7, 8, 17, and 18, Township 36 South,
Range 3 East.

At the corner point I found a standard Bureau of Land Management monument
marked:

U.S. Dept. of Interior
Unlawful to Disturb

T36S R3E

S7	S8
S18	S17

1966

Cadastral Surveys
Bureau of Land Management

From which the following references:

A 13-inch diameter fir bears S 65°46' W, 66.00 feet distance,
with scribe marks "BT" visible on partially healed single blaze.

A 21-inch diameter fir bears N 29°29' W, 55.55 feet distance,
with single healed blaze.

A 16-inch diameter fir bears N 78°41' E, 68.10 feet distance,
with single healed blaze.

A 19-inch diameter fir stump bears S 48°12' E, 37.50 feet distance,
with scribe marks "36S R3E S" visible on partially healed blaze.