

MAP OF SURVEY
 LOCATED IN
 N.W. 1/4 of SEC. 20, T.32S., R.3E., W.M.
 JACKSON COUNTY, OREGON
 FOR
CHESTER DANGREMOND
 HOFFBUHR / BATH & ASSOCIATES, INC.
 MEDFORD, OREGON

BY: RICHARD L. BATH R.R.L.S. NO. 1069
 SCALE: 1" = 100' AUGUST 18, 1981
 BASIS OF BEARING SOLAR OBSERVATION

- ⊙ = Set 5/8" x 24" Iron Pin
tagged "R. BATH L.S. 1069"
- = Fd. 3/4" Iron Pipe exp. 1 1/2'
tied in top of pipe.
Pipes reported set by Pete Mundy

S/N = Survey No.
 comp. = Computed Bearing/Distance

REGISTERED
PROFESSIONAL
LAND SURVEYOR
Richard L. Bath
 OREGON
 JULY 30, 1975
 RICHARD L. BATH
 No. 1069

JACKSON COUNTY
 RECEIVED
 AUG 26 1981
 SURVEYOR

SURVEY NO. 8981

SURVEY NARRATIVE TO COMPLY WITH PARAGRAPH 209.250
OREGON REVISED STATUTES

SURVEY FOR: Chester Dangremond
1925 Creekside Road
Santa Rosa, California 95405

LOCATION: Northwest one-quarter (1/4) of Section 20,
Township 32 South, Range 3 East, Willamette
Meridian, Jackson County, Oregon

PURPOSE: To survey and monument the South line of the tract
described in Document No. 73-12064 and to tie into
monuments reported set by Pete Mundy while doing a
timber survey

PROCEDURE: The South line of the subject tract is described
as follows: ". . . to a point which is 32.5 feet North 18° 30'
West, from the center of a 6 inch well casing; thence East, 719.0
feet, from said point; . . .". A solar observation was taken for
a basis of bearing which was verified with two control points set
by Harold Center, R.P.L.S. No. 1071, for U.S.F.S. control in the
immediate area. The South line of the subject tract was surveyed
per its legal description as shown. Coordinates of the West one-
sixteenth (1/16) corner were supplied to me by Harold Center and
ties to the South line from the section line are computed values
and not field measurements.

Basis of Bearing--Solar Observation

August 18, 1981

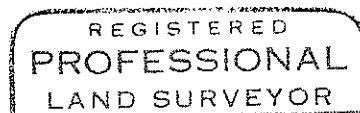
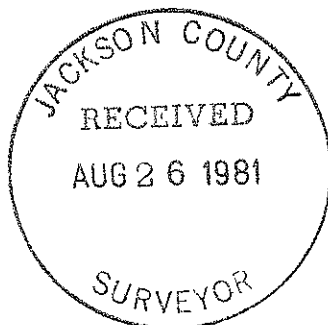

Richard L. Bath

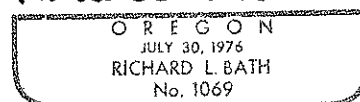

Richard L. Bath
Hoffbuhr/Bath & Associates, Inc.
219 North Oakdale
Medford, Oregon 97501