

# MINOR PARTITION

LOCATED IN THE  
SE 1/4 SEC. 29, T. 32S., R. 3E., W.M.  
JACKSON COUNTY, OREGON  
FRACTION OF LOT 4, BLOCK D, PROSPECT TRACTS

JULY 20, 1981  
SCALE 1" = 60'

**SURVEY FOR**  
Gregg Adams  
2120 Oakwood Drive  
Medford, Oregon

**SURVEY BY**  
Edwards Surveying  
98 Pine - P.O. Box 801  
Rogue River, Oregon  
Telephone 582-3110

**APPROVAL**  
Approved by the Jackson County Planning Commission  
By Rachel B. Adams  
Date 7/23/81

**RECORDER'S CERTIFICATE**  
Filed for record this 16th day of August,  
1981, at 4:05 o'clock p.m. in Volume 4,  
Page 50 of "Minor Land Partitions" in Jackson  
County, Oregon.

Waldene Terry  
County Clerk  
Pauline M. Carmack  
Deputy

**LEGEND**  
• Monument Found as noted  
○ 5/8" x 30" Steel Pin Set  
( ) Record Measurement  
X-X-X Fence

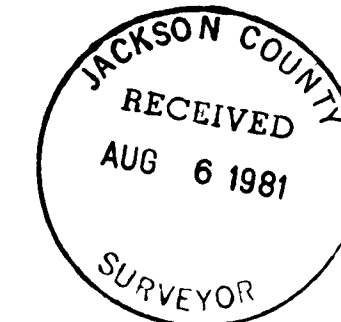

I certify this plat to be an exact photocopy of the original.  
Daniel W. Edwards  
SURVEYOR

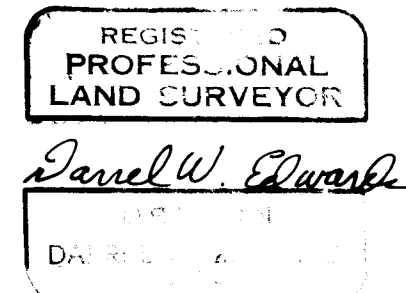

**NOTE:**  
This property at the time this partition was approved had not been shown to be suitable for development and will require at a minimum the provision of a potable water supply prior to the issuance of building or mobile home set-up permits by the Jackson County Department of Planning and Development.

SURVEY NO. 8942

SURVEY NARRATIVE TO COMPLY WITH PARAGRAPH 209.250, OREGON REVISED STATUTES

SURVEY FOR: Gregg Adams  
2120 Oakwood Drive  
Medford, OR 97501

LOCATION: SE 1/4 Sec. 29, T. 32S., R. 3E., W.M., in Jackson County, Oregon.

PURPOSE: Minor Land Partition. To locate and monument the property boundaries of Parcels 1, 2 and 3 as shown on the accompanying plat.

PROCEDURE: Found necessary control monuments in Block D of Prospect Tracts. Set 5/8 inch by 30 inch steel pins as shown on accompanying plat.

EQUIPMENT: Lietz TM-200 Theodolite and Lietz Red-1 EDM.

BASIS OF  
HEARINGS: Recorded plat of Prospect Tracts.

DATE COMPLETED: July 20, 1981

Edwards Surveying  
P. O. Box 801  
Rogue River, OR 97537  
Telephone 582-3110

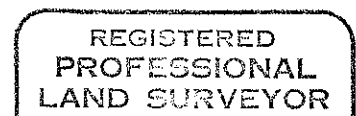
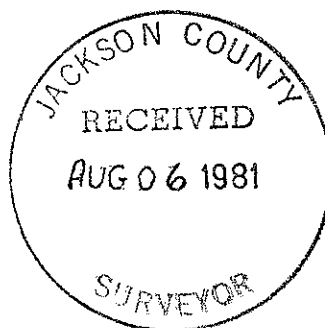

*Darrel W. Edwards*

