

MAP OF SURVEY
 LOCATED IN
SEC. 13, T. 40 S., R. 3 W., W.M.
 AND
SEC. 18, T. 40 S., R. 2 W., W.M.
JACKSON COUNTY, OREGON

FOR
ROGUE RIVER NATIONAL FOREST
 JULY 16, 1981

BASIS OF BEARING—SOLAR OBSERVATION

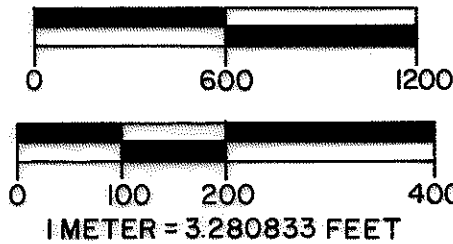

LEGEND

- FOUND STANDARD BLM MONUMENT
- ⊙ SET 2 1/2" DIA. X 30" LG. IRON POST WITH 2 1/2" DIA. BRASS CAP
- PROPERTY LINE ESTABLISHED AND POSTED THIS SURVEY

① FOUND MONUMENT REFERENCES:

- 22" DIA. DOUGLAS FIR N 37°10' E 26.1 ft
- 16" DIA. DOUGLAS FIR S 36°21' E 5.7 ft
- 12" DIA. DOUGLAS FIR S 26°12' E 3.2 ft
- 5" DIA. LIVE OAK S 50°57' W 16.2 ft
- 15" DIA. DOUGLAS FIR S 56°28' W 35.9 ft
- 22" DIA. DOUGLAS FIR N 83°14' W 32.2 ft

② SET MONUMENT MARKED:

T40 S.
 1/4
 R3W | R2W
 S13 | S18
 1981
 LS 1071

REFERENCES:

- 7" DIA. DOUGLAS FIR N 42°35' W 72.1 ft
 SCRIBED 1/4 S13 LS 1071 BT
- 8" DIA. DOUGLAS FIR S 42°26' E 15.7 ft
 SCRIBED 1/4 S18 LS 1071 BT

③ FOUND MONUMENT REFERENCES:

- 21" DIA. PONDEROSA PINE N 40°28' W 7.0 ft
- UNDETERMINED SIZE SAWED PINE STUMP N 69°02' E 26.9 ft
- 6" DIA. DOUGLAS FIR S 81°46' E 40.12 ft
- 10" DIA. PONDEROSA PINE S 18°31' E 35.3 ft
- 23" DIA. PONDEROSA PINE S 13°04' W 9.2 ft

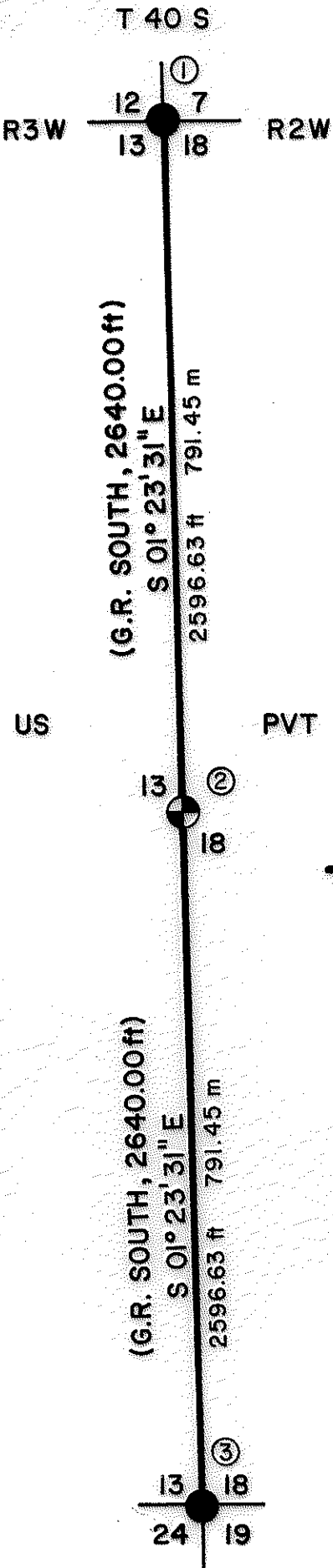
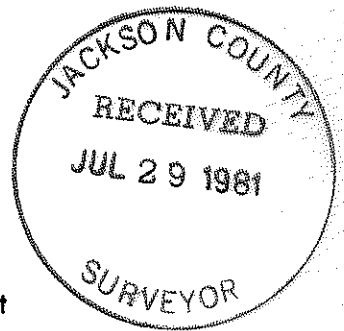

**REGISTERED
 PROFESSIONAL
 LAND SURVEYOR**

Harold L. Center
OREGON
 MAY 20, 1975
HAROLD L. CENTER
 No. 1071

U.S. DEPARTMENT OF AGRICULTURE
FOREST SERVICE

REGION 6 ROGUE RIVER NAT'L FOREST

REVIEWED BY *D. L. McNeal* DATE 7/27/81

REVIEWED BY *R. J. Hathaway* DATE 7/27/81

Section corner common to Sections 13 and 24, Township 40 South, Range 3 West, and Sections 18 and 19, Township 40 South, Range 2 West, Willamette Meridian.

At the corner point I found a standard Bureau of Land Management monument marked:

U.S. Dept. of the Interior
 Unlawful to Disturb
 T40S

R3W	R2W
S13	S18
S24	S19

 1975
 Cadastral Surveys
 Bureau of Land Management

From which the following references:

A sawed pine stump, diameter indeterminate, bears N69°02'E, 26.9 feet distance with scribe marks "OS R2W S18 BT" visible on open, decayed face.

A 10 inch diameter Ponderosa pine bears S18°31'E, 35.3 feet distance, with scribe marks "OS R2W S19" visible on open blaze.

A 6 inch diameter Douglas fir bears S81°46'E, 40.12 feet distance, with illegible scribe marks visible on partially healed blaze.

A 23 inch diameter Ponderosa pine bears S13°04'W, 9.2 feet distance, with illegible scribe marks visible on open face.

A 21 inch diameter Ponderosa pine bears N40°28'W, 7.0 feet distance, with burnt face; no marks visible.

Corners Established by this Survey

One-quarter corner common to Section 13, Township 40 South, Range 3 West, and Section 18, Township 40 South, Range 2 West.

At the corner point I set a 2½ inch diameter by 30 inch long galvanized iron post with a 2½ inch diameter brass cap marked:

T40S

R3W ¼	R2W
S13	S18

 1981
 L.S.1071

From which the following references:

A 7 inch diameter Douglas fir bears N42°35'W, 72.1 feet distance; marked "¼ S13 LS1071 BT".

An 8 inch diameter Douglas fir bears S42°26'E, 15.7 feet distance; marked "¼ S18 LS1071 BT".

July 16, 1981

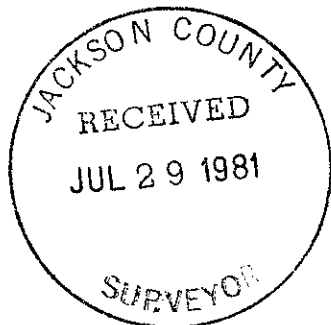

HAROLD L. CENTER
 Registered Professional Land Surveyor
 Oregon Certificate, No. 1071



SURVEY NARRATIVE TO COMPLY WITH
PARAGRAPH 209.250 OREGON REVISED STATUTES

SURVEY FOR: Rogue River National Forest
P.O. Box 520
Medford, Oregon

LOCATION: Section 13, Township 40 South, Range 3 West, and
Section 18, Township 40 South, Range 2 West,
Willamette Meridian, Jackson County, Oregon.

BASIS OF BEARING: Solar Observation

PURPOSE: To mark and post property line between Section 13,
Township 40 South, Range 3 West, and Section 18,
Township 40 South, Range 2 West, and to reestablish
the one-quarter corner common to said Sections
13 and 18.

PROCEDURE: Performed a closed traverse tying controlling
section corners; from this data search areas
were determined for the one-quarter corner. A
thorough search for the one-quarter corner was
made without success. I therefore reestablish
this corner at proportion position as shown on
attached map of survey.

This survey was performed utilizing a Wild T-2
Theodolite and Hewlett Packard 3808A electronic
distance meter.

Corners Accepted for Control

Section corner common to Section 12 and 13, Township 40 South, Range 3 West, and Section 7 and 18, Township 40 South, Range 2 West, Willamette Meridian.

At the corner point I found a standard Bureau of Land Management monument marked:

U.S. Dept. of the Interior
Unlawful to Disturb

T40S	
R2W	
S12	S7
S13	S18
1964	

Cadastral Surveys
Bureau of Land Management

From which the following references:

A 22 inch diameter Douglas fir bears N37°10'E, 26.1 feet distance, with healed blaze.

A 16 inch diameter Douglas fir bears S36°21'E, 5.7 feet distance, with healed blaze.

A 12 inch diameter Douglas fir bears S26°12'E, 3.2 feet distance, with healed blaze.

A 5 inch live oak bears S50°57'W, 16.2 feet distance, with scribe marks "CS" visible on partially healed blaze.

A 15 inch diameter Douglas fir bears S56°28'W, 35.9 feet distance, with healed blaze.

A 22 inch diameter Douglas fir bears N83°14'W, 32.2 feet distance, with healed blaze.