

BASIS OF BEARINGS
R.S. 3313

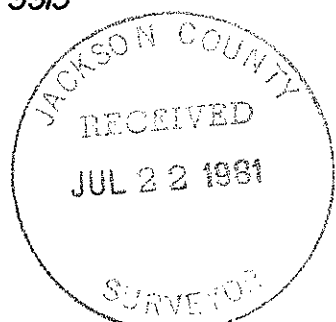

SURVEY FOR: Tom and Billie Rodman	
Portion Lot 9, Riverdale Tracts, NE 1/4 Sec. 21,	
LOCATION: T. 36S., R. 4W., W.M., Jackson County, Oregon	
DATE: July 7, 1981	REGISTERED PROFESSIONAL LAND SURVEYOR
SCALE: 1" = 100"	
● Monument found	Darrel W. Edwards
○ 5/8" x 30" Steel Pin Set	
() Record Measurement	
OREGON JULY 6, 1966 DARREL W. EDWARDS 741	

SURVEY NO. 8921

SURVEY NARRATIVE TO COMPLY WITH PARAGRAPH 209.250, OREGON REVISED STATUTES

SURVEY FOR: Tom and Bill Rodman
8850 Rogue River Highway
Grants Pass, Oregon

LOCATION: Portion Lot 9, Riverdale Tracts, NE 1/4 Sec. 21, T. 36S.,
R. 1W., W.M., Jackson County, Oregon.

PURPOSE: To locate and monument the two Rodman parcels as shown on
the accompanying plat.

PROCEDURE: I found the monuments as shown. Using said monuments and
Deed Records, I set 5/8" x 30" steel pins and a railroad
spike as shown on the accompanying plat.

EQUIPMENT: Zeiss TH 43 Theodolite and 300' steel tape.

BASIS OF
BEARINGS: R. S. 3313

DATE COMPLETED: July 7, 1981

Edwards Surveying
P. O. Box 801
Rogue River, OY 97537
Telephone 582-3110

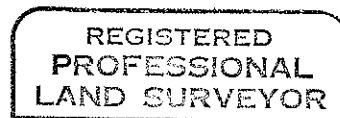
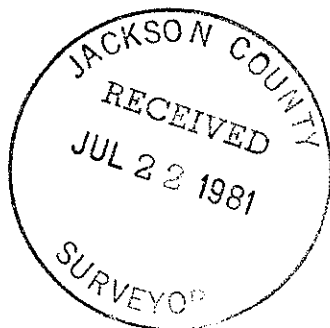

Darrel W. Edwards

