

MAP OF SURVEY
FOR
ROGUE RIVER NATIONAL FOREST
 P.O. BOX 520
 MEDFORD, OREGON
 MARCH 16, 1981

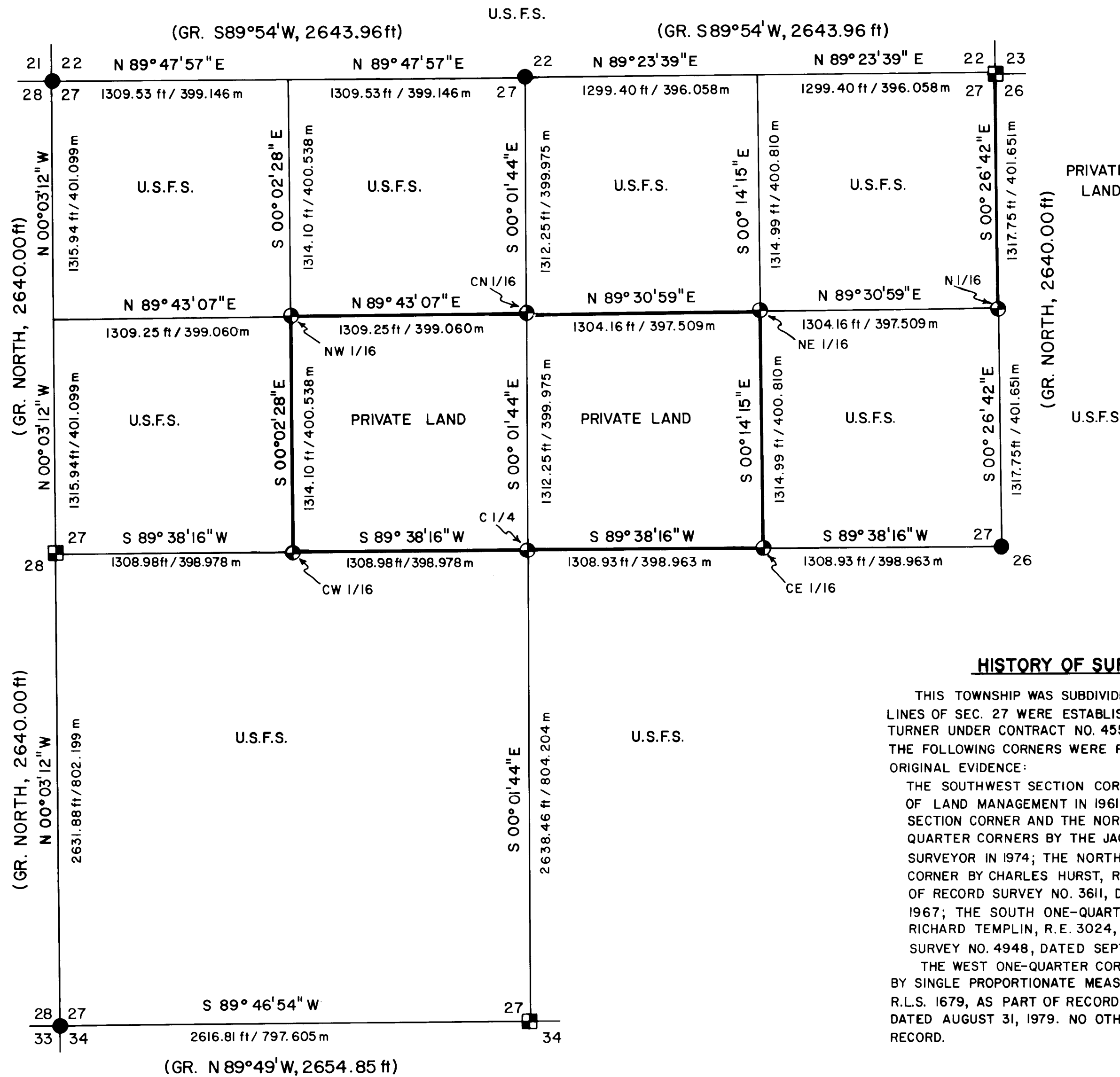

HISTORY OF SURVEY

THIS TOWNSHIP WAS SUBDIVIDED AND THE EXTERIOR LINES OF SEC. 27 WERE ESTABLISHED BY WILLIAM TURNER UNDER CONTRACT NO. 455, DATED JULY 17, 1882. THE FOLLOWING CORNERS WERE REMONUMENTED FROM ORIGINAL EVIDENCE:

THE SOUTHWEST SECTION CORNER BY THE BUREAU OF LAND MANAGEMENT IN 1961; THE NORTHWEST SECTION CORNER AND THE NORTH AND EAST ONE-QUARTER CORNERS BY THE JACKSON COUNTY SURVEYOR IN 1974; THE NORTHEAST SECTION CORNER BY CHARLES HURST, R.L.S. 483, AS PART OF RECORD SURVEY NO. 3611, DATED DECEMBER 20, 1967; THE SOUTH ONE-QUARTER CORNER BY RICHARD TEMPLIN, R.E. 3024, AS PART OF RECORD SURVEY NO. 4948, DATED SEPTEMBER 28, 1971.

THE WEST ONE-QUARTER CORNER WAS ESTABLISHED BY SINGLE PROPORTIONATE MEASURE BY KURT WEAVER, R.L.S. 1679, AS PART OF RECORD SURVEY NO. 7968, DATED AUGUST 31, 1979. NO OTHER SURVEYS ARE OF RECORD.

BASIS OF BEARING - SOLAR OBSERVATION

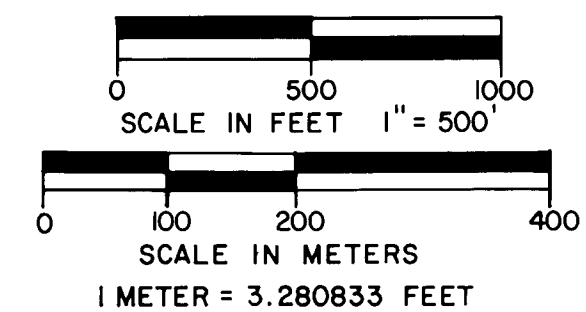

LEGEND

- FOUND STANDARD BLM OR COUNTY SURVEYOR MONUMENT
- FOUND PRIVATE SURVEYOR MONUMENTS - R.L.S. 483; R.E. 3024; AND R.L.S. 1679.
- ⊙ SET 2 1/2" DIA X 30" LG IRON POST WITH 2 1/2" DIA BRASS CAP UNLESS OTHERWISE NOTED
- GR GOVERNMENT RECORD
- PROPERTY LINE ESTABLISHED AND POSTED THIS SURVEY
- SECTION LINE CALCULATED FROM TRAVERSE SURVEY

CERTIFICATE OF SURVEY

I, HAROLD CENTER, REGISTRATION NO. 1071, REGISTERED PROFESSIONAL LAND SURVEYOR, STATE OF OREGON, HEREBY CERTIFY THAT THIS MAP CORRECTLY REPRESENTS A SURVEY MADE BY ME OR UNDER MY DIRECTION, IN CONFORMANCE WITH THE LAWS OF THE STATE OF OREGON, AT THE REQUEST OF THE U.S. FOREST SERVICE.

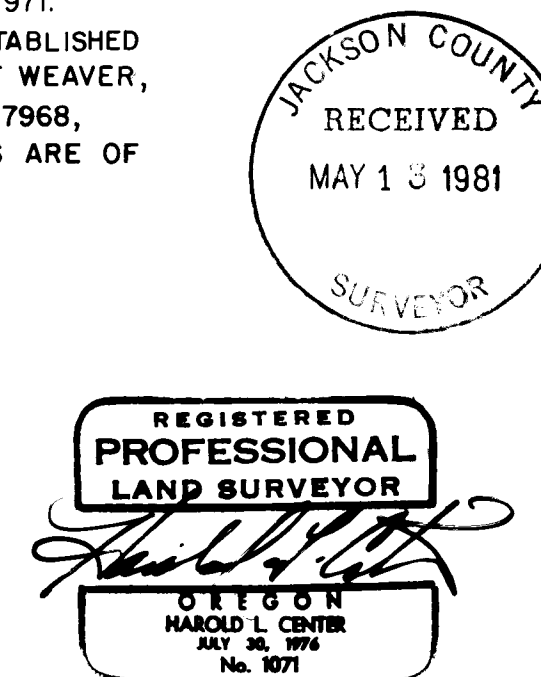

U.S. DEPT. OF AGRICULTURE FOREST SERVICE REGION 6 ROGUE RIVER NAT'L FOREST	
DEPENDENT RESURVEY AND SECTION SUBDIVISION SEC. 27, T. 37 S., R 3 E, W.M. JACKSON COUNTY, OREGON	
REVIEWED BY <i>[Signature]</i>	DATE 5/8/81
REVIEWED BY <i>[Signature]</i>	DATE 5/8/81

A Douglas-fir 17-inches in diameter bears S 06° 26' E 14.30 feet distance. Scribed "C 1/4 S27 LS 1071 BT".

Center-West one-sixteenth corner of Section 27, Township 37 South, Range 3 East, Willamette Meridian.

At the corner point I set a 2 1/2-inch diameter galvanized iron post with a 2 1/2-inch diameter brass cap marked:

T37S R3E
W 1/16

C —•— C

S27
LS 1071
1981

From which the following references:

A fir 15-inches in diameter bears S 36° 54' E 25.30 feet distance. Scribed "CW 1/16 S27 LS 1071 BT".

A fir 12-inches in diameter bears N 85° 38' E 16.80 feet distance. Scribed "CW 1/16 S27 LS 1071 BT".

North one-sixteenth corner common to Sections 26 and 27, Township 37 South, Range 3 East, Willamette Meridian.

At the corner point I set a 2 1/2-inch diameter galvanized iron post with a 2 1/2-inch diameter brass cap marked:

T37S R3E
N 1/16
S27 • S26
LS 1071
1981

From which the following references:

A pine 20-inches in diameter bears N 39° 09' E 41.90 feet distance. Scribed N 1/16 S26 LS 1071 BT".

A Douglas-fir 13-inches in diameter bears N 69° 43' W 30.60 feet distance. Scribed "N 1/16 S27 LS 1071 BT".

March 16, 1981

HAROLD L. CENTER
Registered Professional Land Surveyor
Oregon Certificate No. 1071

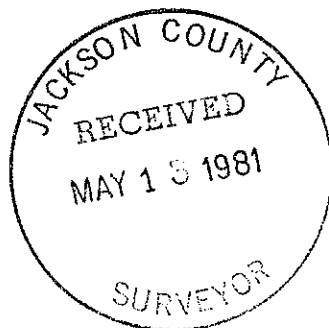

A Douglas-fir 8-inches in diameter bears N 71° 18' W 19.20 feet distance. Scribed "CN 1/16 S27 LS 1071 BT".

Northeast one-sixteenth corner of Section 27, Township 37 South, Range 3 East, Willamette Meridian.

At the corner point I set a 2½-inch diameter galvanized iron post with a 2½-inch diameter brass cap marked:

T37S R3E
NE 1/16
—+—
S27
LS 1071
1981

From which the following references:

A cedar 16-inches in diameter bears N 25° 07' E 37.70 feet distance. Scribed "NE 1/16 S27 LS 1071 BT".

A cedar 16-inches in diameter bears S 12° 37' E 39.20 feet distance. Scribed "NE 1/16 S27 LS 1071 BT".

Center-East one-sixteenth corner of Section 27, Township 37 South, Range 3 East, Willamette Meridian.

At the corner point I set a 2½-inch diameter galvanized iron post with a 2½-inch diameter brass cap marked:

T37S R3E
E 1/16
C—○—C
S27
LS 1071
1981

From which the following references:

A cedar 7-inches in diameter bears N 86° 26' E 18.90 feet distance. Scribed "CE 1/16 S27 LS 1071 BT".

A yew 19-inches in diameter bears S 27° 41' W 49.00 feet distance. Scribed "CE 1/16 S27 LS 1071 BT".

Center one-quarter corner of Section 27, Township 37 South, Range 3 East, Willamette Meridian.

At the corner point I set a 2½-inch diameter galvanized iron post with a 2½-inch diameter brass cap marked:

T37S R3E
C¼
—+—
S27
LS 1071
1981

From which the following references:

A Douglas-fir 17-inches in diameter bears S 88° 35' E 74.70 feet distance. Scribed "C ¼ S27 LS 1071 BT".

A fir 12-inches in diameter bears N 37° 03' E 20.60 feet distance.

A Douglas-fir 35-inches in diameter bears S 54° 39' E 43.00 feet distance.

One-quarter corner common to Sections 27 and 28, Township 37 South, Range 3 East.

At the corner point I found a 2½-inch diameter iron post with a 2½-inch diameter brass cap marked:

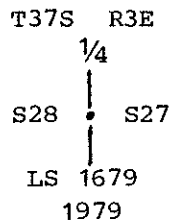

From which the following references:

A Douglas-fir 12-inches in diameter bears S 24° 41' E 27.60 feet distance.

A fir 10-inches in diameter bears N 80° 21' W 19.90 feet distance.

Corners Established This Survey

Northwest one-sixteenth corner of Section 27, Township 37 South, Range 3 East, Willamette Meridian.

At the corner point I set a 2½-inch diameter galvanized iron post with a 2½-inch diameter brass cap marked:

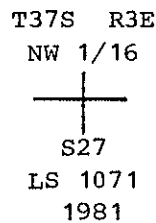

From which the following references:

A Douglas-fir 10-inches in diameter bears S 54° 23' W 6.50 feet distance. Scribed "NW 1/16 S27 LS 1071 BT".

A Douglas-fir 14-inches in diameter bears N 31° 57' E 10.60 feet distance. Scribed "NW 1/16 S27 LS 1071 BT".

Center-North one-sixteenth corner of Section 27, Township 37 South, Range 3 East, Willamette Meridian.

At the corner point I set a 2½-inch diameter galvanized iron post with a 2½-inch diameter brass cap marked:

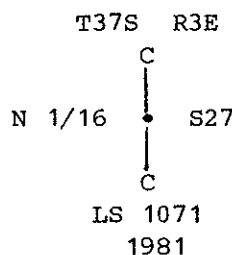

From which the following references:

A cedar 8-inches in diameter bears N 25° 30' E 7.60 feet distance. Scribed "CN 1/16 S27 LS 1071 BT".

At the corner point I found a standard Jackson County brass cap monument marked:

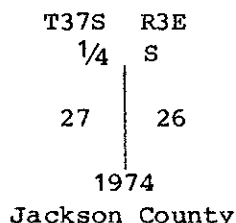

From which the following references:

- A fir 11-inches in diameter bears N 39° 39' E 47.90 feet distance.
- A fir snag 18-inches in diameter bears N 74° 58' E 17.90 feet distance.
- A dead and down Douglas-fir 26-inches in diameter bears S 73° 48' W 27.10 feet distance.

New reference:

- A fir 7-inches in diameter bears N 07° 24' W 52.50 feet distance.
Scribed "1/4 S27 LS 1071 BT".

One-quarter corner common to Sections 27 and 34, Township 37 South, Range 3 East.

At the corner point I found a 5/8-inch diameter iron pin with a 1 1/4-inch diameter plastic cap marked:

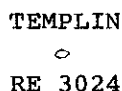

With original stone upside down along side. From which the following references:

- A Douglas-fir 24-inches in diameter bears S 12° 16' W 15.30 feet distance.
- A fir 39-inches in diameter bears N 40° 59' W 24.30 feet distance.

Section corner common to Sections 27, 28, 33 and 34, Township 37 South, Range 3 East.

At the corner point I found a standard Bureau of Land Management brass cap monument marked:

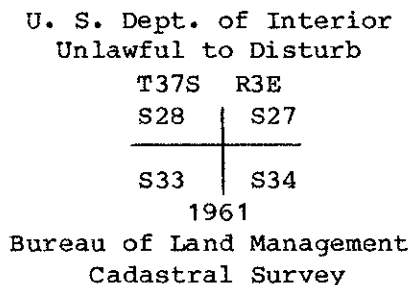

From which the following references:

- A fir 22-inches in diameter bears S 06° 00' W 5.00 feet distance.
- A fir stump 24-inches in diameter bears N 60° 49' W 6.80 feet distance.
- A fir 10-inches in diameter bears N 21° 12' W 12.90 feet distance.

From which the following references:

A cedar 36-inches in diameter bears N 53° 37' E 34.40 feet distance.

A Douglas-fir 8-inches in diameter bears N 86° 59' E 60.80 feet distance.

A Douglas-fir 13-inches in diameter bears S 47° 43' E 21.60 feet distance.

An oak 10-inches in diameter bears S 38° 21' W 12.60 feet distance.

A Douglas-fir 7-inches in diameter bears N 61° 58' W 5.10 feet distance.

One-quarter corner common to Sections 22 and 27, Township 37 South, Range 3 East.

At the corner point I found a standard Jackson County brass cap monument marked:

T37S R3E
 $\frac{1}{4}$ S $\frac{22}{27}$
CS
1974

From which the following references:

A cedar 13-inches in diameter bears S 28° 44' E 42.40 feet distance.

An oak 22-inches in diameter bears S 52° 59' W 13.30 feet distance.

A cedar 10-inches in diameter bears N 76° 21' W 32.20 feet distance.

A fir stump 8-inches in diameter bears N 68° 17' W 9.60 feet distance.

Section corner common to Sections 22, 23, 26 and 27, Township 37 South, Range 3 East.

At the corner point I found a 3/4-inch diameter iron pin with a 2 1/2-inch diameter brass cap marked:

T37S R3E
S22 | S23

S27 | S26
RS 483 1967

From which the following references:

A pine 45-inches in diameter bears N 32° 11' W 43.60 feet distance.

A Douglas-fir 20-inches in diameter bears N 58° 00' E 36.50 feet distance.

A Douglas-fir 14-inches in diameter bears S 66° 08' E 47.40 feet distance.

A pine 24-inches in diameter bears S 49° 23' W 29.30 feet distance.

One-quarter corner common to Sections 26 and 27, Township 37 South, Range 3 East.

NARRATIVE TO COMPLY WITH
 OREGON REVISED STATUTES PARAGRAPH 209.250

SURVEY FOR: Rogue River National Forest
 P. O. Box 520
 Medford, Oregon 97501

LOCATION: Section 27, Township 37 South, Range 3 East,
 Willamette Meridian, Jackson County, Oregon.

BASIS OF BEARING: Solar Observation

PURPOSE: To establish property corners and mark and post
 National Forest ownership within Section 27.

PROCEDURE: Prior to commencement of this survey an investiga-
 tion of corner control was made. The sectional
 boundaries were established by William Turner under
 Contract No. 455 dated July 17, 1882. The
 Southwest section corner was remonumented from ori-
 ginal evidence by the Bureau of Land Management,
 Cadastral Surveys. The North one-quarter corner,
 East one-quarter corner, and Northwest section
 corner were remonumented from original evidence by
 the Jackson County Surveyor. The Northeast section
 corner was remonumented from original evidence by
 Charles H. Hurst Oregon R.P.L.S. 483, as part of
 Record Survey Number 3611, dated December 20, 1967.
 The South one-quarter corner was remonumented from
 original evidence by Richard Templin Oregon R.E.
 3024, as part of Record Survey Number 4948, dated
 September 28, 1971. The West one-quarter corner
 was set by proportionate measure by Kurt Weaver
 Oregon R.P.L.S. 1679, under Record Survey Number
 7968, dated August 31, 1979.

With the above corner control identified, I per-
 formed a series of closed traverse lines tying the
 above described corners. I find no evidence of the
 original West one-quarter corner and accept the
 proportional position as established by Surveyor
 Weaver. From this information, I monumented corner
 positions and mark and post lines as shown on the
 attached map of survey.

Lines separating National Forest and private lands
 were posted with carsonite polymer posts with
 National Forest boundary signs attached. Trees
 along the line were blazed and painted with red
 timber marking paint.

Survey work was performed utilizing a Wild T-2
 Theodolite and a Hewlett Packard 3805-A Electronic
 Distance Meter.

Corners Accepted For Control

Section corner common to Sections 21, 22, 27 and 28, Township 37 South,
 Range 3 East.

At the corner point I found a standard Jackson County brass cap monument
 marked:

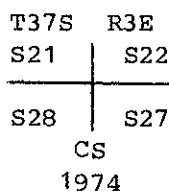

27 37 3E