

8801

SURVEY NARRATIVE TO COMPLY WITH PARAGRAPH 209.250
OREGON REVISED STATUTES

Survey for: David A. Paris
Sandra D. Lofland
1324 Brentwood Drive
Medford, Oregon 97501

Survey by : Charles H. Hurst
304 South Holly
Medford, Oregon 97501

Bearings : Derived from Surveys No. 5723 and 6321.

Purpose : Minor Land Partition (File No. 81-14 MP)

Procedure

The west line of Section 31 was remeasured inasmuch as existing monuments in the proximity thereof do not reflect the true location of said line with respect to the northwest section corner as monumented by the Jackson County Surveyor in 1974.

Alignment for Modoc Road was held in accordance with existing monumentation as found for Surveys No. 5723 and 6321. This alignment was not verified by retracement due to the economic limitations involved.

The north line of D.R. 578-302, as found to be monumented by Survey No. 3624, physically constitutes an original division line and accordingly was held superior to the deed call. The south line of said tract, in the absence of monumentation, was established according to deed record.

March 25, 1981

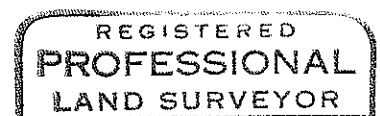
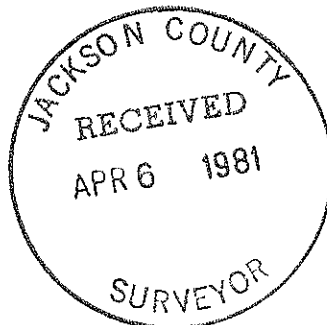

Charles H. Hurst

