

BASIS OF BEARINGS:
RS 6229

- FD. 5/8" ST. PIN
- ⊙ MONUMENT FOUND AS SHOWN
- 5/8"x30" ST. PIN SET
- () RECORD MEASUREMENT
- *-* FENCE LINE

PLAT OF SURVEY
for
SCHOFIELD & ASSOCIATES
located in
S1/2 SEC. 29, T34S, R1E., WM.
JACKSON COUNTY, OREGON

March 31, 1981
Scale 1"=200'

EDWARDS SURVEYING
ROGUE RIVER, OREGON

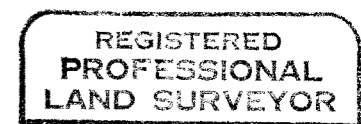
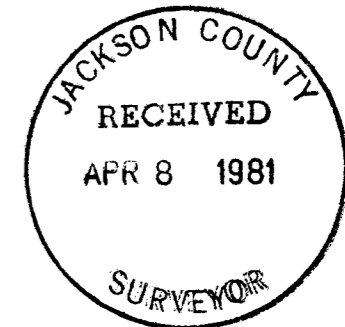

Darrel W. Edwards

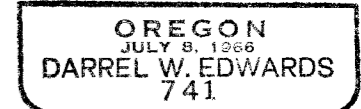

SURVEY NO 8780

SURVEY NARRATIVE TO COMPLY WITH PARAGRAPH 209-250, OREGON REVISED STATUTES

SURVEY FOR: Schofield and Associates
11 Almond
Medford, Oregon

LOCATION: SE and SW 1/4 Sec. 29, T.34S., R.1E., W.M., Jackson County, Oregon.

PURPOSE: To locate and monument the Schofield property as shown on the accompanying plat.

PROCEDURE: I retraced a portion of RS 6229 as shown. Finding no discrepancies I used the monuments to set 5/8" steel pins as shown on the accompanying plat.

EQUIPMENT: Zeiss Th 43 Theodolite and Lietz Red-1 EDM.

BASIS OF BEARINGS: RS 6229

DATE COMPLETED: March 31, 1981

Darrel W. Edwards
P.O. Box 801
Rogue River, Oregon
Ph. 582-3110

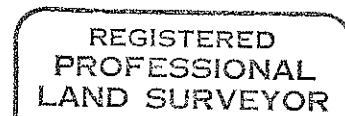

Darrel W. Edwards

