

BASIS OF BEARINGS:
PLAT OF
PIONEER SUBDIVISION

SCALE: 1"=60'

- Monument Found - 5/8" St. Pin Unless otherwise noted
- 5/8"x30" St. Pin Set
- () Record Measurement
- x—x— Fence Line

REGISTERED
PROFESSIONAL
LAND SURVEYOR

Darrel W. Edwards

OREGON
JULY 9, 1958
DARREL W. EDWARDS
741

PLAT OF SURVEY
for
CLAUDE BROWN
located in
D.L.C. No. 71, T.37S., R.2W., W.M.,
JACKSON COUNTY, OREGON
MARCH 25, 1981

EDWARDS SURVEYING
ROGUE RIVER, OREGON 81-21

(TL 9000) 37 2W 27A

SURVEY NO 8770

SURVEY NARRATIVE TO COMPLY WITH PARAGRAPH 209.250, OREGON REVISED STATUTES

SURVEY FOR: Claude Brown
 1/2 Kendall Birdsall
 102 A Pine Street
 Rogue River, Oregon

LOCATION: D.L.C. No. 71, T.37S., R.2W., W.M., Jackson County, Oregon.

PURPOSE: To locate and monument the property corners of the Brown property as shown on the accompanying plat.

PROCEDURE: Using the monuments found in the Pioneer Subdivision and Deed Records I set 5/8" steel pins at the property and witness corners as shown on the accompanying plat.

EQUIPMENT: Zeiss Th 43 theodolite and Lietz Red-1 EDM.

BASIS OF BEARINGS: Plat of Pioneer Subdivision

DATE COMPLETED: March 25, 1981

Darrel W. Edwards
P.O. Box 801
Rogue River, Oregon
Ph. 582-3110

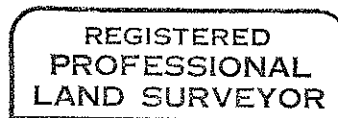
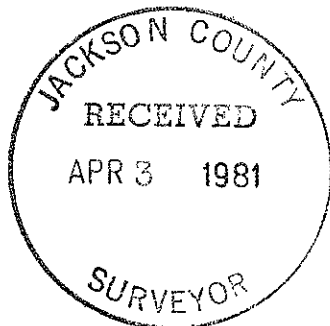

Darrel W. Edwards

