

- MONUMENT FOUND- 5/8" Steel pin
- 5/8"x30" STEEL PIN SET

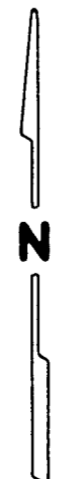

BASIS OF BEARINGS:
RS 7782

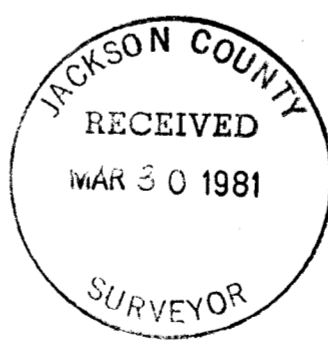

REGISTERED
PROFESSIONAL
LAND SURVEYOR

Darrel W. Edwards
OREGON
JULY 21, 1964
DARREL W. EDWARDS
741

PLAT OF SURVEY
for
DENNY BELL
located in
SW 1/4 SEC. 33, T.34S, R.4W, W.M.
JACKSON COUNTY, OREGON

March 12, 1981

Scale 1"=100'

EDWARDS SURVEYING
ROGUE RIVER, OREGON

81-19

SURVEY NO. 876 4

SURVEY NARRATIVE TO COMPLY WITH PARAGRAPH 209.250, OREGON REVISED STATUTES

SURVEY FOR: Denny Bell
10401 West Evans Creek Road
Rogue River, Oregon

LOCATION: SW 1/4 Section 33, T.34S., R.4W., W.M., Jackson County, Oregon.

PURPOSE: To locate and monument the property corners of the Bell property as shown on the accompanying plat.

PROCEDURE: Using the control established in RS 7782, Deed Records, and the monuments found I set 5/8" steel pins as shown on the accompanying plat.

EQUIPMENT: Zeiss Th 43 theodolite and Lietz Red-1 EDM.

BASIS OF BEARINGS: RS 7782

DATE COMPLETED: March 12, 1981

Darrel W. Edwards
P.O. Box 801
Rogue River, Oregon
Ph. 582-3110

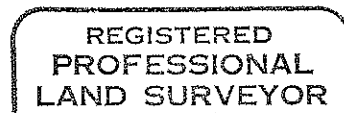
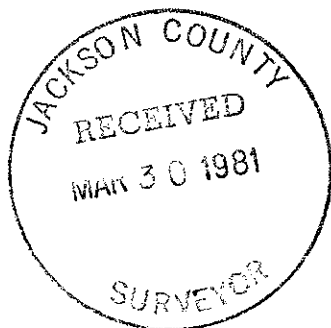

Darrel W. Edwards

