

- BEARING TREES :**
- 1/4 28 Hemlock 16" dia. bears N44°06' W, 32.0 ft. (Rec. N 42° W, 31.7')
 - 33 Fir 24" dia. bears N27°28' W, 15.7 ft. (Rec. N 8 1/2° W, 15.2')
 - Yew 12" dia. bears S27°26' E, 25.8 ft. (Rec. S 37° E, 24.4')
 - Yew 10" dia. bears S 5° 50' E, 18.9 ft. (Rec. S 6° E, 18.5')
-
- 29 28 P Pine 13" dia. bears N64°26' E, 74.3 ft. (Rec. N 64° E, 73.9')
 - 32 33 Hemlock 20" dia. bears S46°44' E, 14.7 ft. (Rec. S 47° E, 14.5')
 - Hemlock 30" dia. bears S 9° 30' E, 49.4 ft. (Rec. S 10° E, 49.5')
 - Yew 6" dia. bears S49°48' W, 104.6 ft. (Rec. S 60° W, 104.9')
 - D. Fir 46" dia. bears S63°27' W, 21.0 ft. (Rec. S 61° W, 19.1')
 - Fir Stump 60" dia. bears N53°07' E, 21.7 ft. (Rec. N52° E, 19.1')
 - P Pine 7" dia. bears N 4° 52' W, 57.5 ft. (New Bearing Trees)
-
- N 1/16 Hemlock 9" dia. bears N57°55' W, 18.4 ft. (New Bearing Trees)
 - Hemlock 8" dia. bears N39°39' E, 41.2 ft. (" " ")
-
- 1/4 33 Hemlock 7" dia. bears S85°06' W, 53.0 ft. (New Bearing Tree)
 - 32 P Pine 11" dia. bears S 8° 58' E, 24.8 ft. (" " ")
-
- CN 1/16 D. Fir 21" dia. bears N56°43' E, 18.2 ft. (New Bearing Trees)
 - Hemlock 7" dia. bears N25°31' W, 42.8 ft. (" " ")
-
- S 1/16 Hemlock 10" dia. bears S43°06' W, 131.1 ft. (New Bearing Trees)
 - Hemlock 13" dia. bears N34°17' W, 29.1 ft. (" " ")
 - D. Fir 10" dia. bears S45°55' E, 58.8 ft. (" " ")
 - Fir Staub 23" dia. bears N27°24' E, 11.2 ft. (Rec. N28° E, 10.6')
 - Fir Staub 17" dia. bears S31°40' W, 15.4 ft. (Rec. S32° W, 15.2')
 - Fir Staub 13" dia. bears N26°51' W, 75.3 ft. (Rec. N26° W, 74.6')
 - Fir Stump 17" dia. bears S 4° 00' E, 22.3 ft. (Rec. S 50° E, 23.1')
 - Fir 27" dia. bears N50°16' E, 85.2 ft. (Rec. N50° E, 85.1')
 - Hemlock 21" dia. bears S 2° 07' E, 49.5 ft. (Rec. S 4° E, 49.5')
 - W. Fir 11" dia. bears N63°19' W, 19.9 ft. (New Bearing Tree)
 - W. Fir 10" dia. bears S66°58' W, 23.5 ft. (" " ")

- BEARING TREES :**
- 33 D. Fir 9" dia. bears S57°39' W, 35.2 ft. (New Bearing Tree)
 - 1/4 4 D. Fir 10" dia. bears N 6° 22' W, 16.1 ft. (" " ")
-
- CS 1/16 D. Fir 14" dia. bears N 65° 53' E, 98.9 ft. (New Bearing Tree)
 - P. Pine 7" dia. bears S 15° 24' E, 37.1 ft. (" " ")
-
- 33 34 D. Fir 16" dia. bears S73°36' W, 21.7 ft. (Rec. S74° W, 21.8')
 - 4 3 W. Fir 17" dia. bears N45°58' W, 36.3 ft. (Rec. N45° W, 37.0')
 - Fir Snag 7" dia. bears S27°09' E, 30.08 ft. (Rec. S 26° E, 31.02')
 - Fir Snag 36" dia. bears N8°53' E, 27.3 ft. (Rec. N10° E, 27.7')
 - Fir Stump 25" dia. bears S63°13' E, 19.8 ft. (Rec. S 63° E, 19.8')
 - D. Fir 8" dia. bears N13°13' E, 93.0 ft. (New Bearing Tree)
 - W. Fir 9" dia. bears S22°46' E, 69.6 ft. (" " ")
-
- 1/4 33 W. Fir 16" dia. bears N25°32' W, 39.5 ft. (Rec. N23° W, 39.7')
 - 34 W. Pine Snag 10" dia. bears N74°53' E, 64.9 ft. (Rec. N77 1/2° E, 64.9')
 - Uprooted Fir Stump dia. bears N47°40' W, 17.0 ft. (Rec. N46° W, 14.5')
 - Yew 16" dia. bears S75°58' E, 31.0 ft. (New Bearing Tree)

MAP OF SURVEY
 LOCATED IN SECTION NO. 33, T. 31 S., R. 3 E.,
 W.M., JACKSON COUNTY, OREGON.

FOR
THE U.S. FOREST SERVICE
 REF. CONTRACT NO. 53 - 04HI - 0 - 8139 N

BASIS OF BEARING : SOLAR OBSERVATION

- ⊙ : SET 2"x30" FLANGED G.I.P. W/2 1/2" BRASS CAP
- : FOUND B.L.M. PIPE AND BRASS CAP
- ⊗ : FOUND JACKSON COUNTY PIPE AND BRASS CAP

SCALE : 1" = 400.0 ft.
 METER : m. = 3.2808333 ft.

REF. : FIELDBOOK NO. 1 OF 2 GREENACRES CADASTRAL SURVEY CONTRACT NO. 53 - 04HI - 0 - 8139 N

DATE : SURVEY BEGAN January 17, 1981
 COMPLETED February 12, 1981

FEET 0 400 800 1200
 METERS 0 100 200 300

NORTH MEAN MAG. DECLINATION 18° 05' EAST

PROCEDURE :
 ALL CONTROLLING CORNERS WERE INCORPORATED IN A SERIES OF CLOSED TRAVERSES USING A WILD T-1 THEODOLITE AND AN H.P. 3805A E.D.M.. THE SOUTH AND WEST QUARTER CORNERS WERE SET VIA PROPORTIONATE MEASUREMENT AFTER EXTENSIVE FIELD SEARCH FOR ORIGINAL EVIDENCE. THE SUBDIVISION OF THE SECTION WAS COMPUTED AND A RANDOM TRAVERSE WAS RUN AROUND THE N 1/2 OF THE SW 1/4 AND THE S 1/2 OF THE NW 1/4. THE EXTERIOR OF SAID N 1/2 AND S 1/2 WAS THEN MARKED DELINEATING NATIONAL FOREST LANDS.

HISTORY :
 THE SOUTH LINE OF THE TOWNSHIP WAS SURVEYED BY RUFUS S. MOORE IN 1884 UNDER CONTRACT NO. 496.. THIS LINE WAS SUBSEQUENTLY FOUND BY PETER APPLIGATE DURING THE SUBDIVISION OF T. 31 S., R. 3 E.. ALL FOUR CORNERS WERE B.L.M. RE-MONUMENTATIONS EXCEPT THE EAST 1/4 CORNER WHICH WAS A COUNTY SURVEYOR RE-MONUMENTATION.

CONTRACT SURVEYOR'S CERTIFICATE :
 I, KURT C. WEAVER, A REGISTERED PROFESSIONAL LAND SURVEYOR IN THE STATE OF OREGON, HEREBY CERTIFY THAT THIS PLAT AND THE NOTES HEREON, OR ATTACHED, ARE A CORRECT REPRESENTATION OF A SURVEY PERFORMED BY ME OR UNDER MY DIRECTION DURING JANUARY AND FEBRUARY, 1981, AT THE REQUEST OF THE U.S.D.A. FOREST SERVICE, IN ACCORDANCE WITH THE STATUTES OF THE STATE OF OREGON AND WITH THE ARTICLES OF MY CONTRACT.

Kurt C. Weaver
 KURT C. WEAVER
 REGISTERED PROFESSIONAL LAND SURVEYOR
 OREGON LICENSE 1679

REGISTERED PROFESSIONAL LAND SURVEYOR
 KURT C. WEAVER
 JULY 14, 1978
 OREGON LICENSE 1679

EXAMINED AND ACCEPTED FOR THE U.S. FOREST SERVICE
 THIS 10th DAY OF MARCH, 1981

David J. [Signature]
 JACKSON COUNTY RECEIVED
 MAR 13 1981
 SURVEYOR

SURVEY NARRATIVE TO COMPLY WITH O.R.S. 209.250

Survey For: U. S. Forest Service
Rogue River National Forest
P.O. Box 520
Medford, OR 97530

Location: Located in the Northwest and the Southwest quarters of Section 33, Township 31 South, Range 3 East of the Willamette Meridian, Jackson County, Oregon.

Purpose: To mark the West, North and East lines of the South half of the Northwest quarter and the West, South and East lines of the North half of the Southwest quarter of Section 33. It was also required to monument the four sixteenth corners of the above as shown on the accompanying map.

Procedure: The controlling corners were incorporated in a series of closed traverses using a Wild T-1 theodolite and an H-P 3805A E.D.M.. The northwest, southwest and southeast corners of Section 33 are B.L.M. monuments set from original evidence. The North 1/4 corner was also a B.L.M. remonumentation, however, this monument had been disturbed and was lying loose about the ground. We placed a 2" x 30" flanged galvanized iron pipe with a 2-1/2" brass cap at the corner position exposed 6", from which:

Hemlock 16" dia. bears N44°06'W 32.0 feet
(record N42°W 31.7 feet).
Fir 24" dia. bears N27°28'W 15.7 feet
(record N8-1/2°W 15.2 feet).
Yew 12" dia. bears S27°26'E 25.8 feet
(record S37°E 24.4 feet).
Yew 10" dia. bears S5°50'E 18.9 feet
(record S6°E 18.5 feet).

The East 1/4 corner is a Jackson County Surveyor remonumentation.

The West and South 1/4 corners of Section 33 were determined to be lost after extensive search was conducted in the vicinity of the corner positions. These corners were set via proportion position. The South 1/4 corner position relates quite well to the creek call to the west. No calls were made near the West 1/4 corner, however, the proportion position fits fairly well with use lines and an East-West blazed line extending West from the corner. The corner lies about 10 feet inside a clear cut unit.

The following corner monuments and accessories were recorded at the corners:

1/4 33|34: Found a Jackson County Surveyor 1" G.I. pipe with a 2-1/2" brass cap flush with the surface of the ground, from which:

W. Pine snag 10" dia. bears N74°53'E 64.9 feet
(record N77-1/2°E 64.9 feet).
uprooted Fir stump bears N47°40'W 17.0 feet
(record N46°W 14.5 feet).
W. Fir 16" dia. bears N25°32'W 39.5 feet
(record N23°W 39.7 feet).

I mark the following tree as required, taking measurements to the center of the tree at the lower blaze in which I place a brass washer marked L.S. 1679:

Yew 16" dia. bears S75°58'E 31.0 feet.

Section Corner $\frac{33}{4} | \frac{34}{3}$: Found a standard BLM pipe and brass cap 1962, exposed 7 inches, from which:

D. Fir 16" dia. bears S73°36'W 21.7 feet
(record S74°W 21.8 feet).
W. Fir 17" dia. bears N45°58'W 36.3 feet
(record N45°W 37.0 feet).
Fir snag 7" dia. bears S27°09'E 30.8 feet
(record S26°E 31.0 feet).
Fir snag 36" dia. bears N8°53'E 27.3 feet
(record N10°E 27.7 feet).
Fir stump 25" dia. bears S63°13'E 19.8 feet
(record S63°E 19.8 feet).

I marked the following trees on a previous survey:

D. Fir 8" dia. bears N13°13'E 93.0 feet.
W. Fir 9" dia. bears S22°46'E 69.6 feet.

1/4 $\frac{33}{4}$: I set a 2" x 30" flanged, galvanized iron pipe with a 2-1/2" brass cap exposed 6", from which I mark the following trees as required, taking measurements to the center of tree at the lower blaze in which I place a brass washer marked L.S. 1679:

D. Fir 9" dia. bears S57°39'W 35.2 feet.
D. Fir 10" dia. bears N6°22'W 16.1 feet.

Section Corner $\frac{32}{5} | \frac{33}{4}$: Found a standard BLM pipe and brass cap exposed 8", dated 1962, from which:

Fir staub 23" dia. bears N27°24'E, 11.2 feet
(record N28°E 10.6 feet).
Fir 27" dia. bears N50°16'E 85.2 feet
(record N50°E 85.1 feet).
Fir stump 17" dia. bears S4°00'E 22.3 feet
(record S50°E 23.1 feet).
Hemlock 21" dia. bears S2°07'E 49.5 feet
(record S4°E 49.5 feet).
Fir staub 17" dia. bears S31°40'W 15.4 feet
(record S32°W 15.2 feet).
Fir staub 13" dia. bears N26°51'W 75.3 feet
(record N26°W 74.6 feet).

I mark the following trees as required, taking measurements to the center of the tree at the lower blaze in which I place a brass washer marked L.S. 1679:

W. Fir 11" dia. bears N63°19'W 19.9 feet.
W. Fir 10" dia. bears S66°58'W 23.5 feet.

1/4 $\frac{32}{3} | \frac{33}{3}$: I set a 2" x 30" flanged, galvanized iron pipe with a 2-1/2" brass cap exposed 6 inches, from which I mark the following trees as required, taking measurements to the center of tree at the lower blaze in which I place a brass washer marked L.S. 1679:

Hemlock 7" dia. bears S85°06'W 53.0 feet.
P. Pine 11" dia. bears S8°58'E 24.8 feet.

Section Corner $\frac{29}{32} | \frac{28}{33}$: Found a standard BLM pipe and brass cap, dated 1966, exposed 7" from which:

P. Pine 13" dia. bears N64°26'E 74.3 feet
(record N64°E 73.9 feet).
Hemlock 20" dia. bears S46°44'E 14.7 feet
(record S47°E 14.5 feet).
Hemlock 30" dia. bears S9°30'E 49.4 feet
(record S10°E 49.5 feet).
Yew 6" dia. bears S49°48'W 104.6 feet
(record S60°W 104.9 feet).
D. Fir 46" dia. bears S63°27'W 21.0 feet
(record S61°W 19.1 feet).

Fir stump 60" dia. bears N53°07'E 21.7 feet
(record N52°E 19.1 feet).

I mark the following tree as required taking measurements to the center of the tree at the lower blaze in which I place a brass washer marked L.S. 1679:

P. Pine 7" dia. bears N4°52'W 57.5 feet.

N 1/16 32!33: I set a 2" x 30" flanged galvanized iron pipe with a 2-1/2" brass cap exposed 6" from which I mark the following trees as required, taking measurements to the center of the trees at the lower blaze in which I place a brass washer marked L.S. 1679:

Hemlock 9" dia. bears N57°55'W 18.4 feet.
Hemlock 8" dia. bears N39°39'E 41.2 feet.

CN 1/16 Section 33: I set a 2" x 30" flanged galvanized iron pipe with a 2-1/2" brass cap exposed 6", from which I mark the following trees as required, taking measurements to the center of the trees at the lower blaze in which I place a brass washer marked L.S. 1679:

D. Fir 21" dia. bears N56°43'E 18.2 feet.
Hemlock 7" dia. bears N25°31'W 42.8 feet.

CS 1/16 Section 33: I set a 2" x 30" flanged galvanized iron pipe with a 2-1/2" brass cap exposed 6", from which I mark the following trees as required and take measurements to the center of the trees at the lower blaze in which I place a brass washer marked L.S. 1679:

D. Fir 14" dia. bears N65°53'E 98.9 feet.
P. Pine 7" dia. bears S15°24'E 37.1 feet.

S 1/16 32!33: I set a 2" x 30" flanged, galvanized iron pipe with a 2-1/2" brass cap exposed 6", from which I mark the following trees as required, taking measurements to the center of the trees at the lower blaze in which I place a brass washer marked L.S. 1679:

Hemlock 10" dia. bears S43°06'W 131.1 feet.
Hemlock 13" dia. bears N34°17'W 29.1 feet.

D. Fir 10" dia. bears S45°55'E 58.8 feet.

The lines shown on the accompanying map were marked with blazed trees and fiberglass posts with "Forest Boundary signs".

Bearing was based on a solar observation.

Surveyed By: T. Flatebo and Associates, Inc.
P.O. Box 900
Jacksonville, OR 97530

Date: Survey began January 19, 1981.
Completed February 12, 1981.

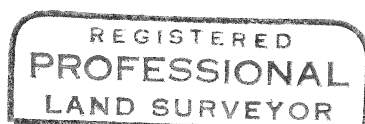

Kurt C. Weaver

