

BASIS OF BEARINGS:  
RS 6746



SURVEY FOR ROGUE RIVER RURAL FIRE DEPARTMENT	
LOCATION BLK. 1, CARNER & SABIN'S ADD'N, WOODVILLE SW 1/4 SEC. 15, T36S, R4W, WM, JACKSON CO., OR.	
DATE FEB. 13, 1981	REGISTERED PROFESSIONAL LAND SURVEYOR <i>Darrel W. Edwards</i> OREGON JULY 8, 1958 DARREL W. EDWARDS 741
SCALE 1" = 60'	
● MONUMENT FOUND	RECORD MEASUREMENT
○ 5/8"x30" STEEL PIN SET	
( ) RECORD MEASUREMENT	

36 4W 15 CC

SURVEY NO 8737

SURVEY NARRATIVE TO COMPLY WITH PARAGRAPH 209.250, OREGON REVISED STATUTES

SURVEY FOR: Rogue River Rural Fire Department  
111 Broadway  
Rogue River, Oregon 97537

LOCATION: Elk. 1, Corner and Sabin's addition to Woodville (Rogue River)  
SW 1/4 Sec. 15, T.36S., R.1W., W.M., Jackson County, Oregon.

PURPOSE: To locate and monument the North and West property lines of the  
Fire Department property as described in the Official Records  
for Jackson County, Oregon.

PROCEDURE: Using Deed Records and the control established in a previous  
survey in this city block, I set pins as shown on the  
accompanying plat.

EQUIPMENT: Zeiss Th 43 Theodolite and Lietz Red-1 EDM. and 200 foot steel  
tape.

BASIS OF BEARINGS: RS 6746

DATE COMPLETED: Feb. 13, 1981

Darrel W. Edwards  
P.O. Box 801  
Rogue River, OR 97537  
Ph. 582-3110

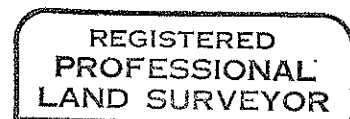
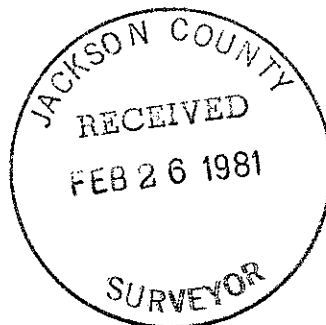

*Darrel W. Edwards*

