

FD. BRASS DISK IN CONC.
INITIAL POINT OF STARWOOD ESTATES
UNIT NO. 3

Survey For: HUNTER & SHUTE, ARCHITECTS
1175 E. MAIN ST.
MEDFORD, OREGON

Prepared By: MARQUESS & ASSOCIATES, INC.
1120 E. JACKSON ST.
MEDFORD, OREGON

Located In: DLC NO. 59, NW 1/4 SECT. 13, T37S, R2W, WM
BEING WITHIN LOT 24 ENOCH WALKER PLACE
AND MACE SUBDIVISION
JACKSON COUNTY, OREGON

REGISTERED
PROFESSIONAL
LAND SURVEYOR

Robert Joseph Milts

OREGON
SEPTEMBER 21, 1977
ROBERT JOSEPH MILTS
No. 1272

SUNWOOD
DRIVE

940.94

841.26

FD. SPIKE

MACE ROAD

N 89° 57' 25" E

FD. LEAD PLUG
AND TACK IN
CONC.

HOWARD AVENUE

7

8

9

10

12

13

14

MACE SUBDIVISION

FD. 5/8" RE-BAR

N 89° 57' 25" E

381.14

FD. 1" IRON PIPE
1.5' SOUTH &
2.2' EAST

RS 392
RS 4440

O.R. 71-01751

443.09

MERRIMAN ROAD

40.66'

FD. 5/8" RE-BAR,
14" DEEP
FD. 5/8" RE-BAR

FD. 1" IRON PIPE
0.8' SOUTH &
1.5' EAST

VOL. 429, PG. 68
LESS O.R. 71-00751

O.R. 71-00750

N 00° 01' 30" W
158.79

N 89° 57' 30" E

381.17

N 00° 01' 30" W

FD. 5/8" RE-BAR
W/ FRIAR CAP

FD. 3/4" IRON
PIPE
0.1' NORTH

NORTH LINE VOL. 358, PG 44
JK. CTY. DEED REC.
AS ESTABLISHED BY R.S. 6736

R.S. 6736

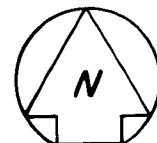

December, 1980

LEGEND

- o Monument found, as noted
- Set 5/8" x 24" Re-bar

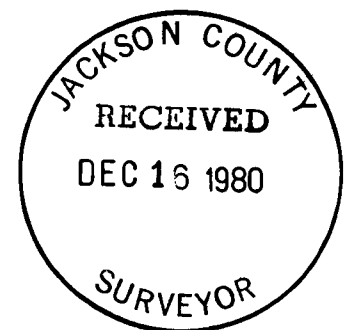

FD. SPIKE

DE BARR AVENUE

SW COR. DLC NO. 59
FD. 1" HEX PIN

1848.29

BASIS OF BEARING N 00° 01' 30" W
WEST LINE DLC NO. 59

SURVEY NARRATIVE TO COMPLY WITH PARAGRAPH 209.250
OREGON REVISED STATUTES

SURVEY FOR: Hunter & Shute, Architects
1175 E. Main
Medford, Oregon

LOCATION: DLC No. 59, NW 1/4 Sect. 13, T37S, R2W, WM, and being within Lot 24 Enoch Walker Place and Mace Subdivision, Jackson County, Oregon.

PURPOSE: To locate the boundary lines of Howard School for a building expansion program.

PROCEDURE: First located the West line of Donation Land Claim No. 59 using the found Southwest corner and the initial point of Starwood Estates Unit No. 3 which Verlyn Thomas describes as being on the West line of DLC 59.

The West line of O.R. 71-01751 and O.R. 71-00750 was established as parallel with the West line of DLC 59 and 841.26 feet distant.

The South line was established as parallel with and 50 feet northerly of the North line of Vol. 358, Page 44 as established by R.S. 6736. The description for O.R. 71-00751 was prepared by the City of Medford Public Works Department. The City files were researched to find the origin of the dimension of 179.36 feet which is given in O. R. 71-00751. This was a calculated dimension which was arrived at by using deed dimensions from Vol. 448, pg. 158 and Vol. 358, pg. 44. There is an approximately 21 foot gap between these descriptions which is not immediately obvious.

The northerly portion of the West line was previously established by R.S. 4440. The southerly portion of the West line was established as parallel with the West line of DLC 59 and beginning at the Southwest corner of Lot 10 of the Mace Subdivision.

December, 1980

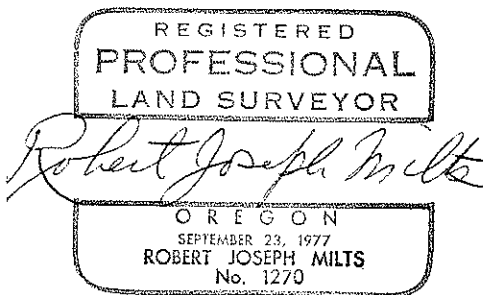
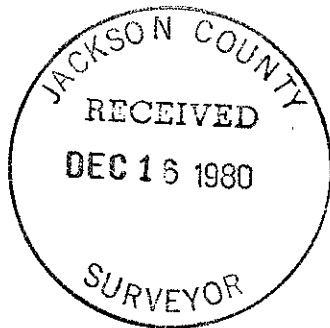

MARQUESS & ASSOCIATES, INC.
1120 E. Jackson St.-P. O. Box 490
Medford, Oregon

Robert Joseph Milts
Professional Land Surveyor