

FOUND 1 1/2" I. PIPE WITH LEAD FILLED EXPANDER STAMPED: T 32 S R 4 E 20 | 21 29 | 30 1954 INSIDE 2 1/2" DIA. I. P.

NOTE: IN ORDER TO SET NEW MONUMENT IN SAME HOLE, I REMOVED EXISTING 1 1/2" DIA. I. PIPE WITH LEAD FILLED EXPANDER STAMPED: (RS 787 W 1/16 S 30 S 31 1969)

NOTE: IN ORDER TO SET NEW MONUMENT IN SAME HOLE, I REMOVED EXIST. 1 1/2" DIA. I. PIPE WITH LEAD FILLED EXPANDER STAMPED: (E 1/16 S 30 S 31 1968)

NOTE: USING EXISTING B.T.'s, I RE-SET FOUND DISTURBED 1 1/2" DIA. I. PIPE SET IN A CONCRETE BLOCK. SAID PIPE HAS EXPANDER FILLED WITH POT METAL STAMPED: T 32 S R 4 E 32 | 33 C.S. 1/4 COR 1955

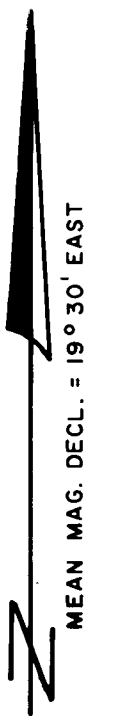

**MAP OF SURVEY**

LOCATED IN SECTIONS 28, 29, 30, 31 and 32 T. 32 S., R. 4 E., W.M., JACKSON COUNTY, OREGON.

FOR THE U.S. FOREST SERVICE  
OCTOBER 9, 1980

**CERTIFICATE OF SURVEY**

"I, DONALD L. BRANCH, A REGISTERED LAND SURVEYOR IN THE STATE OF OREGON, HEREBY CERTIFY THAT THIS PLAT AND THE NOTES HEREON, OR ATTACHED, ARE A CORRECT REPRESENTATION OF A SURVEY I PERFORMED DURING JULY THRU OCTOBER 1980, FOR THE U.S. FOREST SERVICE, IN ACCORDANCE WITH THE STATUTES OF THE STATE OF OREGON AND WITH THE ARTICLES OF MY CONTRACT."

DONALD L. BRANCH  
REGISTERED LAND SURVEYOR  
OREGON LICENSE NO. 1137

**LEGEND**

- FOUND STANDARD BLM MONUMENT UNLESS NOTED OTHERWISE.
- ⊕ SET 2 1/2" DIA. x 30" LG. IRON POST WITH 2 1/2" DIA. BRASS CAP UNLESS OTHERWISE NOTED.
- ▲ FOUND 5/8" IRON PIN.
- PROPERTY LINE ESTABLISHED AND POSTED THIS SURVEY.
- - - SECTION LINE CALCULATED FROM TRAVERSE SURVEY.
- - - INTERIOR SECTION SUBDIVISION LINE.
- (G.R.) GOVERNMENT RECORD, ch = chains

REGISTERED PROFESSIONAL LAND SURVEYOR

OREGON  
SEPTEMBER 23 1977  
DONALD L. BRANCH  
1137

RECEIVED  
NOV 17 1980

EXAMINED AND ACCEPTED FOR THE U.S. FOREST SERVICE THIS 17<sup>TH</sup> DAY OF November 1980

**BASIS OF BEARING - SOLAR OBSERVATION**

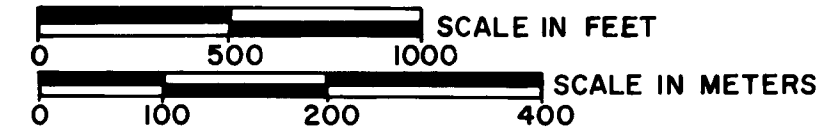

1 METER = 3.280833 FEET

**HISTORY OF SURVEYS**

TOWNSHIP LINES AND SUBDIVISION OF TOWNSHIP 32 SOUTH, RANGE 4 EAST, WAS PERFORMED BY RUFUS S. MOORE UNDER CONTRACT NO. 504 DATED MAY 1884. CORNERS ALONG THE WEST LINE OF SECTION 30, T. 32 S., R. 4 E., WERE RESTORED BY BLM AND COMPLETED IN 1962. SECTION AND 1/4 CORNERS OF EVIDENCE WERE RESTORED IN 1966 BY BLM. THE 1/4 CORNER COMMON TO SEC. 32 & 33, T. 32 S., R. 4 E., WAS RECOVERED BY C.Z. BOYDEN ON JULY 20, 1955. THE CORNER COMMON TO SECTIONS 20, 21, 28 & 29, T. 32 S., R. 4 E. WAS RECOVERED BY C.Z. BOYDEN ON JULY 10, 1950.

From which the following references:

A 15" diameter hemlock, tagged, painted, blazed and scribed: CW 1/16 S30 B•T, bearing South 21° 22' West 5.3 feet.

A 19" diameter white fir, tagged, painted (red) blazed and scribed: CW 1/16 S30 B•T, bearing North 78° 16' East 37.45 feet.

- 17) West 1/16 corner common to Sections 28 and 33, Township 32 South, Range 4 East.

At the corner point I set a 2-1/2" diameter iron pipe with 2-1/2" diameter brass cap marked:

T32S R4E  
W1/16  $\frac{S28}{S33}$   
1980  
PLS 1137

From which the following references:

A 13" diameter douglas fir, tagged, painted, blazed and scribed: W 1/16 S33 B•T, bearing South 74° 54' West 9.6 feet.

A 15" diameter douglas fir, tagged, painted, blazed and scribed: W 1/16 S28 B•T, bearing North 12° 25' East 19.4 feet.

- 18) Southeast 1/16 corner in Section 30, Township 32 South, Range 4 East.

At the corner point I set in mound of stones a 2-1/2" diameter iron pipe with 2-1/2" diameter brass cap marked:

T32S R4E  
SE 1/16 S30  
1980  
PLS 1137

From which the following references:

A 7" diameter douglas fir, tagged, painted, blazed and scribed: SE 1/16 S30 B•T, bearing North 61° 05' West 9.15 feet.

A 12" diameter hemlock, tagged, painted, blazed and scribed: SE 1/16 S30 B•T, bearing South 16° 57' West 24.5 feet.

This survey performed utilizing a Jena 020 Theodolite and Mach 1-E Electronic Distance Meter.

October 21, 1980

DONALD L. BRANCH  
Registered Professional Land Surveyor  
Oregon Certificate No. 1137

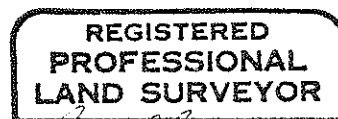
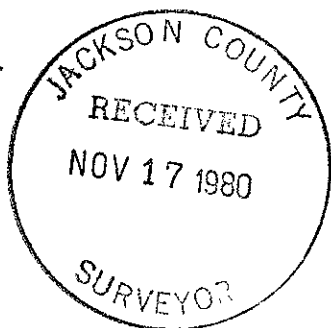

*Donald L. Branch*

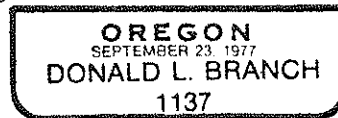

From which the following references:

A 10" diameter breast height hemlock, tagged, painted, blazed and scribed:  
 S 1/16 S29 B•T, bearing South 21° East 18.7 feet.  
 An 18" diameter breast height white fir, tagged, painted, blazed and  
 scribed: S 1/16 S30 B•T, bearing South 36° West 32.0 feet.

- 13) Center North 1/16 corner in Section 29, Township 32 South, Range 4 East.

At the corner point I set a 2-1/2" diameter iron pipe with 2-1/2"  
 diameter brass cap marked:

T32S R4E  
 C  
 N1/16 | S29  
 C  
 1980  
 PLS 1137

From which the following references:

A 17" diameter white fir, tagged, painted, blazed and scribed: CN 1/16  
 S29 B•T, bearing South 60° East 8.7 feet.  
 A 12" diameter white fir, tagged, painted, blazed and scribed: CN 1/16  
 S29 B•T, bearing South 54° 22' West 19.9 feet.

- 14) West 1/16 corner common to Sections 30 and 31, Township 32 South, Range  
 4 East.

At the corner point I set a 2-1/2" diameter iron pipe with 2-1/2"  
 diameter brass cap marked:

T32S R4E  
 W 1/16  $\frac{S30}{S31}$   
 1980  
 PLS 1137

From which the following references:

A 12" diameter yew, blazed, and scribed: W1/16 S31 RS 787, bearing  
 South 11° 22' West 37.0 feet.  
 A 13" diameter yew, tagged, painted, blazed and scribed: W 1/16 S30 B•T,  
 bearing North 74° 10' West 22.0 feet.

- 15) West 1/16 corner common to Sections 19 and 30, Township 32 South, Range 4 East.

At the corner point I set a 2-1/2" diameter iron pipe with 2-1/2" diameter  
 brass cap marked:

T32S R4E  
 W 1/16  $\frac{S19}{S30}$   
 1980  
 PLS 1137

From which the following references:

A 23" diameter douglas fir, tagged, painted, blazed and scribed: W 1/16  
 S19 B•T, bearing North 30° 05' East 22.5 feet.  
 An 18" diameter hemlock, tagged, painted, blazed and scribed: W 1/16  
 S19 B•T, bearing North 70° 43' West 20.4 feet.

- 16) Center West 1/16 corner in Section 30, Township 32 South, Range 4 East.

At the corner point I set a 2-1/2" diameter iron pipe with 2-1/2"  
 diameter brass cap marked:

T32S R4E  
 C  $\frac{W 1/16}{S30}$  C  
 1980  
 PLS 1137

From which the following references:

An 11" diameter white fir, tagged, painted, blazed and scribed: CE 1/16 S29 B.T, bearing North 20° 25' East 22.2 feet.  
 A 16" diameter white fir, tagged, painted, blazed and scribed: CE 1/16 S29 B.T, bearing South 80° 04' West 2.6 feet.

- 9) Northeast 1/16 corner in Section 29, Township 32 South, Range 4 East.

At the corner point I set a 2-1/2" diameter iron pipe with 2-1/2" diameter brass cap marked:

T32S R4E  
 NE1/16 S29  
 1980  
 PLS 1137

From which the following references:

A 12" diameter white fir, tagged, painted, blazed and scribed: NE 1/16 S29 B.T, bearing North 84° East 10.3 feet.  
 A 12" diameter white fir, tagged, painted, blazed and scribed: NE 1/16 S29 B.T, bearing South 17° 29' East 16.7 feet.

- 10) Northwest 1/16 corner in Section 29, Township 32 South, Range 4 East.

At the corner point I set a 2-1/2" diameter iron pipe with 2-1/2" diameter brass cap marked:

T32S R4E  
 NW1/16 S29  
 1980  
 PLS 1137

From which the following references:

A 6" diameter douglas fir, tagged, painted, blazed and scribed: NW 1/16 S29 B.T, bearing North 56° 30' West 4.75 feet.  
 A 6" diameter cedar, tagged, painted, blazed and scribed: NW 1/16 S29 B.T, bearing North 10° 00' East 13.0 feet.

- 11) East 1/16 corner common to Sections 29 and 32, Township 32 South, Range 4 East.

At the corner point I set a 2-1/2" diameter iron pipe with a 2-1/2" diameter brass cap marked:

T32S R4E  
 E 1/16  $\frac{S29}{S32}$   
 1980  
 PLS 1137

From which the following references:

A 19" diameter breast height hemlock, tagged, painted, blazed and scribed: E 1/16 S29 B.T, bearing North 41° 14' East 51.3 feet.  
 A 34" diameter breast height douglas fir, tagged, painted, blazed and scribed: E 1/16 S32 B.T, bearing South 38° 15' East 54.1 feet.

- 12) South 1/16 corner common to Sections 30 and 29, Township 32 South, Range 4 East.

At the corner point I set a 2-1/2" diameter iron pipe with 2-1/2" diameter brass cap marked:

T32S R4E  
 S1/16  
 S30 | S29  
 1980  
 PLS 1137

From which the following references:

- A 16" diameter hemlock, painted, tagged, blazed and scribed: E 1/16 S30 B•T, bearing North 65° 44' East 22.0 feet.
- A 12" diameter hemlock, tagged, painted, blazed and scribed: E 1/16 S31 B•T, bearing South 56° 12' West 8.6 feet.

- 5) Center 1/4 corner in Section 29, Township 32 South, Range 4 East.

At the corner point I set a 2-1/2" diameter iron pipe with a 2-1/2" diameter brass cap marked:

T32S R4E  
 C1/4 S29  
 1980  
 PLS 1137

From which the following references:

- A 12" diameter white fir, tagged, painted, blazed and scribed: C 1/4 S29 B•T, bearing North 81° 15' West 24.5 feet.
- A 16" diameter hemlock, tagged painted, blazed and scribed: C 1/4 S29 B•T, bearing North 20° 30' East 27.4 feet.

- 6) East 1/16 corner common to Sections 20 and 29, Township 32 South, Range 4 East.

At the corner point I set a 2-1/2" diameter iron pipe with a 2-1/2" diameter brass cap marked:

T32S R4E  
 E 1/16  $\frac{S20}{S29}$   
 1980  
 PLS 1137

From which the following references:

- A 15" diameter white fir tagged, painted, blazed and scribed: E 1/16 S20 B•T, bearing North 67° West 7.4 feet.
- A 7" diameter white fir, tagged, painted, blazed and scribed: E 1/16 S29 B•T, bearing South 18° 40' East 7.9 feet.

- 7) Center West 1/16 corner in Section 29, Township 32 South, Range 4 East.

At the corner point I set a 2-1/2" diameter iron pipe with a 2-1/2" diameter brass cap marked:

T32S R4E  
 C  $\frac{W 1/16}{S29}$  C  
 1980  
 PLS 1137

From which the following references:

- An 11" diameter hemlock, tagged, painted, blazed and scribed: CW 1/16 S29 B•T, bearing South 40° 24' West 26.6 feet.
- A 26" diameter white fir, tagged, painted, blazed and scribed: CW 1/16 S29 B•T, bearing North 19° 37' East 19.4 feet.

- 8) Center East 1/16 corner in Section 29, Township 32 South, Range 4 East.

At the corner point I set a 2-1/2" diameter iron pipe in mound of stones with a 2-1/2" diameter brass cap marked:

T32S R4E  
 C  $\frac{E1/16}{S29}$  C  
 1980  
 PLS 1137

CORNERS ESTABLISHED BY THIS SURVEY

- 1) Section corner common to Sections 28, 29, 32 and 33, Township 32 South, Range 4 East.

At the corner point I set a 2-1/2" diameter galvanized iron post with a 2-1/2" diameter brass cap marked:

T32S	R4E
S29	S28
S32	S33
1980	
PLS 1137	

From which the following references:

A 16" diameter white fir tagged, painted, scribed "T32S R4E S32 BT" bears South 37° 47' West 30.4 feet distance.

A 14" diameter white fir tagged, painted, scribed "T32S R4E S29 BT" bears North 30° 09' West 34.0 feet distance.

A 15" diameter white fir tagged, painted, scribed "T32S R4E S28 BT" bears North 4° 17' East 13.9 feet distance.

A 14" diameter white fir tagged, painted, scribed "T32S R4E S33 BT" bears South 81° 38' East 47.4 feet distance.

- 2) 1/4 corner common to Sections 29 and 30, Township 32 South, Range 4 East.

At the corner point I set a 2-1/2" diameter galvanized iron post with a 2-1/2" diameter brass cap marked:

T32S	R4E
1/4	
S30	S29
1980	
PLS 1137	

From which the following references:

A 10" diameter white fir tagged, painted, scribed "1/4 S30 BT" bears South 85° West 7.9 feet distance.

A 16" diameter white fir tagged, painted, scribed "1/4 S29 BT" bears North 34° East 2.6 feet distance.

- 3) 1/4 corner common to Sections 19 and 30, Township 32 South, Range 4 East.

At the corner point I set a 2-1/2" diameter galvanized iron post with a 2-1/2" diameter brass cap marked:

T32S	R4E
1/4	S19
	S30
1980	
PLS 1137	

From which the following references:

A 12" diameter white fir scribed "1/4 S30 BT" bears South 70° 08' West 76.0 feet distance.

A 14" diameter cedar scribed "1/4 S19 BT" bears North 7° 37' East 17.5 feet distance.

- 4) East 1/16 corner common to Sections 30 and 31, Township 32 South, Range 4 East.

At the point I set a 2-1/2" diameter iron pipe with a 2-1/2" diameter brass cap marked:

T32S	R4E
E 1/16	S30
	S31
1980	
PLS 1137	

From which the following references:

- A 12" diameter hemlock tagged and scribed "1/4 S29 BT" bears South 34° 03' East 15.0 feet distance.
- A 39" diameter sugar pine tagged and healed blaze bears South 46° 02' West 27.9 feet distance.
- An 8" diameter white firm tagged and healed blaze bears North 9° 52' West 15.8 feet distance.

11) 1/4 corner common to Sections 28 and 29, Township 32 South, Range 4 East.

At the corner point I found a standard B.L.M. monument marked:

T32S R4E  
 1/4  
 S29 | S28  
 1966

From which the following references:

Original: A 33" diameter fir stump bearing North 55° West 4.1 feet distance with visible scribing "BT".

B.L.M.: A 17" diameter white fir tagged and with healed blaze bears South 0° 31' East 81.7 feet distance.  
 A 21" diameter cedar tagged and with visible scribing "4S29 BT", bears North 8° West 56.6 feet distance.

12) 1/4 corner common to Sections 32 and 33, Township 32 South, Range 4 East.

At the corner point I found a 1-1/2" diameter iron pipe with lead filled expander. Pipe is set in concrete post. Monument is out of the ground and laying on its side. Monument is stamped:

T32S R4E  
 32 | 33  
 CS 1/4  
 1955

Re-set existing concrete post with 1-1/2" diameter iron pipe South 65° West 12.5 feet distance (per government record) from a 32" diameter fir stump per C. Z. Boyden, July 20, 1955.

From which the following references:

- A 21" diameter pine bears South 86° 45' West 26.0 feet distance.
- A 12" diameter white fir bears North 10° 32' East 17.5 feet distance.
- An 11" diameter douglas fir bears North 32° 53' West 11.8 feet distance.
- A 32" diameter fir stump bears North 65° East 12.5 feet distance.

13) 1/4 corner common to Section 36, Township 32 South, Range 3 East, and Section 31, Township 32 South, Range 4 East.

At the corner point I found a standard B.L.M. monument marked:

T32S  
 1/4  
 R3E | R4E  
 S36 | S31  
 1966

From which the following references:

- A 15" diameter white fir bears North 41° 20' East 17.6 feet distance.
- A 42" + diameter fir stump bears South 74° 35' East 28.0 feet distance.
- A 12" diameter douglas fir bears South 32° 45' West 53.9 feet distance.

- 7) 1/4 corner common to Section 25, Township 32 South, Range 3 East, and Section 30, Township 32 South, Range 4 East.

At the corner point I found a standard B.L.M. brass cap on 2-1/2" diameter iron pipe in mound of stones marked:

T32S  
 1/4  
 R3E | R4E  
 S25 | S30  
 1962

From which the following references:

A 9" diameter white fir tagged and with healed blaze bears South 16° 07' East 13.2 feet distance.

A 15" diameter white fir tagged with healed blaze bears South 73° 50' West 20.3 feet distance.

A 39" diameter douglas fir tagged with healed blaze bears South 75° 04' East 5.0 feet distance.

Set guard post with sign.

- 8) 1/4 corner common to Sections 30 and 31, Township 32 South, Range 4 East.

At the corner point I found a standard B.L.M. monument marked:

T32S R4E  
 1/4  $\frac{S30}{S31}$   
 1966

From which the following references:

A 27" diameter fir tagged and blaze healed bears South 15° 33' East 34.2 feet distance.

A 40" diameter pine tagged and blaze healed bears South 00° 37' West 20.8 feet distance.

A 53" diameter douglas fir tagged and bark scribed "1/4S BT" bears North 27° 28' West 25.2 feet distance.

A 12" diameter white fir, tagged and blaze healed bears North 4° 20' West 33.0 feet distance.

- 9) 1/4 corner common to Sections 28 and 33, Township 32 South, Range 4 East.

At the corner point I found a standard B.L.M. monument marked:

T32S R4E  
 1/4  $\frac{S28}{S33}$   
 1966

From which the following references:

Original: A 50" diameter douglas fir tagged, painted, with healed blaze bears North 39° 07' East 17.0 feet distance.

B.L.M.: A 38" diameter sugar pine tagged and healed face bears North 56° 23' East 48.9 feet distance.

A 16" diameter white fir tagged, and healed face bears South 89° 55' West 20.3 feet distance.

A 32" diameter white fir tagged and healed face bears South 82° 36' West 25.7 feet distance.

- 10) 1/4 corner common to Sections 20 and 29, Township 32 South, Range 4 East.

At the corner point I found a standard B.L.M. monument marked:

T32S R4E  
 1/4  $\frac{S20}{S29}$   
 1966



- 4) Section corner common to Sections 19 and 30, Township 32 South, Range 4 East, and Sections 24 and 25, Township 32 South, Range 3 East.

At the corner point I found a standard County monument marked:

T32S R3/4E  
 24 | 19  
 25 | 30  
 US BLM 1962  
 CS 1961

From which the following references:

Original: A 20" diameter dead fir with tag bears North 15° West 12.9 feet distance with scribe marks: S R3E S2 visible on open blaze.

County: A 15" diameter white fir with tag bears North 86° East, 19.9 feet distance with a healed blaze.

A 13" diameter hemlock with tag bears South 67° East, 67.3 feet distance with scribe mark "B" visible on partially open blaze.

A 25" diameter white fir bears South 45° West, 52.7 feet distance with healed blaze.

B.L.M. Bearing Trees: A white fir 16" diameter with tag bears South 72° East, 23.5 feet distance with healed blaze.

A dead 20" diameter fir bears North 39° West 8.7 feet distance marked T32S, R3E, S24, BT.

- 5) Section corner common to Sections 20, 21, 28 and 29, Township 32 South, Range 4 East.

At the corner point I found an expander filled with lead on a 1-1/4" diameter iron pipe which is inside a 2-1/2" diameter iron pipe.  
 Expander marked:

T32S R4E  
 20 | 21  
 29 | 28  
 1954

From which the following references:

A 7" diameter white fir bears South 32° 33' East 26.14 feet distance.

A 31" diameter cedar, tagged and scribing visible "CS", bears South 15° 08' West 32.2 feet distance.

A 12" diameter white firm tagged and healed blaze bears North 64° 09' West 20.55 feet distance.

A 10" diameter chinquapin tagged and healed blazes bears North 41° 57' East 14.4 feet distance.

An 8" diameter chinquapin, laying down and dead, and charred, tagged and visible scribing "T32S R4E" bears South 58° 20' West 10.25 feet distance.

- 6) 1/4 corner common to Sections 29 and 32, Township 32 South, Range 4 East.

At the corner point I found a standard B.L.M. monument marked:

T32S R4E  
 1/4  $\frac{S29}{S32}$   
 1966

From which the following references:

A 7" diameter yew wood, tagged and visible scribing "1/4 S29 BT", bears North 48° 30' East 6.2 feet distance.

A 5" diameter yew, dead and fallen, scribed "1/4 S32 BT", tagged, bears South 5° 23' East 10.1 feet distance.

A 14" diameter hemlock, tagged, scribed "1/4 S32 BT", bears South 36° 52' East 44.3 feet distance.

From which the following references:

- A 13" diameter yew wood, tagged and visible scribing "T32S R4E S30 BT" bears North 58° 30' West 43.85 feet.
- A 24" diameter dead snag (douglas fir), tagged and visible scribing "T32S R4E S29 BT" bears North 64° 42' East 60.7 feet.
- A 6" diameter douglas fir bears South 27° 18' East 37.9 feet.
- A 9" diameter pine bears South 55° 48' West 19.4 feet.
- A 38" diameter douglas fir bears North 79° 49' East 64.9 feet.

- 2) Section corner common to Sections 19, 20, 29 and 30, Township 32 South, Range 4 East.

At the corner point I found a standard B.L.M. monument in mound of stones marked:

T32S	R4E
S19	S20
S30	S29
1966	

From which the following references:

Original: A cedar, 20" diameter, bears North 40° West, 30.2 feet distance with painted blaze (healed), tagged.

By Boyden: A cedar, 21" diameter, bears South 31° West 35 feet distance, with healed blaze.

B.L.M.: A cedar, 19" diameter, bears North 48° 31' East, 32.9 feet distance marked "T32S R4E S20 BT".

A fir, 14" diameter, bears South 56° East 17.9 feet distance with painted, healed, blaze.

A fir laying down, 8" diameter, bears South 42° West 33.1 feet distance with visible scribing "S30".

- 3) Section corner common to Sections 30 and 31, Township 32 South, Range 4 East, and Sections 25 and 36, Township 32 South, Range 3 East.

At the corner point I found a standard B.L.M. monument marked:

T32S	
R3E	R4E
S25	S30
S36	S31
1962	

From which the following references:

Original: A 30" diameter white fir bears North 51° East, 5.5 feet distance, with healed blaze and tag.

County: A 25" diameter cedar bears South 30° West, 35.2 feet distance with healed blaze and tags.

A 20" diameter white fir with healed blaze bears North 19° West, 36.0 feet distance with tags.

B.L.M. in 1962: A white fir, 14" diameter bears North 14° East, 24.3 feet distance with healed blaze and tag.

A cedar 24" diameter bears South 12° East, 8.7 feet distance with healed blaze and tag.

A white fir 14" diameter bears South 50° West 30.1 feet distance with healed blaze and tag.

A white fir 27" diameter bears North 65° West, 27.9 feet distance with healed blaze and tag.

No visible scribing on any B.T.'s.

SURVEY NARRATIVE TO COMPLY WITH  
PARAGRAPH 209.250 OREGON REVISED STATUTES

SURVEY FOR: Rogue River National Forest  
P. O. Box 520  
Medford, Oregon 97501

LOCATION: Sections 28, 29, 30, and 31, Township 32 South, Range 4  
East, Willamette Meridian, Jackson County, Oregon

CONTRACT NO.: 53-04H1-0-7944N

BASIS OF BEARING: Solar Observation

PURPOSE: To establish property corners and mark and post mutual  
property lines separating National Forest and private  
lands.

PROCEDURE: Prior to commencement of this survey an investigation  
of controlling corners was made. B.L.M. restored  
corners along the West line of Section 30 in 1962 and  
in 1966 restored all section and 1/4 corners in  
Sections 30, 29 and 28 except the 1) 1/4 corner  
common to Sections 19 and 30, 2) 1/4 corner common  
to Sections 30 and 29, and 3) the corner common to  
Sections 29, 28, 32, and 33 and the 1/4 corner common  
to Sections 32 and 33. The 1/4 corner common to Sections  
32 and 33 was recovered by C. Z. Boyden on July 20, 1955.  
All found and restored corners were held as controlling  
corners for this survey.

With the above corner control verified I began a series  
of closed traverses through each found controlling  
monument. From this data corner positions were computed  
and search areas determined. Extensive search for lost  
corners was performed, with assistance provided by  
surveyors with the U.S. Forest Service, Medford office,  
and Keith Comstock, P.L.S. No. 1072, without positive  
success. The area where the missing corners are  
situated has been the subject of extensive logging.  
I, therefore, established lost corners by proportionate  
measurement and mark lines as shown on the attached  
map of survey. The location of the lost corner common  
to Sections 29, 28, 32 and 33 was determined by double  
proportioning using the adjacent 1/4 corners. A second  
method using government record topography calls was  
field measured and computed to check consistency between  
the two methods. The second method (topography calls)  
agreed with the proportioning based on 1/4 corners  
within four feet in the Northing coordinate which indi-  
cated consistency in location of the large search area.

CORNERS ACCEPTED FOR CONTROL

- 1) Section corner common to Sections 29, 30, 31 and 32, Township 32 South, Range 4 East.

At the corner point I found a standard B.L.M. monument marked:

