

SURVEY FOR: LINO S. VIEIRA

LOCATED IN THE N.W. 1/4 OF SECTION 34, T.37S., R.1W., W.M.

BY: BOYDEN SURVEYORS
NOVEMBER 4, 1980

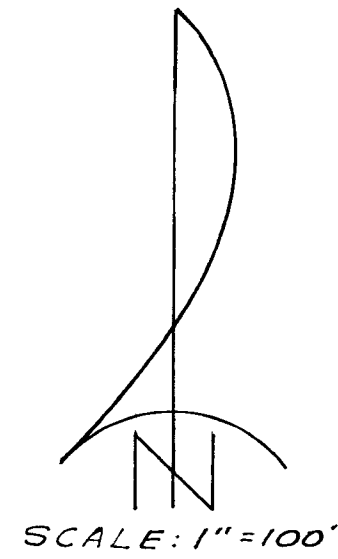

BASIS OF BEARINGS: N.G.S. TRIANGULATION STATIONS "PUMICE (C. of M.) 1971" TO "MANOR (C. of M.) 1968" WITH GRID BEARINGS DECREASED IN AZIMUTH BY $\theta = 1^{\circ}34'45''$

- o Found 5/8" iron pin
- Set 5/8" x 24" re-bar with plastic cap marked "KAISER RLS 803"

REGISTERED PROFESSIONAL LAND SURVEYOR

Gary D. Farn

OREGON JULY 1957 GARY D. FARNER



N 89° 38' 15" W (Vol. 481, P. 118 D.R. = N 89° 39' 25" W)

S.W. Corner D.L.C. No. 58.
Found 1" pipe with 2 1/2" bronze cap (C.S. 1976)

620.26 (Vol. 481, P. 118 D.R. = 620.40)

S.E. Corner D.L.C. No. 58.
Found 1 1/2" iron pipe 9" deep (C.S. 1976)

S 13° 30' 45" W (Record = 518° 29' 35" W)
1039.24 (Record = 1039.43')

S 89° 38' 15" E (Record = 589° 39' 25" E)

HARBROOKE (COUNTY) ROAD (VOL. 473, PAGE 114 D.R.)

East end of county road

4.32 AC ±

Center M.I.D. Canal (See Vol. 139, P. 124 D.R.)

VOL. 533, P. 385, D.R.

VOL. 568, P. 145 D.R.

N.W. Corner D.L.C. No. 57.
(Also P.I. 147+44.2) Found bronze disk in monument case, C.S. 1972

Found 5/8" re-bar West 1.51' and South 0.21'

NOTE: Road stationing is from Jackson County Public Works road records

P.T. 149+11.3 (Found 3/4" iron pin)

1252.43' (Vol. 533, P. 385 D.R. = 1252.89')
S 89° 43' 45" W 1777.97' (Vol. 481, P. 118 D.R. = S 89° 42' 35" W 1778.63')

Found 5/8" iron pin in concrete 0.17' North and 0.03' East

Found 1/2" pipe (Record = 3/4" pipe. See filed survey No. 692)

1011.99' (Record = 1012.17')

50° 15' 05" W 1480.99' (Vol. 481, P. 118 D.R. = 50° 13' 55" W 1481.44')

409.00' (Record = 409.27')

17.00'

check favorably with the deeded right-of-way of Harbrooke Road (Vol. 473, Page 114 D.R.)

The Southeast corner of the subject tract was determined by proportion as shown on the annexed map. The bearing of the East boundary was established parallel with the East boundary of the tract described in Vol. 481, Page 118, D.R.

Unrecorded 5/8" iron pins were also found set monumenting a line approximately 31 feet East of the East boundary of the subject tract. It appears that these monuments were erroneously set in an attempt to locate said East boundary.

Basis of bearings is N.G.S. tri stations "Pumice (C. of M.) 1971" to "Manor (C. of M.) 1968" with grid bearings decreased in Azimuth by $\theta = 1^{\circ}34'45''$.

November 4, 1980

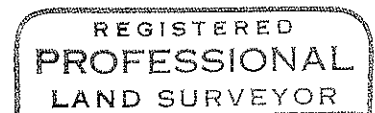
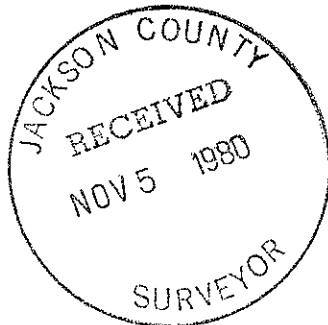

Gary D. Kaiser

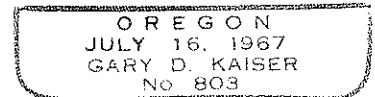

Survey No. 8579

SURVEY NARRATIVE TO COMPLY WITH O.R.S. 209.250

FOR: Lino S. Vieira
3205 South Pacific Hwy.
Medford, Oregon

BY: Boyden Surveyors
26 Laurel Street
Medford, Oregon

PURPOSE: To monument the outside boundaries of the combined tracts described in Inst. No. 80-02308 O.R. being located in Section 34, T37SR1W, W.M.

PROCEDURE: The monuments marked "found" on the annexed map were tied via closed random traverses utilizing a one-second theodolite, EDM equipment and chain.

The Southerly boundary of the subject tract was monumented on the line established on Filed Survey No. 692 running Easterly from the Northwest corner of Donation Land Claim No. 57. This appears to be the creation of this line which was again utilized on Filed Survey No. 1691.

The Westerly boundary of the subject tract was monumented on the Easterly right-of-way line of North Phoenix Road which was determined from found monuments referred to in the Jackson County Public Works road records. Filed Survey No. 1053 also utilized these monuments for road control.

The Harbrooke Road right-of-way was determined from found monuments whose origins are unknown. Several of the tracts fronting Harbrooke Road are monumented with 5/8" iron pins with no record being found of their origin. Contacts were made with previous property owners going back to the creation of Harbrooke Road and the tracts fronting it with no success in determining who the surveyor was. The monuments