

SURVEY SITUATE IN THE N.E. 1/4 OF SEC. 28, T. 38 S., R. 4 W., W.M.  
 JACKSON COUNTY, OREGON  
 FOR  
 VERNON R & CHARLOTTE FOWLER

SURVEY BY:  
 CHARLES H. HURST  
 MEDFORD, OREGON

LEGEND  
 ● SET 5/8" X 24" IRON PINS  
 ○ FD. 5/8" IRON PINS (SURVEY NO. 6045)  
 -X- EXISTING FENCE LINES

REGISTERED  
 PROFESSIONAL  
 LAND SURVEYOR

*Charles H. Hurst*

OREGON  
 OCTOBER 30, 1959  
 CHARLES H. HURST  
 483

APR 22 1980

JACKSON COUNTY  
 RECEIVED  
 JUL 9 1980  
 SURVEYOR

SCALE: 1" = 200'

8430

SURVEY NARRATIVE TO COMPLY WITH PARAGRAPH 209.250  
OREGON REVISED STATUTES

8430

Survey for: Vernon P. & Charlotte Fowler  
1199 Thompson Creek Road  
Applegate, Oregon 97530

Survey by : Charles H. Hurst  
304 S. Holly  
Medford, Oregon 97501

Bearings : As determined by the Jackson County Road Dept. and  
rotated 0°03'49" clockwise. (See Survey No. 6045)

Procedure : Utilization of survey control previously established  
during the course of Survey No. 6045

Purpose : Minor Land Partition 79-224MP

April 22, 1980

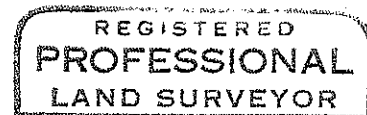
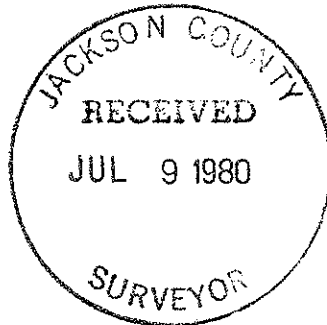

*Charles H. Hurst*

