

JACKSON COUNTY  
RECEIVED  
JUN 30 1980  
SURVEYOR

|   |   |
|---|---|
| <b>SURVEY FOR:</b> ALAN NIELSON & MRS. REIDELL  |   |
| <b>LOCATION:</b> A PART OF LOTS 5+6, BLK. 7, CORNER & SABIN'S ADD. TO ROGUE RIVER, IN THE SW 1/4 SEC. 15, T.36 S., R.4 W.W.M., IN JACKSON COUNTY, OREGON. |   |
| <b>DATE:</b> JUNE 13, 1980  | REGISTERED<br>PROFESSIONAL<br>LAND SURVEYOR<br><br><i>Darrel W. Edwards</i><br><br>OREGON<br>JULY 5, 1966<br>DARREL W. EDWARDS<br>741 |
| <b>SCALE:</b> 1" = 50'  |   |
| ● MONUMENT FOUND  |   |
| ○ 5/8" STEEL PIN SET  |   |
| ( ) RECORD MEASUREMENT  |   |
| X-X-X-X-X FENCE LINE  |   |

(TL600) 30 4W 1500

SURVEY NO. 8415

SURVEY NARRATIVE TO COMPLY WITH PARAGRAPH 209.250, OREGON REVISED STATUTES.

SURVEY FOR: Alan Nielson and Mrs. Reidell  
212 Cedar St.  
Rogue River, Or. 97537

LOCATION: A part of Lots 6 and 7, Block 7, CARNER AND SAPIN'S ADDITION to  
WOODVILLE (now Rogue River) and being in the Southwest 1/4 of  
Section 15, T. 36 S., R. 4 W.M., in Jackson County, Oregon.

PURPOSE: To locate and monument property boundaries and prepare legal  
descriptions for two parcels shown on the accompanying plat.

PROCEDURE: Found 5/8" steel pins set in R.S. 5784. Also found center line  
monuments on Cedar St. Set 5/8" steel pins as shown on the  
accompanying plat.

BASIS OF BEARINGS: R.S. 5784

DATE COMPLETED: June 13, 1980.

Darrel W. Edwards  
P.O. Box 801  
Rogue River, Or. 97537  
Ph: 582-3110

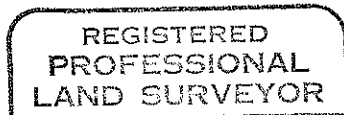
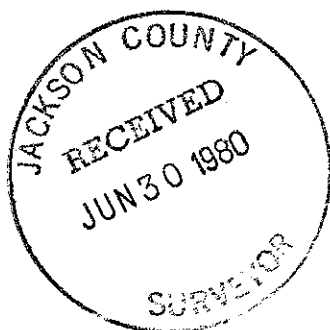

*Darrel W. Edwards*

