

SURVEY FOR: L. D. JOSEPHSON

LOCATED IN THE S.E. 1/4 OF SECTION 10,
T.36S., R.3W., W.M.

BY: BOYDEN SURVEYORS

JUNE 13, 1980

CENTER OF STATE
HIGHWAY NO. 234

Found 1/2" re-bar.
with top bent.
14.54'
The 1/4 corner to sections
10 and 11 bears North 57.75'
and East 1194.09'

S 23° 24' 30" E

349.75'

6.23'

64.57'

S 34° 22' 30" E

45.20'
Existing post and
wire fence

o Set 5/8" x 24" re-bar with
plastic cap marked "KAISER
RLS 803."

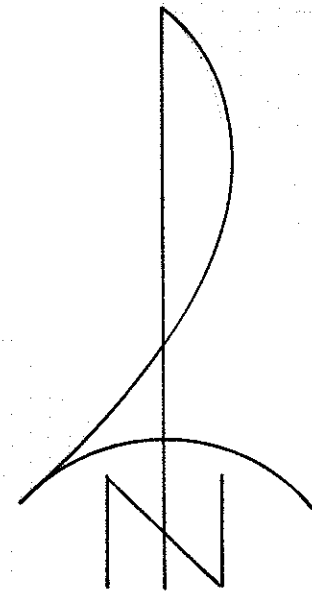

SCALE: 1" = 50'

BASIS OF BEARINGS:
MEAN OF 8 SOLAR
OBSERVATIONS

REGISTERED
PROFESSIONAL
LAND SURVEYOR

Gary D. Kaiser

OREGON
JULY 16, 1967
GARY D. KAISER
No. 803

JACKSON COUNTY
RECEIVED
JUN 17 1980
SURVEYOR

ROGUE RIVER

36 3W 10

8403

Jan 18 - 1979

Dear Mr & Mrs Josephson:

In regards to your letter about the property line, yes as far as I know we felt that the old fence was the boundary line. Can't tell you any more other than Mr Hansen was a custom Bldg & he did say that was the boundary
The fence -

Hope this will be helpful

Thanking you

Mrs Minnie E Hansen

SURVEY NARRATIVE TO COMPLY WITH O.R.S. 209.250

SURVEY FOR: L. D. Josephson
13533 Highway 234
Gold Hill, Oregon

SURVEY BY: Boyden Surveyors
26 Laurel Street
Medford, Oregon

PURPOSE: To monument a line by the testimony of our client and a letter (attached) from Mrs. Minnie E. Hansen, who formerly owned the property East of our client's property.

The fence called for in the letter as being the boundary is gone now except for the section indicated on the annexed map, but there are marks on a large pine tree near the angle point on the monumented line that appear to have been caused by an attached fence.

The "testimony line", being located in Section 10, T36SR3W, W.M., is in no way intended to represent the Deed line or the record line.

Recorded Survey Nos. 622 and 2221 do not indicate what monuments (if any) were set. No monuments were found along the "testimony line" except a 1/2" rebar of unknown origin located at the Northwesterly terminus thereof.

PROCEDURE: Monuments shown on the annexed map were set along the said testimony line as directed by our client.
A closed EDM traverse was run to the 1/4 corner common to Sections 10 and 11, T36SR3W, W.M., being a Bureau of Land Management brass cap monument, and a tie was computed to the most Northerly monument set on this survey.

Basis of bearings is a mean of 8 solar observations.

June 13, 1980

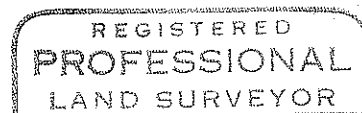
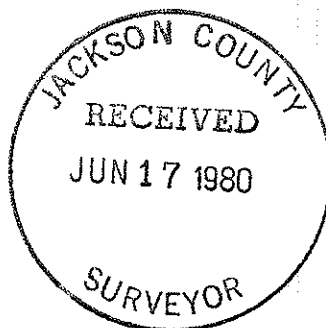

Gary D. Kaiser

