

SURVEY FOR: WESS INVESTMENTS

LOCATION: IN THE NW 1/4 OF SEC. 9, T. 39 S., R. 1 E.W.M., JACKSON COUNTY, OREGON.
 BASIS OF BEARINGS: R.S. 5996
 DATE: FEB. 28, 1980
 • MONUMENT FOUND
 () RECORD MEASUREMENT

REGISTERED
 PROFESSIONAL
 LAND SURVEYOR
 OREGON
 DARRYL W. EDWARDS
 741

JACKSON COUNTY
 RECEIVED
 APR 9 1980
 SURVEYOR

SURVEY NUMBER 8320

SURVEY NARRATIVE TO COMPLY WITH PARAGRAPH 209.250, OREGON REVISED STATUTES.

SURVEY FOR: Mess Investments % George Eshoo
346 E. Main St.
Ashland, Or. 97520

LOCATION: In the NW 1/4 of Sec. 9, T. 39 S., R. 1 E.M.M., in Jackson County,
Oregon.

PURPOSE: To locate and monument property boundaries of two (2) lots shown
on the attached map. Also, to locate existing improvements and
determine elevations on said lots.

PROCEDURE: Found SW Cor. of D.L.C. 42 and monuments set in R.S. 5996. Set
5/8" steel pins as shown on the accompanying plat and described
in Official Records.

BASIS OF BEARINGS: R.S. 5996

DATE COMPLETED: Feb. 28, 1980.

Darrel W. Edwards
P.O. Box 801
Rogue River, Or. 97537
Ph: 582-3110

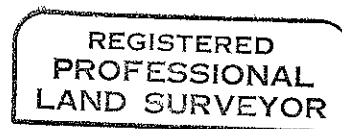
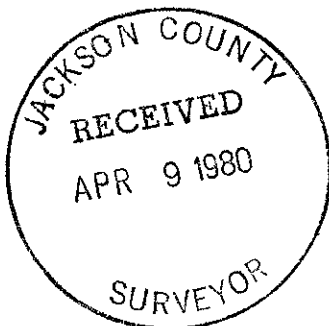

Darrel W. Edwards

