

BASIS OF BEARINGS: R.S. 5784

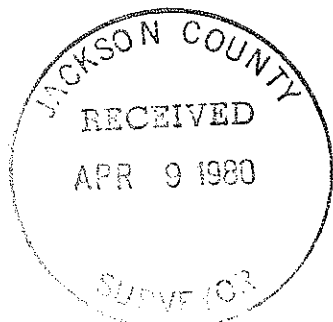

SURVEY FOR: SKEVINGTON & VAN HOY	
LOCATION: LOT 1, BLK. 7, CARNER & SABIN'S ADD. AND THE SW 1/4 SEC. 15, T. 36 S., R. 4 W.W.M., JACKSON COUNTY, OREGON.	
DATE: MARCH 20, 1980	REGISTERED PROFESSIONAL LAND SURVEYOR
SCALE: 1" = 50'	
● MONUMENT FOUND	<i>Darrel W. Edwards</i> OREGON JULY 8, 1968 DARREL W. EDWARDS 741
○ 5/8" STEEL PIN SET	
( ) RECORD MEASUREMENT	

(TL 1100) 30 4W 15 CC

SURVEY NO. 8319

SURVEY NARRATIVE TO COMPLY WITH PARAGRAPH 209.250, OREGON REVISED STATUTES.

SURVEY FOR: Skevington and VanHoy  
P.O Box 146  
Chiloquin, Or. 97624

LOCATION: Lot 1, Blk. 7, Carner and Sabin's Add. also being part of  
the SW 1/4 of Sec. 15, T. 36 S., R. 4 W.W.M. in Jackson  
County, Oregon.

PURPOSE: To monument a boundary line agreement for said parties.

PROCEDURE: Found 5/8" steel pins along the North line of lot 1. (see  
my survey No. 8249). Set 5/8" steel pins as shown on the  
accompanying plat.

BASIS OF BEARINGS: R.S. 5784

DATE COMPLETED: March 20, 1980.

Darrel W. Edwards  
P.O. Box 801  
Rogue River, Or.  
Ph: 582-3110

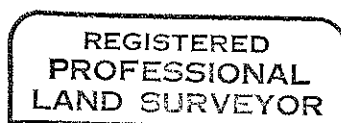
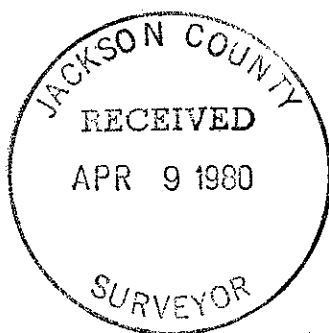

*Darrel W. Edwards*

