

36 NW 1500 8264

JACKSON COUNTY
RECEIVED
MAR 6 1980
SURVEYOR

SURVEY FOR: FLORENCE CAMPBELL	
LOCATION: LOT 3, BLK. 7, CARNER & SABIN'S ADD. TO THE CITY OF ROGUE RIVER, JACKSON COUNTY, OREGON.	
DATE: MAR. 4, 1980	REGISTERED PROFESSIONAL LAND SURVEYOR
SCALE: 1" = 50'	
() RECORD MEASUREMENT	Darrel W. Edwards OREGON JULY 9, 1958 DARREL W. EDWARDS 741
● MONUMENT FOUND	
○ 5/8" STEEL PIN SET	

SURVEY NO. 8264

SURVEY NARRATIVE TO COMPLY WITH PARAGRAPH 209.250, OREGON REVISED STATUTES.

SURVEY FOR: Florence Campbell
138 Cedar St.
Rogue River, Or. 97537

LOCATION: Lots 3 and 4, Blk. 7, Carner and Sabin's Add. to Woodville
(now Rogue River) and being a part of the SW 1/4 of Sec. 15,
T. 36 S., R. 4 W.W.M., in Jackson County, Oregon.

PURPOSE: To locate and monument property boundaries of Lot 3 and a portion
of Lot 4 as shown on the attached map and described in Official
Records.

PROCEDURE: Having done a survey of Lot 1 in this Block, I had already
proportioned the block. Set 5/8" steel pins as shown on the
accompanying plat.

BASIS OF BEARINGS: R.S. 5784

DATE COMPLETED: Mar. 4, 1980

Darrel W. Edwards
P.O. Box 801
Rogue River, Or. 97537
Ph: 582-3110

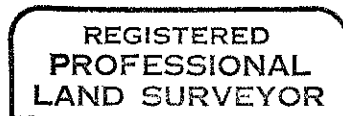

Darrel W. Edwards

