

SURVEY

IN:
 NE 1/4 of NW 1/4 of SEC. 15, T. 35 S., R. 4 W., W. M.,
 JACKSON COUNTY, ORE.

NOV. 12, 1979

For: C. H. Christiansen
 7901 E. Evans Creek Rd.
 Rogue River, Ore. 97537

By: R. E. Mason
 415 Surrey Dr.
 Grants Pass, Ore.



Scale: 1"=100'

- 5/8" X 30" IRON ROD SET
 - MONUMENT FOUND (5/8" Iron Rod except as Indicated)
- BEARINGS BASED ON SURVEY No. 4485

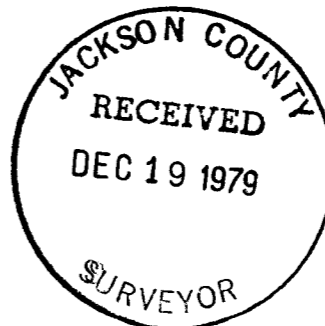

REGISTERED
 PROFESSIONAL
 LAND SURVEYOR

Robert Mason

OREGON
 JULY 22, 1974
 ROBERT MASON
 1011

SURVEY NARRATIVE

Survey in the Northeast Quarter of the Northwest Quarter of Section 15, Township 35 South, Range 4 West of the Willamette Meridian, Jackson County, Oregon.

Survey for: C. H. Christianson
7901 East Evans Creek Rd.
Rogue River, Ore.

Survey by: Robert Mason
415 Surrey Dr.
Grants Pass, Ore.

Purpose of survey: To locate and monument property according to description provided by Mr. Christianson.

Procedure: The survey was begun at the North Quarter Corner of Section 15. I then traversed the property according to the description. Monuments found marking the adjacent parcels, which are referred to in the description were used to determine the appropriate boundaries. Those monuments found and set are shown on the accompanying plat.

Survey completed November 12, 1979.

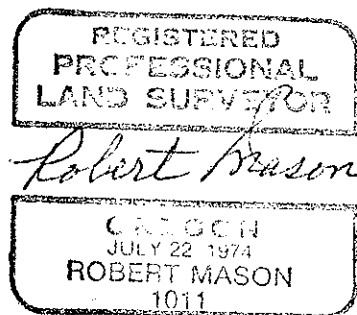
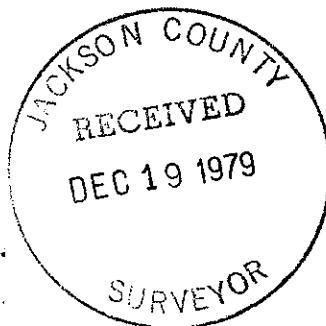

SURVEY NARRATIVE

8140

Survey in the Northeast Quarter of the Northwest Quarter of Section 15, Township 35 South, Range 4 West of the Willamette Meridian, Jackson County, Oregon.

Survey for: C. H. Christianson
7901 East Evans Creek Rd.
Rogue River, Ore.

Survey by: Robert Mason
415 Surrey Dr.
Grants Pass, Ore.

Purpose of survey: To locate and monument property according to description provided by Mr. Christianson.

Procedure: The survey was begun at the North Quarter Corner of Section 15. I then traversed the property according to the description. Monuments found marking the adjacent parcels, which are referred to in the description were used to determine the appropriate boundaries. Those monuments found and set are shown on the accompanying plat.

Survey completed November 12, 1979.

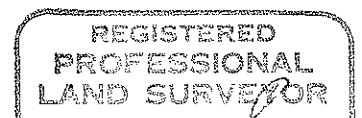
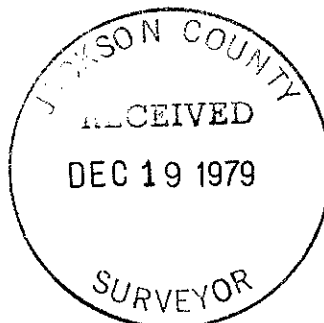

Robert Mason

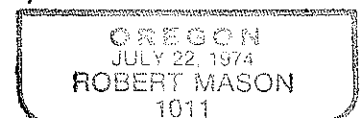

35 4W 15