

MAP OF SURVEY
LOCATED IN
N.W. 1/4 of Sec 14, T39S, R1E, W.M.
JACKSON COUNTY, OREGON
FOR

ORLIN R. CURTIS

HOFFBUHR SURVEYING, INC MEDFORD, OREGON

BY: RICHARD L. BATH PLS NO 1069
SCALE: 1" = 50' OCTOBER 22, 1979
BASIS OF BEARING: R/S No 8028

- ♣ = SET 5/8" x 24" IRON PIN TAGGED
R. BATH LS 1069
- ♣ = FD 5/8" IRON PIN per R/S No. 8028
TAGGED R. BATH LS 1069
- = FD. 5/8" IRON PIN per R/S No. 7876
TAGGED RLS 759

REGISTERED
PROFESSIONAL
LAND SURVEYOR

Richard L. Bath

OREGON
JULY 30, 1974
RICHARD L. BATH
No. 1069

SURVEY NO. 8063

SURVEY NARRATIVE TO COMPLY WITH PARAGRAPH 209.250
OREGON REVISED STATUTES

SURVEY FOR: Orlin R. Curtis
855 Clay Street
Ashland, Oregon 97520

LOCATION: Northwest one-quarter (1/4) of Section 14,
Township 39 South, Range 1 East, Willamette
Meridian, Jackson County, Oregon

PURPOSE: To correct the location of a 1 inch iron pipe and
1/2 inch iron pipe shown on Recorded Survey No.
8028

PROCEDURE: On October 18, 1979, Mr. Curtis informed me that
the line I had established for his North property line per Recorded
Survey No. 8028 was not parallel with the South line of his property
per Recorded Survey No. 7876 when, in fact, the two lines should
be parallel. A field inspection on October 19, 1979, found an angle
"bust" to a random traverse point resulting in the improper posi-
tioning of the Northwest corner of Mr. Curtis's property. This
error was corrected, the monument readjusted to its true position,
and the resulting positions of the two pipes are shown on the
accompanying map.

October 25, 1979

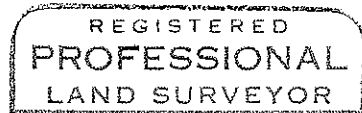
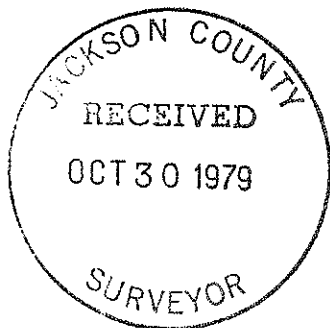

Richard L. Bath

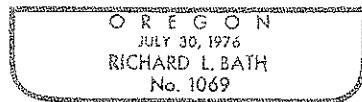

Richard L. Bath
Hoffbuhr Surveying, Inc.