

CHERRY TREE CONDOMINIUM

DECLARATION see O.R. No. 79-12565

SITUATED IN LOTS 8 & 9, BLK. 2 OF NORTHWOOD PARK SUBDIVISION
D.L.C. NO. 41, N1/2 OF SEC. 9, TWP. 38S., R. 1 W. W. M.
JACKSON COUNTY OREGON

DECLARATION

KNOW ALL MEN BY THESE PRESENTS, that Crystal Mountain Construction Company, is a duly organized corporation of the State of Oregon, does hereby make, establish and declare the annexed map to be a true and correct map of the land owned and laid out by Crystal Mountain Construction Company as "CHERRY TREE CONDOMINIUM". Said land being more particularly described in the Surveyor's Certificate hereunto annexed and Crystal Mountain Construction Company does hereby commit said land to the operation of the condominium law as set forth in Chapter 91 of the Oregon Revised Statutes.

IN WITNESS WHEREOF, Crystal Mountain Construction Company, an Oregon corporation, pursuant to a resolution of its Board of Directors, duly and legally adopted, has caused these presents to be signed by its officers and its corporate seal to be affixed this 1st day of June, 1979

John P. Hansen President
Ruth L. Hansen Secretary

STATE OF OREGON ss
County of Jackson

June 1 A.D. 1979

Personally appeared the above named John P. Hansen, President and Ruth L. Hansen, Secretary of Crystal Mountain Construction Company, an Oregon corporation, and acknowledged the foregoing instrument to be their voluntary act and deed.

Before me:

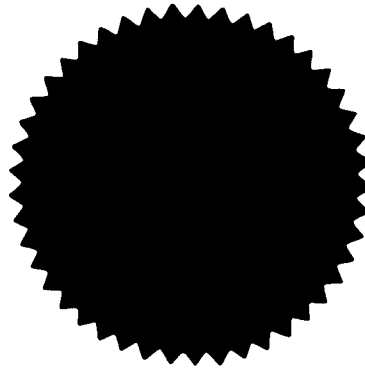

Britt S. Barnes
Notary Public for Oregon
My Commission expires 5-6-83

APPROVAL

I hereby certify that all ad valorem taxes and all special assessments, fees and other charges required by law which will become a lien during the 1979 calendar year have been paid.
Date: 6-15-79

Ray Stewart Director of Assessment & Taxation
Helen Merdox Deputy

Filed for record this the 20th day of June, 1979, at 9:29 o'clock A. M.
and recorded in Volume 13 of plats at page 86 of Records of Jackson County, Oregon.

Halden Terry County Clerk
Ruby A. Paking Deputy

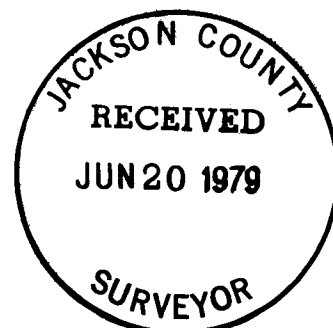

SURVEYOR'S CERTIFICATE

STATE OF OREGON ss
County of Jackson

I, Everett L. Swain, duly Registered Professional Land Surveyor of the State of Oregon, being duly sworn, do hereby certify that I have correctly surveyed and marked with the proper monuments as provided by law the tract of land hereon shown and the following is an accurate description of the boundary lines: _____

Commencing at a found 8 inch diameter concrete post with a bronze disk situated at the initial point of Northwood Park Subdivision, as now recorded, which bears South, 1,215.485 feet and East, 1,855.885 feet from a 1 inch galvanized iron pipe situated at the Northwest corner of Donation Land Claim No. 41, Section 9, Township 38 South, Range 1 West of the Willamette Base and Meridian, Jackson County, Oregon; thence South 45°34'42" East (deed record South 45°39' East, 100.00 feet) along the Northeasterly right of way of the relocated Highway No. 99, 100.27 feet to the Southwest corner of said subdivision, as now recorded; thence leaving said right of way, North 87°12'18" East (deed record North 87°08' East) along the Southerly boundary line of said subdivision, 863.49 feet to a 5/8 inch iron pin situated at the Southwest corner of Lot 8, Block 2 of said subdivision; thence leaving said Southerly boundary line North 01°36'00" West along the lot line common to Lots 7 and 8 of Block 2 of said subdivision, 116.28 feet to a 6 inch diameter by 24 inch long concrete post with a 3 inch diameter bronze disk situated in the Southerly right of way of Northridge Terrace for the initial point of CHERRY TREE CONDOMINIUM; thence North 88°24'00" East along said Southerly right of way, 124.66 feet to a 5/8 inch iron pin situated at the Northeast corner of Lot 9, Block 2 of said recorded subdivision; thence leaving said right of way South along the Easterly boundary line of Lot 9, Block 2 of said subdivision, 113.79 feet to a 5/8 inch iron pin situated at the Southeast corner of Northwood Park Subdivision, as now recorded; thence South 87°12'18" West (deed record South 87°08' West) along the Southerly boundary line of said subdivision 121.515 feet to a 5/8 inch iron pin situated at the lot corner common to Lots 7 and 8, Block 2 of said subdivision; thence leaving said Southerly boundary line North 01°36'00" West along the lot line common to said Lots 7 and 8, Block 2, 116.28 feet to the initial point.

Subject to easements and rights of way of record.

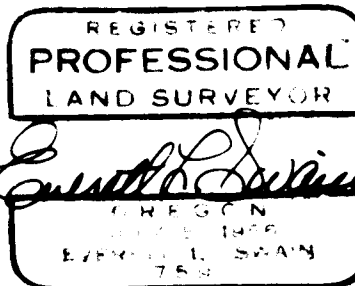

Subscribed and sworn to before me this 15th day of May, 1979.

Everett L. Swain
Surveyor

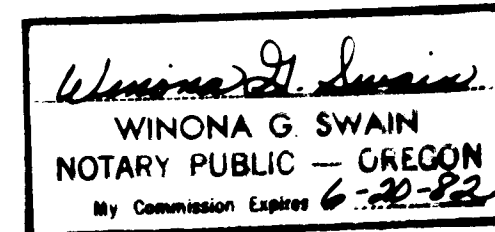

Winona G. Swain
Notary Public for Oregon
My Commission expires 6-20-82

I certify these plans depict the layout of the units in the buildings as constructed in CHERRY TREE CONDOMINIUM and ^{SUBSTANTIALLY} completed on 1 day of JUNE, 1979

Subscribed and sworn to before me this 1 day of June, 1979

Ray W. Menden
ARCHITECT

Ray W. Menden
Notary Public for Oregon
My Commission expires 5-6-83

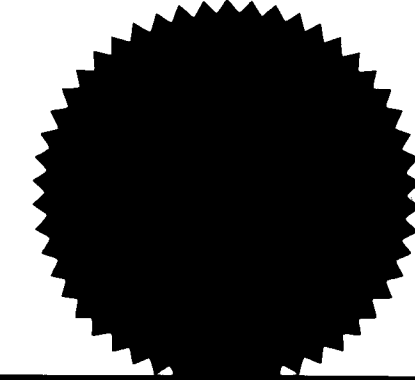

0282

8R(46)

PARK CHERRY TREE CONDOMINIUM

SITUATED IN LOTS 8 & 9, BLK. 2 OF NORTHWOOD PARK SUBDIVISION
D.L.C. NO. 41, N 1/2 OF SEC. 9, TWP. 38S., R. 1 W.W.M.
JACKSON COUNTY OREGON

DECLARATION see O.R. No. 79-12515

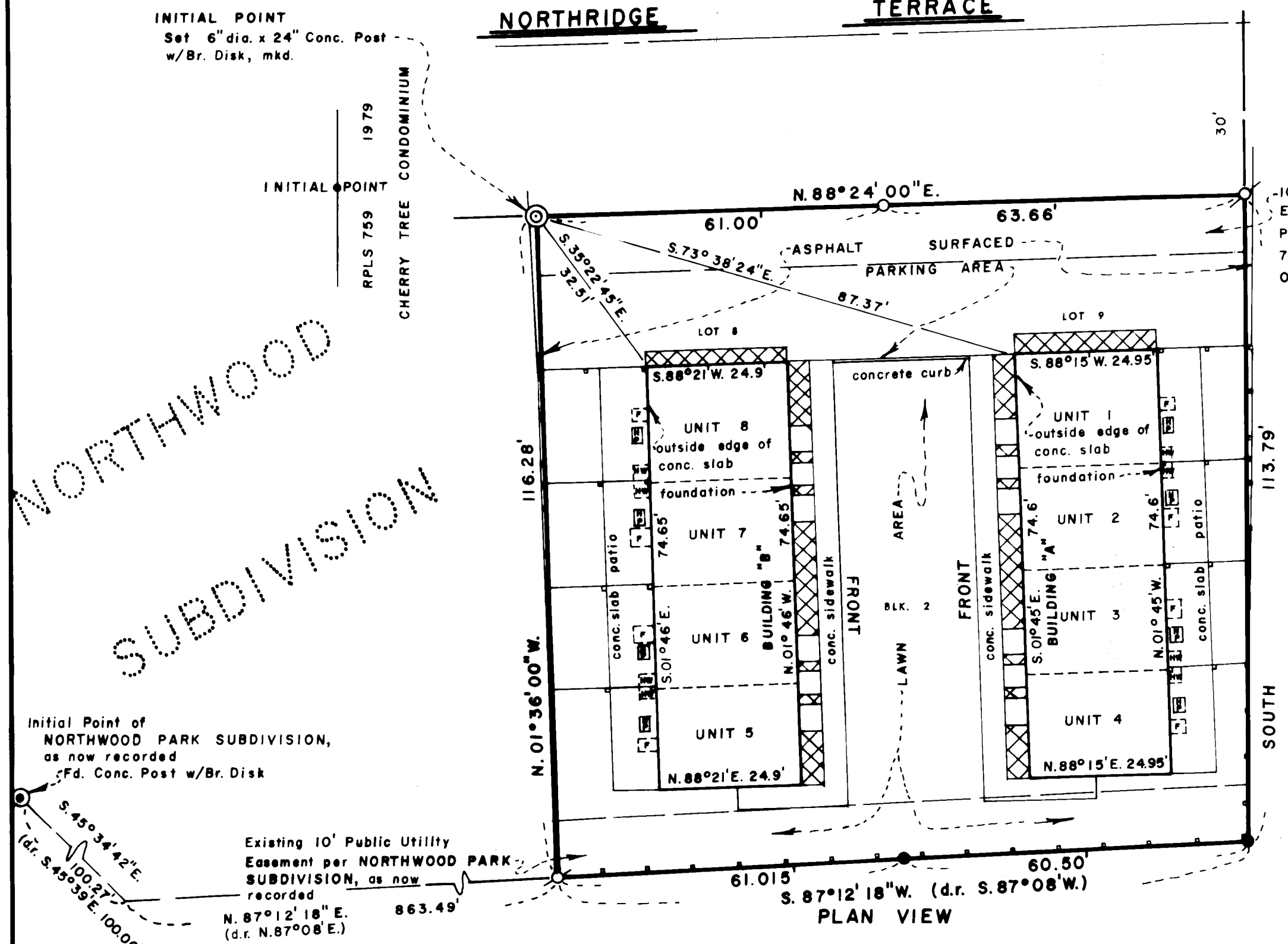

NORTH

SCALE: 1" = 20'
BASIS OF BEARING:
RECORDED SURVEY NO. 2521

LEGEND:

- Found 5/8 inch Iron Pin unless otherwise shown
- Set 5/8 x 24 inch Iron Pin tagged RLS 759
- Set 5/8 x 30 inch Iron Pin tagged RLS 759 unless otherwise shown
- 4 x 4" Redwood Fence Post w/1"x4" vertical Cedar Fencing
- ⊠ Planter PLAN VIEW ONLY
- ⊞ Heat Pump
- ⊞ Proposed Hot Water Heater Enclosure
- ⊞ Proposed Furnace Enclosure

ELEVATION DATUM:

Found 3.5" Br. Disk in Concrete Headwall of 30" C.M.P. under Southern Pacific Railroad tracks, Phoenix, Oregon; mkd:
UNITED STATES COAST & GEODETIC SURVEY
BENCH MK #X-6
1920
ELEV. 1482.563

NOTE: See 1956 adjustment of U.S.C. & G.S. line #6 - Portland to Weed; Rogue River to Ore./Calif. State line.
ADJUSTED ELEV. = 1483.130
used per this survey

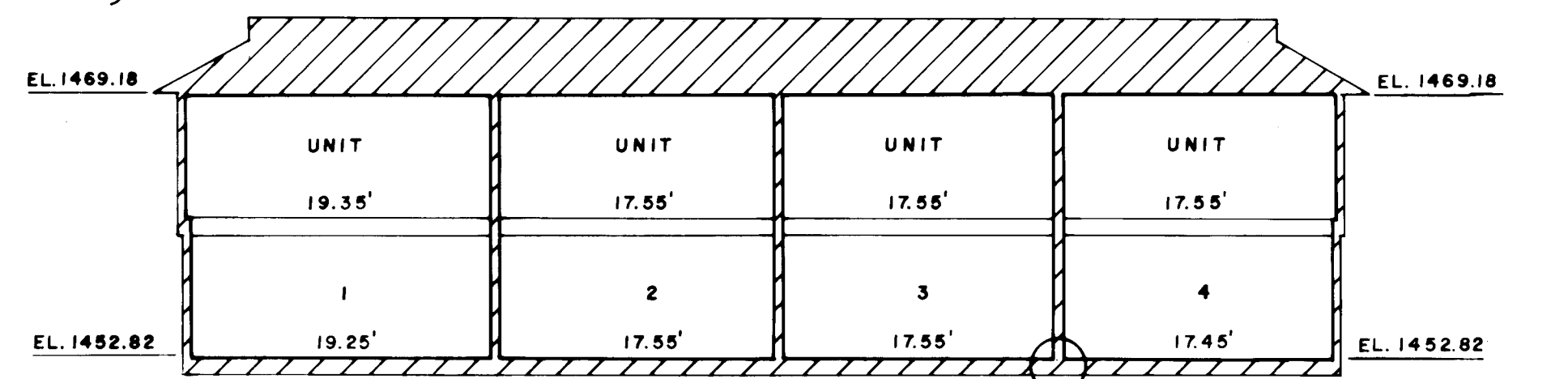

FRONT VIEW Scale: 1" = 10' BUILDING "A"

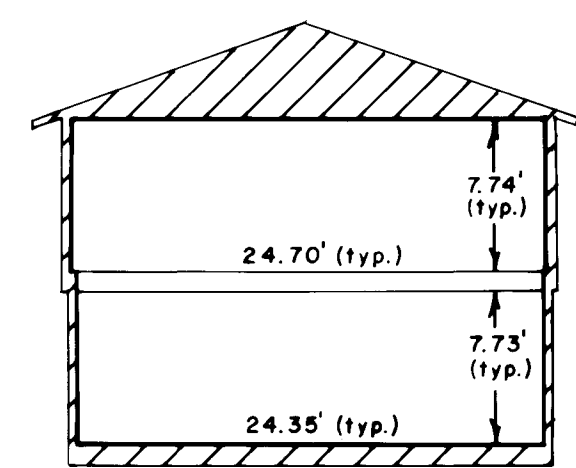

END VIEW Scale: 1" = 10'

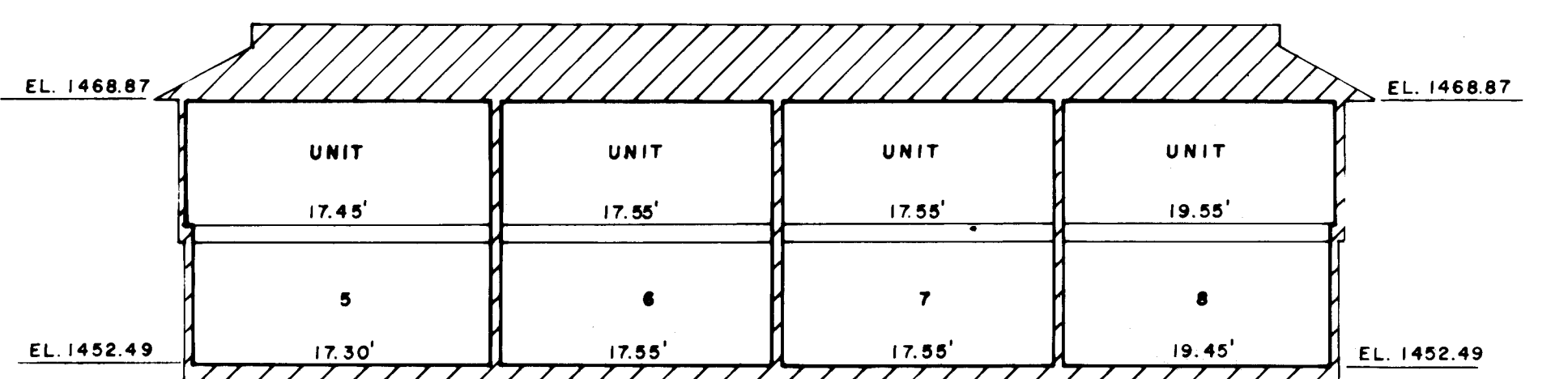

FRONT VIEW Scale: 1" = 10' BUILDING "B"

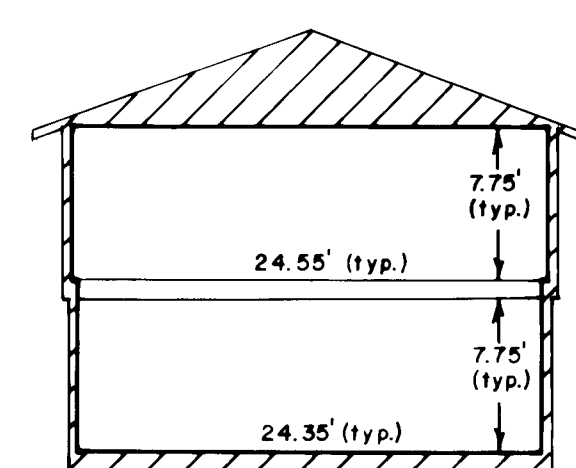

END VIEW Scale: 1" = 10'

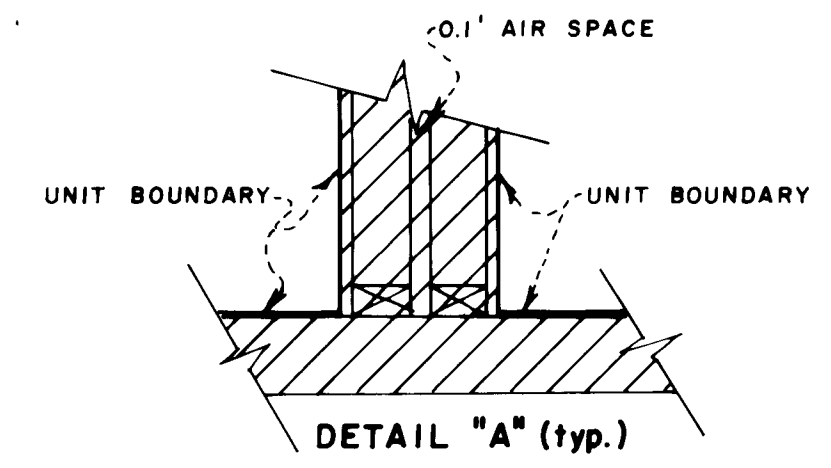

DETAIL "A" (typ.)
GENERAL COMMON AREA BETWEEN ADJACENT UNITS
no scale

REGISTERED
PROFESSIONAL
LAND SURVEYOR
South Bureau
OREGON
JULY 8, 1966
EVERETT L. SWAIN
759

JACKSON COUNTY
RECEIVED
JUN 20 1979
SURVEYOR