

MAJOR LAND PARTITION

LOCATED IN THE S.W. 1/4 OF SECTION 28 & THE N.W. 1/4 OF SECTION 33, T. 34 S., R. 1 E., W. M., JACKSON COUNTY, OREGON

OWNER'S DECLARATION

I, SAMUEL C. INKLEY, HEREBY DECLARE THAT I AM THE OWNER IN FEE SIMPLE OF THE LAND SHOWN HEREON AND THAT I HAVE CAUSED SAID LAND TO BE SURVEYED AND MAPPED FOR THE PURPOSE OF CREATING A PRIVATE ROAD TO PROVIDE ACCESS TO PARCELS NUMBERED 1, 2 AND 3 AS SHOWN HEREON.

Samuel C. Inkley
SAMUEL C. INKLEY

STATE OF OREGON S.S.
COUNTY OF JACKSON
BEFORE ME THIS 11 DAY OF June, 1979, PERSONALLY APPEARED THE ABOVE NAMED SAMUEL INKLEY, AND ACKNOWLEDGED THE FOREGOING INSTRUMENT TO BE HIS VOLUNTARY ACT AND DEED.

Claudia M. Murphy
NOTARY PUBLIC FOR OREGON
MY COMMISSION EXPIRES 6-30-79

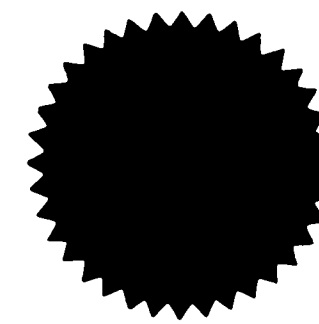

APPROVAL:

APPROVED BY THE JACKSON COUNTY HEARINGS COUNCIL.

BY *Karl M. Nelson* DATE: 6/7/79

SURVEYOR'S CERTIFICATE:

I, LOYD R. MOFFIT, REGISTERED PROFESSIONAL LAND SURVEYOR OF THE STATE OF OREGON, CERTIFY THAT THIS MAP CORRECTLY REPRESENTS A SURVEY MADE BY ME OR UNDER MY DIRECTION IN CONFORMANCE WITH THE REQUIREMENTS AND REGULATIONS OF THE STATE OF OREGON.

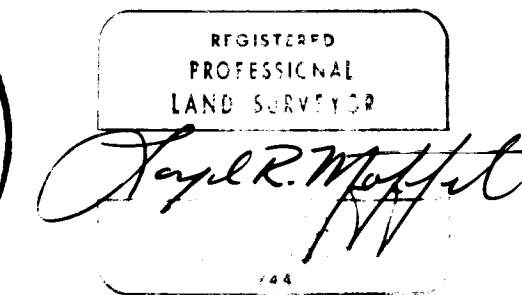
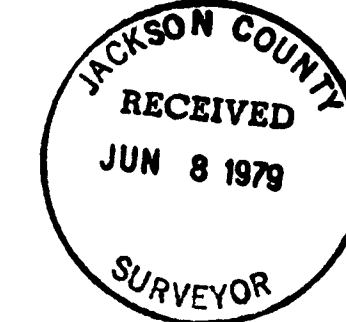

RECORDER'S CERTIFICATE:

FILED FOR RECORD THIS 8 DAY OF June, 1979, AT 1:57 O'CLOCK P. M. AND RECORDED IN VOLUME 1 AT PAGE 661 OF "MAJOR LAND PARTITIONS" IN JACKSON CO, OREGON

Waldene Terry COUNTY CLERK *Betty King* DEPUTY

PREPARED BY:

FRIAR-MOFFIT SURVEYING CO.
721 WEST TENTH STREET
MEDFORD, OREGON 97501

DATE: MAY, 1979
SCALE: 1" = 200'

BASIS OF BEARINGS: SURVEY NO. 6725

LEGEND:

- = SET 5/8" PIN WITH PLASTIC CAP STAMPED, MOFFIT PLS 944
- = FD. 5/8" PIN
- = FD. MONUMENT AS SHOWN

