

# ATWATER PARK SUBDIVISION

LOCATED IN THE  
S. E. 1/4 SECTION 8, TOWNSHIP 37 SOUTH, RANGE 1 WEST, W. M.  
CITY OF MEDFORD  
JACKSON COUNTY, OREGON

79-02764

## POST MONUMENTATION PLAT

- Monument Per Original Subdivision Plat
- Set 5/8" X 24" Iron Pin
- ✕ Set 5/8" X 30" Iron Pin
- ◎ Street Monument With Brass Disc

I, Verlyn Thomas, a duly Registered Surveyor of the State of Oregon, do hereby certify that this map represents a survey made by me or under my direction and the monuments conform to O.R.S. 92.060.

Examined and approved this 8<sup>th</sup> day of February, 19 79.

LDC Walker  
City Engineer

Filed for record this 8 day of February, 19 79 at 10:11 O'clock A M.

and recorded in the Official Records of Jackson County, Oregon.

Walton Terry County Clerk      Wanda Baker Deputy

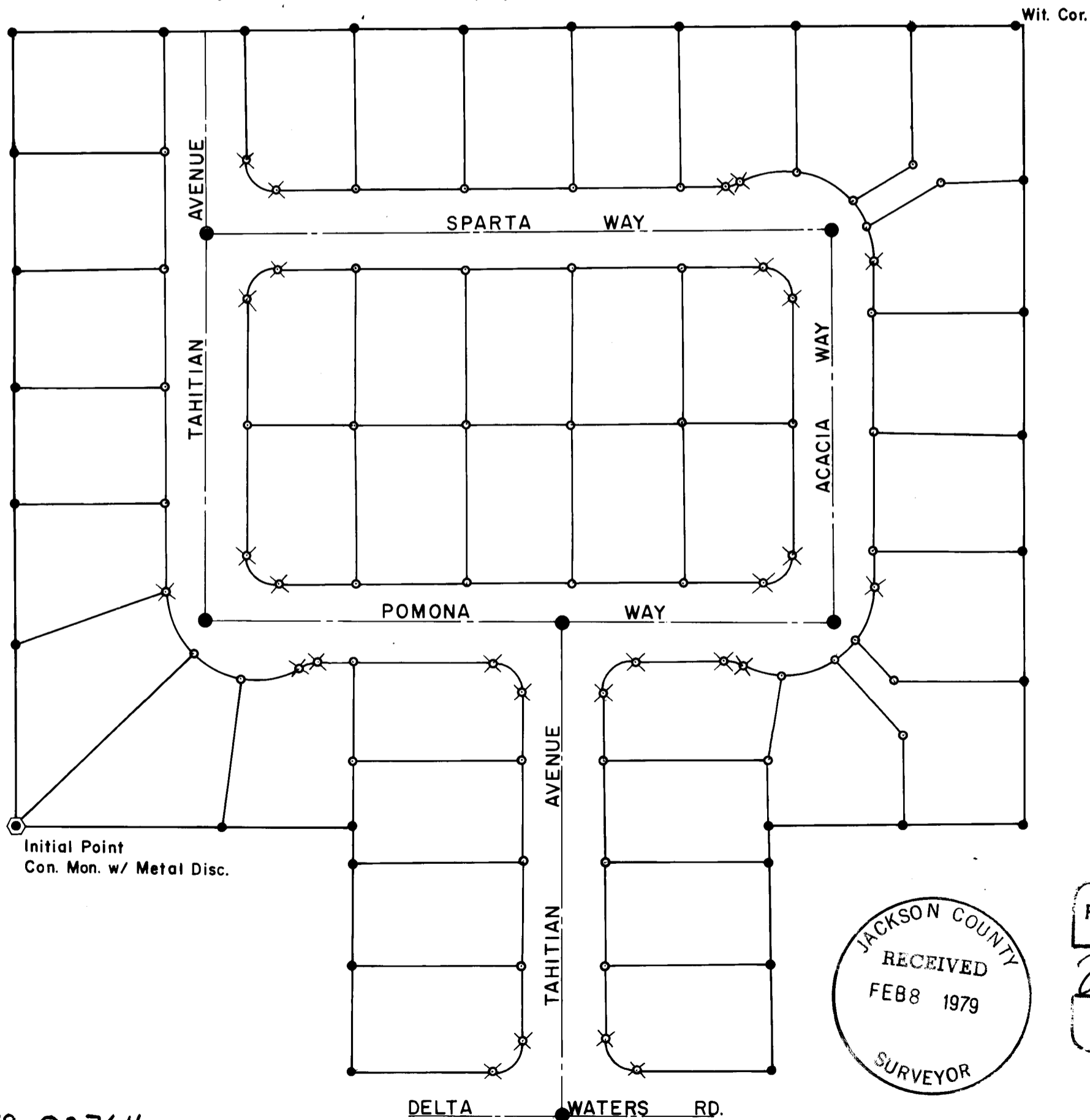

79-02764

S8DC 37 1W

7635