

LEGEND:
 ● = FOUND 3/4" IRON PIN
 ○ = SET 5/8" IRON PIN WITH PLASTIC CAP, STAMPED, FRIAR 961

BASIS OF BEARINGS:
 SURVEY NO. 6214

REGISTERED
PROFESSIONAL
 LAND SURVEYOR

Larry J. Friar

OREGON
 JULY 18, 1971
 LARRY J. FRIAR
 961

JACKSON COUNTY
 RECEIVED
 JAN 30 1979
 SURVEYOR

PLAT OF SURVEY
 FOR
KAY PHILIPS

LOCATED IN THE SOUTH 1/2 OF SECTION 35,
 TOWNSHIP 36 SOUTH, RANGE 4 WEST, W.M.
 JACKSON CO. SCALE: 1" = 100'
 OREGON DATE: NOV., 1978
 PREPARED BY: FRIAR - MOFFIT SURVEYING CO.
 MEDFORD, OREGON

(3900) S35 36 4W

SURVEY NARRATIVE FOR KAY PHILIPS
PAGE 2

A PORTION OF THE FENCE LINE WHICH WAS DECREED BY THE COURT TO BE THE BOUNDARY LINE IS STILL EXISTING, THIS LINE WAS PRODUCED NORTHERLY TO INTERSECT THE NORTH LINE OF THE S.E. ONE QUARTER (1/4) OF SECTION 35, WHICH IS THE LIMIT OF THE CLIENT'S OWNERSHIP.

BY USING REFERENCES, IN VOLUME 171, PAGE 198, J.C.D.R., TO LOT CORNERS OF THE CHAMPLIN SUBDIVISION, I WAS ABLE TO ARRIVE AT A MATHEMATICAL LOCATION OF THE CALLED FOR IRON POST IN SAID DEED WHICH MATCHES THE PHYSICAL LOCATION OF A FOUND 6" DIA. IRON POST. THIS IRON POST WAS THE POINT OF BEGINNING OF THE 400' WIDE PARCEL OF LAND DESCRIBED IN VOLUME 232, PAGE 217, J.C.D.R., THIS WORK WAS ACCOMPLISHED IN ORDER TO DETERMINE THE RELATIONSHIP OF THE FENCE LINE (PROJECTION) AND THE DEED LINE AS SHOWN ON THE ATTACHED MAP.

THE CONTROL USED FOR THIS SURVEY WERE ORIGINAL MONUMENTS OF THE CHAMPLIN SUBDIVISION, MONUMENTS REFERENCED AND RESET BY THE COUNTY ROAD DEPARTMENT, AND MONUMENTS SET ON PRIVATE SURVEYS AS SHOWN ON THE ATTACHED MAP.

DATE: JANUARY 18, 1979

LARRY J. FRIAR
FRIAR - MOFFIT SURVEYING CO.

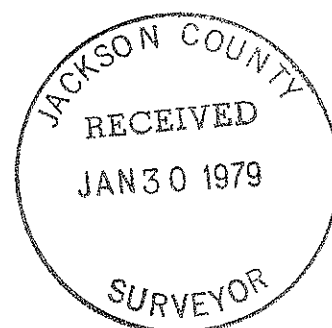
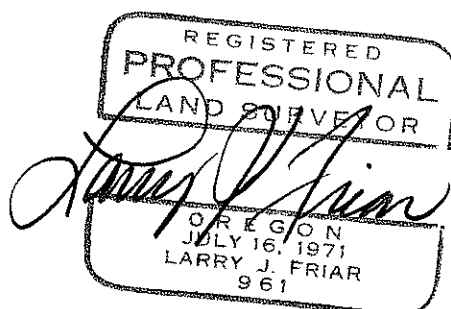

SURVEY NO. 7616

SURVEY NARRATIVE TO COMPLY WITH O.R.S. 209.250

SURVEY FOR: KAY PHILIPS
1549 S. IVY STREET
MEDFORD, OREGON 97501

LOCATION: SOUTH ONE-HALF (1/2) OF SECTION 35,
TOWNSHIP 36 SOUTH, RANGE 4 WEST,
WILLAMETTE MERIDIAN, JACKSON COUNTY,
OREGON.

PURPOSE: TO SURVEY AND MONUMENT CLIENT'S
PROPERTY AS SHOWN ON THE ATTACHED
MAP.

PROCEDURE: THE EAST LINE OF THE SUBJECT PARCEL
WAS FIRST DESCRIBED IN VOLUME 232,
PAGE 217, J.C.D.R. THIS DESCRIPTION
BEGAN AT THE SOUTHEAST CORNER OF THAT
CERTAIN TRACT DESCRIBED IN VOLUME 171,
PAGES 198 AND 199 OF J.C.D.R.; THENCE
RAN SOUTH ALONG THE WEST LINE OF
FOOTS CREEK ROAD A DISTANCE OF 592.6
FEET TO AN IRON POST ON THE WEST LINE
OF THE COUNTY ROAD, THE PLACE OF
BEGINNING OF THE DESCRIPTION; THENCE
SOUTH ALONG THE WEST LINE OF THE
COUNTY ROAD 833.0 FEET; THENCE WEST
400 FEET TO THE WEST BANK OF FOOTS
CREEK; THENCE NORTH 833.0 FEET;
THENCE EAST 400 FEET TO THE PLACE OF
BEGINNING. THE CALL IN THE DESCRIPTION,
"TO THE WEST BANK OF FOOTS CREEK,"
CAUSED A CONTROVERSY OVER THE LOCATION
OF THE LINE WHICH ENDED IN A COURT
DECISION ON AUGUST 2, 1954, IN WHICH
THE FINDING WAS IN FAVOR OF THE
DEFENDANT, THE CLIENT'S PREDECESSOR,
THAT HE HAD ACQUIRED TITLE AND OWNERSHIP
BY ADVERSE POSSESSION, ALL OF THE
PROPERTY LYING WESTERLY OF A NORTH-SOUTH
FENCE LINE SITUATED ON SAID PROPERTY
APPROXIMATELY 400 FEET WEST OF THE
FOOTS CREEK COUNTY ROAD.

