

7607

Fd. 3/4" I. Pipe
in mon. case

5th ST.

100.72 P.P.

S 89° 50' 54" E

383.56

6th ST.
Fd. 3/4" I. Pipe
in mon. case

44.62

S 82° 12' 23" E

7th ST. F-2

EAST MAIN STREET

250.85

42.39

30.00

Tract desc. in Doc. No. 78-27217
O.R. J.C.O.

38,632 SQ. FT.

AGREEMENT BOUNDARY
Re: Doc. No. 79-00085 O.R.

CEMETARY

SAFEWAY STORES INC.

S 89° 46' 48" E

274.36

S 0° 10' 55" W
136.28

N 8° 13' 26" E
132.28

S 0° 18' 06" W

442.86

SHERMAN STREET

R/W according to existing
street improvements

City Engr. 1911 & per Bk. 19 Pg. 12

S 0° 10' 55" W

SHERMAN STREET

SISKIYOU BLVD.

20' N 89° 49' 05" W
Fd. 1" I. Pipe

LEGEND

- = Set 5/8" x 24" I. Pin (tagged R.L.S 638)
- = Found mon. as noted
- A = Fd. 3/4" I. Pipe N 48° 23' E 0.30
- B = Fd. 3/4" I. Pipe N 32° 53' E 0.30
- C = Fd. 3/4" I. Pipe N 30° 51' W 0.50
- D = Fd. 3/4" I. Pipe N 8° 13' 26" E 0.17

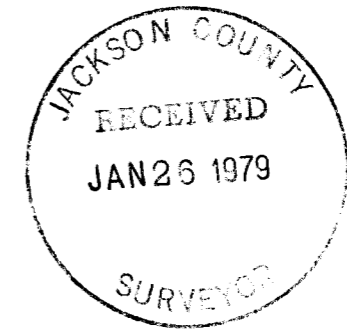

MAP OF SURVEY

Located in lots 9, 10, 11 and 12 of Mc Calls
Addn. to the City of Ashland in sec. 9T39S
R1E

For: W.H. HAMPTON III
By: Geo. Burrell, Surveyor, Dec. 1978

REGISTERED
PROFESSIONAL
LAND SURVEYOR

George Burrell

OREGON
JULY 10, 1964
GEORGE R. BURRELL
638

(14100) 59 AC 39 1 E

7607

2092

SURVEY NARRATIVE TO COMPLY WITH O.R.S. 209.250

For: W.H. Hampton
Attorney
P.O. Box 627
Ashland, Oregon

Purpose: To monument the tract described in document no. 78-27217 of the Official Records of J.C.O.

Proceedure: The City monuments found along the center of East Main Street were held as control for the Southerly right of way of said street. The Easterly boundary of said tract being uncertain due to lost deed control monuments for the adjoining Cemetary property, was established by agreement with the City of Ashland and the client.

The Southerly boundary of said tract was established by holding record distance Southerly from the Southerly right of way of East Main Street. The found monuments as shown on the accompaning map were not used in control in establishing said Southerly boundary. These found monuments were all tagged R.S.298 (survey unrecorded) and were not called for in deed descriptions.

As the right of way of Sherman Street was deeded to the City of Ashland bounded by the boundaries of lot 8 of the Mc Call Addn., and as a proportional reestablishment of said Addn. using found monuments along the center of East Main and Siskiyou Blv. would disagree with the present lot and street improvements, and whereas City Engr. Mc Kissick in 1911 established the center of Sherman Street at the time of said street construction, and whereas Mc Kissick's position for the center of East Main and Sherman is in proportional agreement with Mc Calls Addn. along East Main Street, it was concluded that Mc Kissick's position for the center of East Main and Sherman Streets is the better evidence, and was so adopted.

Mc Kissick's position for the center of Sherman Street South of East Main does not agree with the 1" iron pipe found at the S.W. cor. of Sherman and Siskiyou Blvd. set by F.H. Walker in 1916. However, using Walker's pipe and Mc Kissick's position at East Main Street results in a position that is in accord with the present street improvements, and was adopted as a practical location for Sherman Street. To avoid a possible hiatus, the client proposes to Quit Claim title lying West of the street line monumented by this survey.

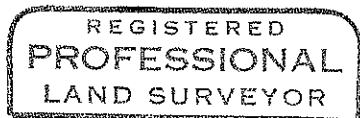
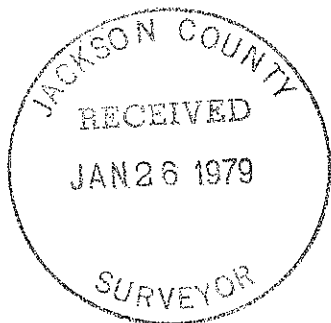

George Burrell

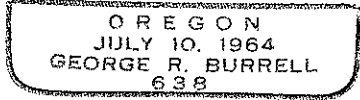

(14100) 9 AC 39 1E