

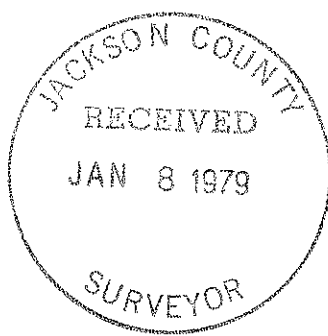

7580

7580

**SURVEY FOR JACK DEAL**  
 IN SEC. 21, T. 36 S., R. 3 W., W. M.  
 GOLD HILL, OREGON  
 AUGUST 10, 1978



  
 SCALE: 1" = 40'  
**LEGEND**  
 ○ Found Mon., As Noted  
 ● 5/8" X 24" I. Pin Set

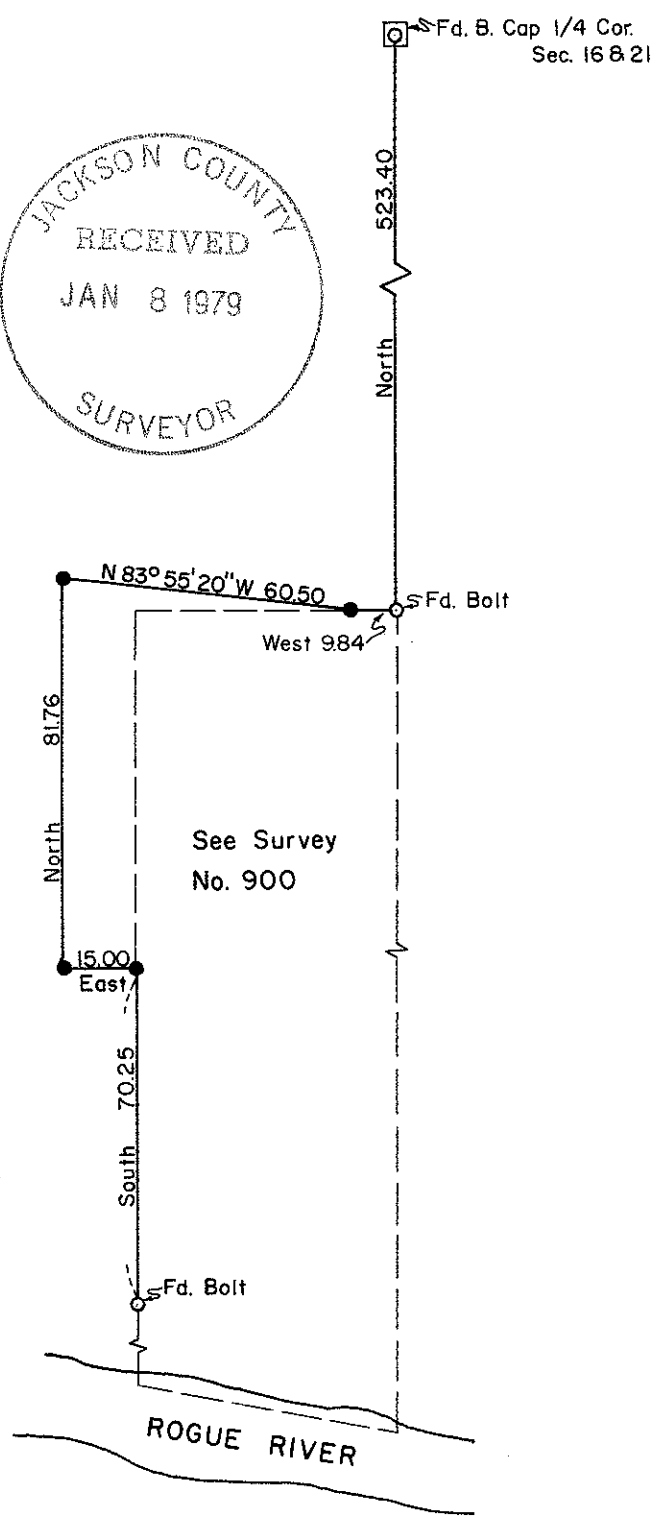

REGISTERED  
 PROFESSIONAL  
 LAND SURVEYOR  
*Verlyn Thomas*  
 OREGON  
 MAY 13, 1960  
 VERLYN D. THOMAS  
 505

(T.L. 200) S21 B 36 3W 7580

SURVEY BY VERLYN THOMAS, PROFESSIONAL LAND SURVEYOR, MEDFORD, OREGON

SURVEY NO. ~~7580~~  
7580

SURVEY NARRATIVE TO COMPLY WITH O.R.S. 209.250

SURVEY FOR: Jack Deal  
1432 Second Avenue  
Gold Hill, Oregon

PURPOSE: To establish a new division line between client's parcel and  
School District 6C property.

PROCEDURE: Conducted a random traverse from the  $\frac{1}{4}$  corner between Sections  
16 and 21, tying in monuments set by Recorded Survey No. 900,  
fences, existing buildings, etc., and established a mutually  
agreeable boundary between parties involved. Prepared appro-  
priate legal description.

Basis of Bearings: Survey No. 900.

