

7577
7577

SURVEY FOR CITY OF ASHLAND

N.W. 1/4 OF SEC. 13, T.39S., R.1E., W.M.
JACKSON COUNTY, OREGON
AUGUST 11, 1978

7577
2292

11 12
14 13 B. Cap



SCALE: 1" = 400'

LEGEND

- Found Monument, as noted
- 5/8" X 24" I. Pin Set

BASIS OF BEARINGS: Survey No. 2213

N 0° 02' 10" E

1220.00

S 44° 46" E

1724.77

(Rec. 1718 M/L)

1215.40 (Rec. 1210 M/L)

N 89° 47' 07" W

B. Cap

N. W. Cor. D.L.C. 54

3/4" I. Pin
N. E. Cor. D.L.C. 54

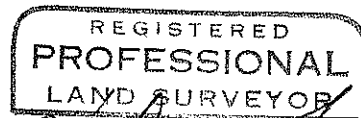
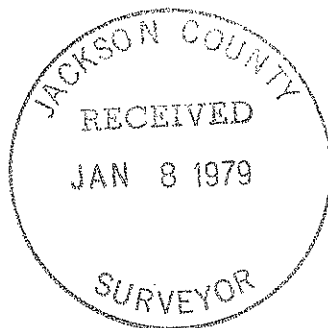

Verlyn Thomas

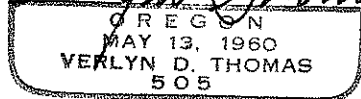

(T.L. 2300) 13B 391E

SURVEY BY VERLYN THOMAS, PROFESSIONAL LAND SURVEYOR, MEDFORD, OREGON

7577

7577

7897

Survey No. 7897

SURVEY NARRATIVE TO COMPLY WITH O.R.S. 209.250
REVISED BY CHAPTER 555, O.L. 1963

FOR: City of Ashland
City Hall
Ashland, Oregon.

PURPOSE: To survey and monument a property line as described in Tract B,
Volume 553, page 87 of the Deed Records of Jackson County, Ore-
gon.

PROCEDURE: Conducted a random traverse from the corner common to sections
11, 12, 13, and 14, to the Northwest corner of Donation Land
Claim No. 54, and thence to the $\frac{3}{4}$ " iron pin accepted as being
the Northeast corner of said claim 54 as established by McCall
February 4, 1906, see City of Ashland field book "E", page 32.

Linear measurements by tellurometer, and angles turned with
a Wild T1-AE theodolite.

At the corner established North $0^{\circ} 02' 10''$ East 1220.00 feet
from the Northwest corner of D.L.C. 54, found a $\frac{5}{8}$ " iron pin bear-
ing South 0.21 feet, and East, 0.06 feet.

At the corner established South $89^{\circ} 47' 07''$ East, 1215.40
feet from the Northwest corner of said D.L.C. 54, found a $\frac{5}{8}$ " iron
pin bearing North 8.82 feet, and West, 5.85 feet.

