



7528

SURVEY NARRATIVE TO COMPLY WITH PARAGRAPH 209.250

OREGON REVISED STATUTES

Survey for: Robert L. Anderson  
300 Luman Road  
Phoenix, Oregon 97535

Survey by : Charles H. Hurst, L.S.  
304 South Holly  
Medford, Oregon 97501

Purpose : To locate the northeast corner of the tract shown  
being 15 feet South of the northeast corner of  
Lot 6, Block 3 of Siskiyou Heights Addition.

Procedure

The easterly line of Block 3 was measured and the pin location on the original block line was determined by proportion utilizing existing monumentation.

The pin set on the east line of Survey No. 955 should be considered subject to some degree of shift inasmuch as the client was of the opinion further survey work was not economically justifiable at this time.

Existing survey control along the north line of Woodlawn Drive appears to have been reestablished on the basis of adjacent original monumentation.

The record location for the north line of the tract shown falls 1.87 feet North of the line as monumented by this survey.

Field angles observed or computed are shown in lieu of bearings.

June 16, 1978

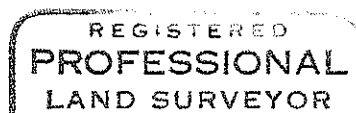
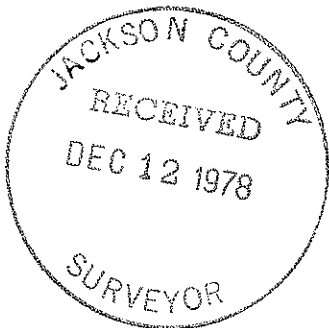

*Charles H. Hurst*

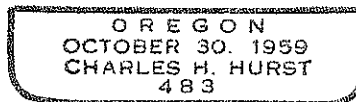

(T.L. 2200) S29BC 37 IW