



L7518

SURVEY NARRATIVE TO COMPLY WITH PARA. 209. 250 O.R.S.

SURVEY FOR: Marie Hall  
2308 N. Hillcrest Ave.  
Los Angeles, CA 90027

LOCATION: The Northwest Quarter of Section 13, Township 36 South,  
Range 4 West, Willamette Meridian, Jackson County, OR.

PURPOSE: To survey and monument two 5 acre tracts as shown on  
attached plat.

PROCEDURE: I found record monuments with respective bearing objects  
for section corner common to Section 11, 12, 13 and 14,  
and the North 1/16th Corner. I used a found 3/4-inch  
galvanized iron pipe set per "Highland Meadows"  
subdivision for control between said section corner and  
the North Quarter corner of section 13. Found Jackson  
County Road Department P.K. nails set in the center line  
of Wards Creek Road which controlled road location.  
Using said control I set 5/8-inch diameter iron rods at  
positions shown on plat. Witness corners were set on  
high bank of Wards Creek to reference actual corner location.

Survey was executed with a Wild T-16E Theodolite and a  
Beetle 1000 E.D.M.

SURVEYOR: Robert B. Wiegand, P.L.S.  
211 N.E. Beacon Drive  
Grants Pass, OR 97526  
November 7, 1978

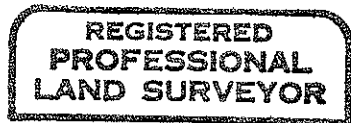

*Robert B. Wiegand*

