

R/S 270

FD. 3/4" IRON PIPE EXPOSED 4"

MAP OF SURVEY

LOCATED IN  
EAST 1/2 of Sec. 10, T 36S, R 1E, W.M.  
JACKSON COUNTY, OREGON

FOR  
**GORDON STANLEY**

HOFFBUHR SURVEYING, INC. MEDFORD, OREGON

SCALE: 1"=100' NOV. 20, 1978

BASIS OF BEARING R/S No. 6247

● = FOUND 5/8" IRON PIN

○ = SET 5/8" IRON PIN

✱ = FOUND HIGHWAY R/W PIN

(75-099)

REGISTERED  
PROFESSIONAL  
LAND SURVEYOR

*Richard R. Bath*

PAID 20 1978  
RICHARD L BATH  
No. 1099



BOUNDARY AGREEMENT LINE  
JACKSON COUNTY INST. NO. 78-17553

IRRIGATION

DITCH

30' EASEMENT FOR  
INGRESS AND EGRESS

1/4 SECTION CORNER  
FD BRASS DISC WITH B.T.'S

15.53 Ac.

17.96 Ac.

17.39 Ac.

LAKE

OF  
THE  
WOODS

HIGHWAY

NO.

140



10 SCALE

S10(T.L. 1600) 36S 1E

SURVEY NO. 7496

SURVEY NARRATIVE TO COMPLY WITH PARAGRAPH 209.250  
OREGON REVISED STATUTES

SURVEY FOR: Gordon Stanley  
11185 Highway No. 140  
Eagle Point, Oregon 97524

LOCATION: East one-half (1/2) of Section 10, Township 36  
South, Range 1 East, Willamette Meridian,  
Jackson County, Oregon

PURPOSE: To survey, monument, and describe the tracts as  
shown on the attached map as per client's request

PROCEDURE: Using control established by Recorded Survey No.  
6247 and State Highway right of way monuments, set 5/8 inch by  
24 inch iron pins at property corners as requested by the client,  
and along a Boundary Agreement Line as indicated by the client  
and the adjoining property owner.

November 14, 1978

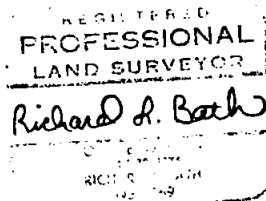

Richard L. Bath  
Hoffbuhr Surveying, Inc.