

7411

Survey Narrative

Survey of the North - South centerline of Section 4, Township 39 South, Range 2
West of the Willamette Meridian, Jackson County, Oregon

Survey for: Sheila F. Jenkins
6789 Sterling Creek Rd.
Jacksonville, Ore. 97530

Survey by: Robert Mason
415 Surrey Dr.
Grants Pass, Ore. 97526

Purpose of Survey: To locate and monument the west line of the Jenkins parcel.

Procedure: Beginning at the North Quarter corner of Sec. 4, I ran Southerly on a random line to the South Quarter corner of Sec. 4. I then made solar observations at each end of the line to determine true bearing.

I then established the location of the two monuments set on the west line of the Jenkins parcel. The most southerly, a 3/4 inch iron pipe, is set at 1320 feet south of the North Quarter corner. It is not intended to be either a property corner or the NC 1/16th corner.

Survey executed with a K & E Transit and a 200 foot steel tape.

Survey completed August 28, 1978.

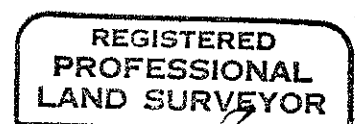
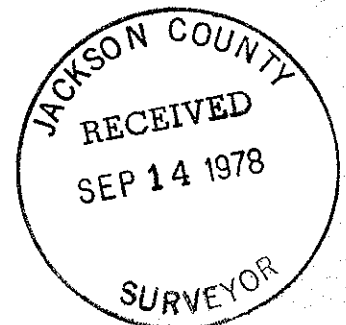

Robert Mason

